



Portfolio Schools Re-Theming Update (Roosevelt High School)

Special Administrative Board Presentation

May 4, 2017



AGENDA

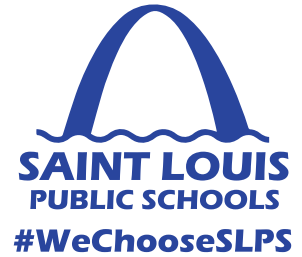

Goal: To increase academic achievement and move all schools toward adequate enrollment and building utilization.

1. Re-theming Process
2. Recommendations
3. **Next Steps**

PROCESS TO DATE

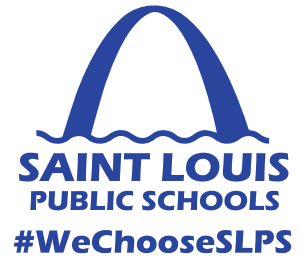

August - September 2016: All relevant data gathered.

September 2016: Principal meeting, ELT meeting, SAB presentation of proposed engagement and timeline.

October - November 2016: Community/District meetings to address low utilization. Recommendations presented to Dr. Adams.

November 2016: District submits recommendations to the SAB.

December 2016: Final Board approval.

January 2017- February 2017: Advisory Boards/ Small Community Meetings held at each school to further develop the themes and ensure smooth transitions.

March 2017: District submits updates to the SAB.

April 2017- August 2017: Implementation of the transformations and consolidations.

RE-THEMING PROCESS

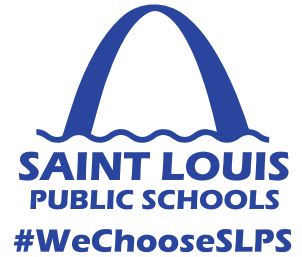

January – February: Advisory boards held per school, 2-4 meetings per site.

Wide stakeholder representation:

- Parents
- Community Members
- Teachers
- Staff
- School Leaders
- District Employees
- Community Partners
- Alumni

RECOMMENDATION - HIGH SCHOOLS

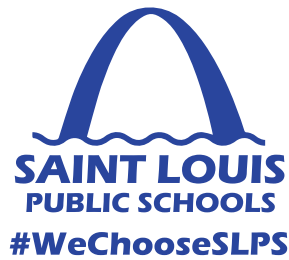

SCHOOL	THEME	PROPOSED KEY ELEMENTS
ROOSEVELT SENIOR HIGH	GLOBAL COMMUNITY	<ul style="list-style-type: none">• Proposed relocation of NCNAA High School program (9th and 10th grades) to Roosevelt, as one of the potential sites being considered• Expand foreign language offerings and add global curricular focus• Expanded summer programs and partnerships• Vertical planning with feeder middle schools• Deepening community connections• Anti-bias, anti-racism training for staff

ELLs NEW TO THE DISTRICT: 2016-2017

Aug-16	Sep-16	Oct-16	Nov-16	Dec-16	Jan-17	Feb-17	Mar-17	Apr-17	TOTAL
92	145	74	38	22	46	51	36	18	522

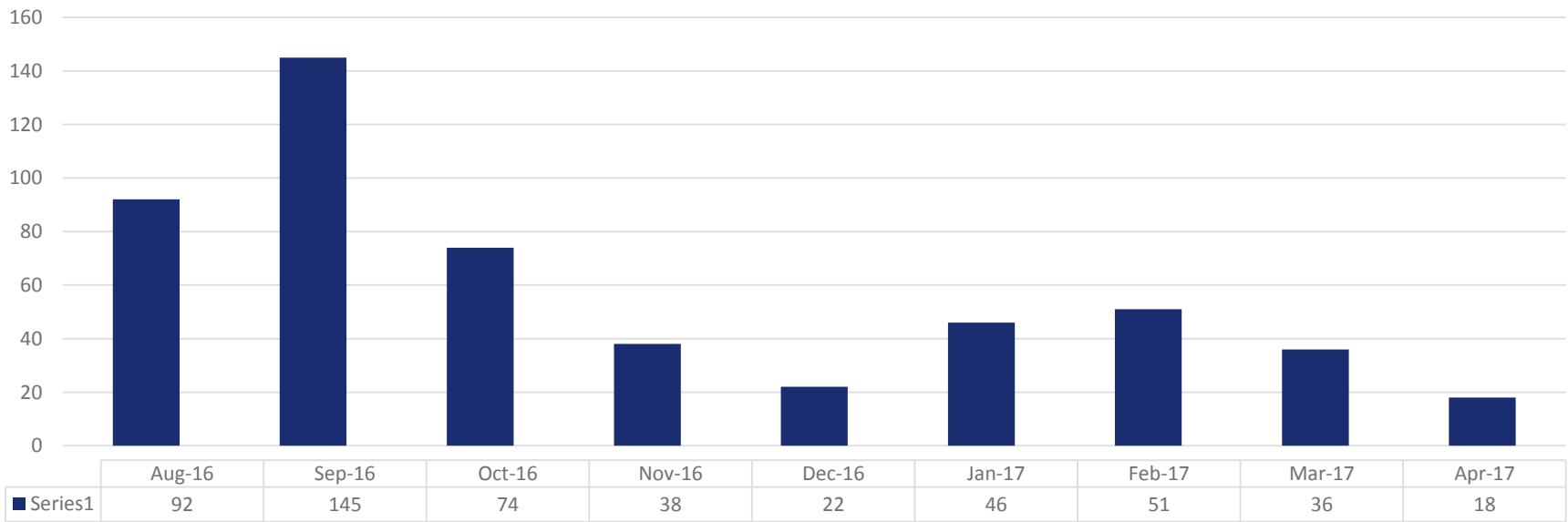

ELLs NEW TO THE DISTRICT COMPARISON: 2015-2016 and 2016-2017



2015-2016				
Jan-16	Feb-16	Mar-16	Apr-16	TOTAL
51	35	22	41	149

2016-2017				
Jan-17	Feb-17	Mar-17	Apr-17	TOTAL
46	51	36	18	151

JANUARY-APRIL ENROLLMENT

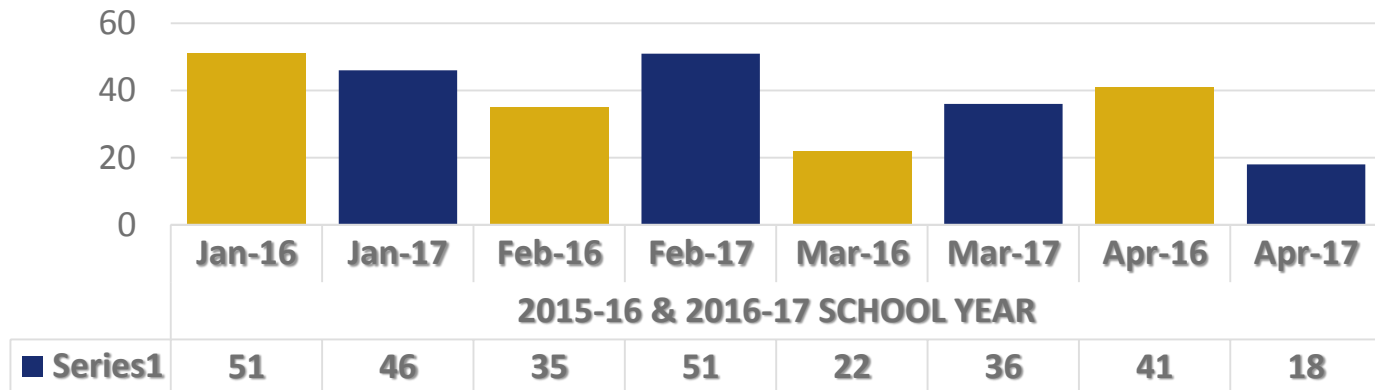

ELL NEW STUDENT ENROLLMENT BY WEEK: JAN. – APR. 2016-2017

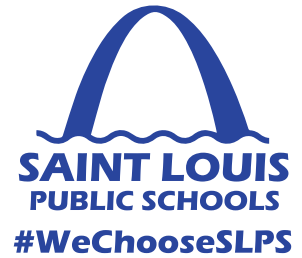

	JANUARY	FEBRUARY	MARCH	APRIL
WEEK 1	7	15	10	2
WEEK 2	9	12	11	5
WEEK 3	22	7	1	4
WEEK 4	8	17	2	7
WEEK 5			12	
TOTAL	46	51	36	18

CURRENT ENROLLMENT

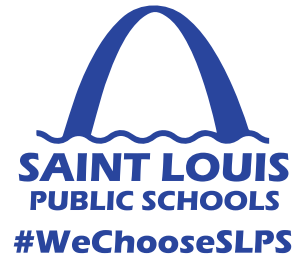

GRADE	# STUDENTS
K	53
1	37
2	46
3	44
TOTAL	180

GRADE	# STUDENTS
4	63
5	49
6	48
7	42
8	41
TOTAL	243

GRADE	# STUDENTS
9	132
10	16
TOTAL	148

KOTTMAYER UTILIZATION PLAN

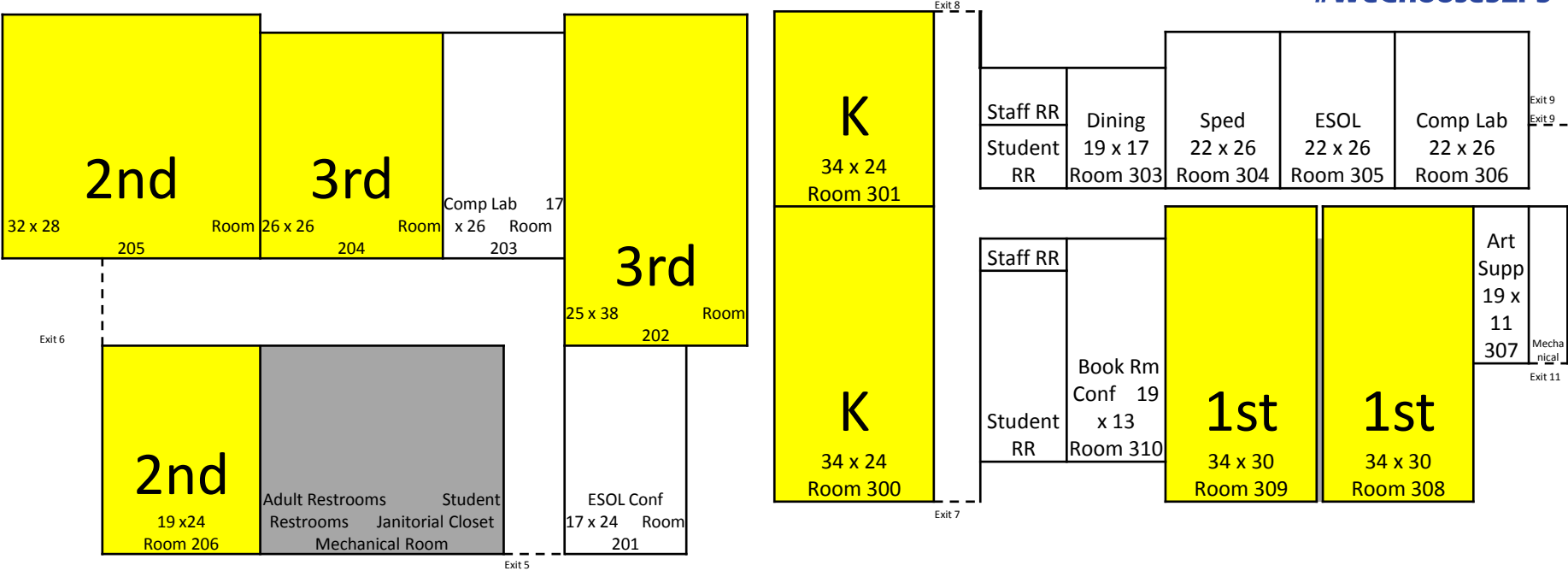

Building 2

Building 3

Housing 130 Students

KOTTMAYER UTILIZATION PLAN

Building 4

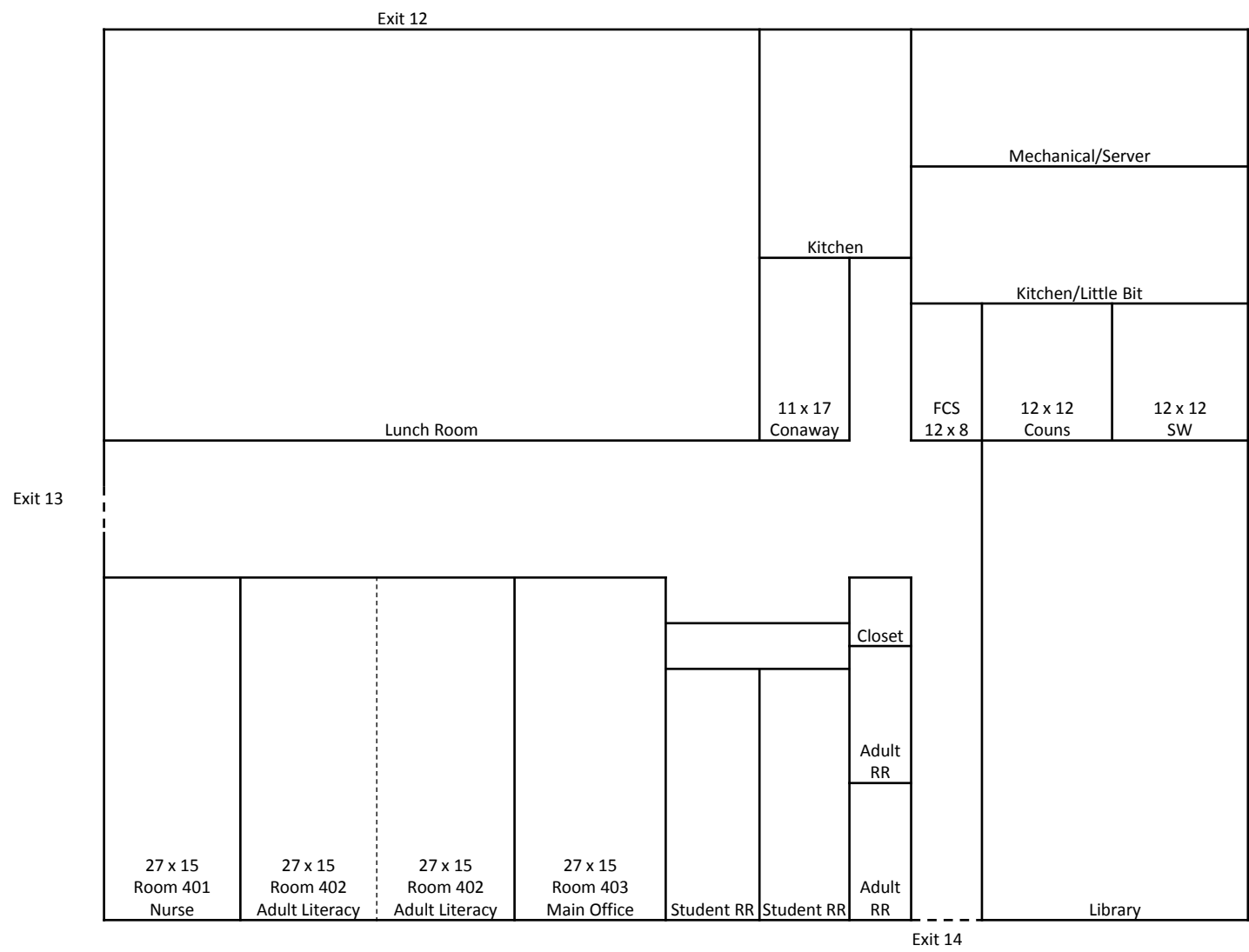

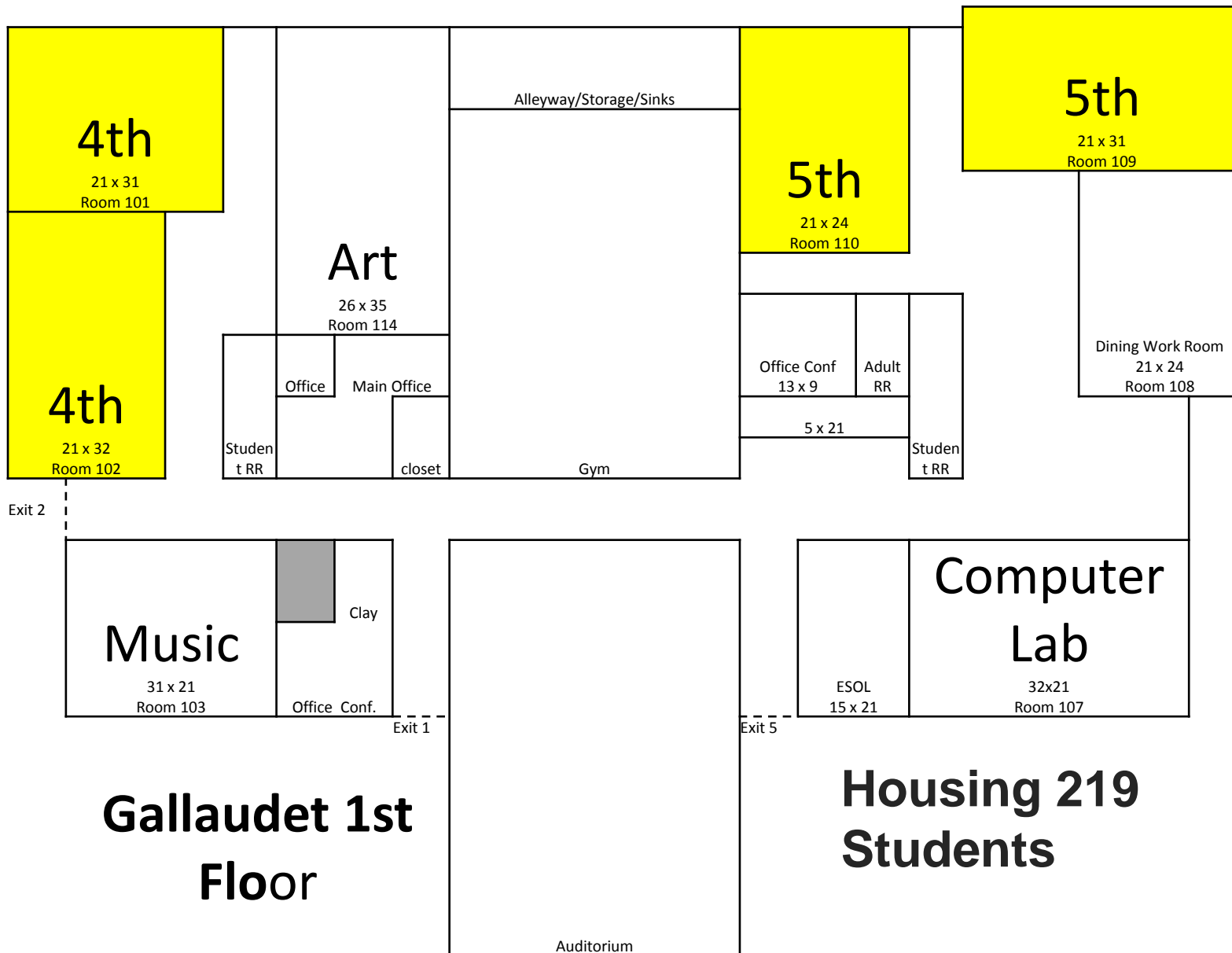

**Gallaudet 1st
Floor**

**Housing 219
Students**

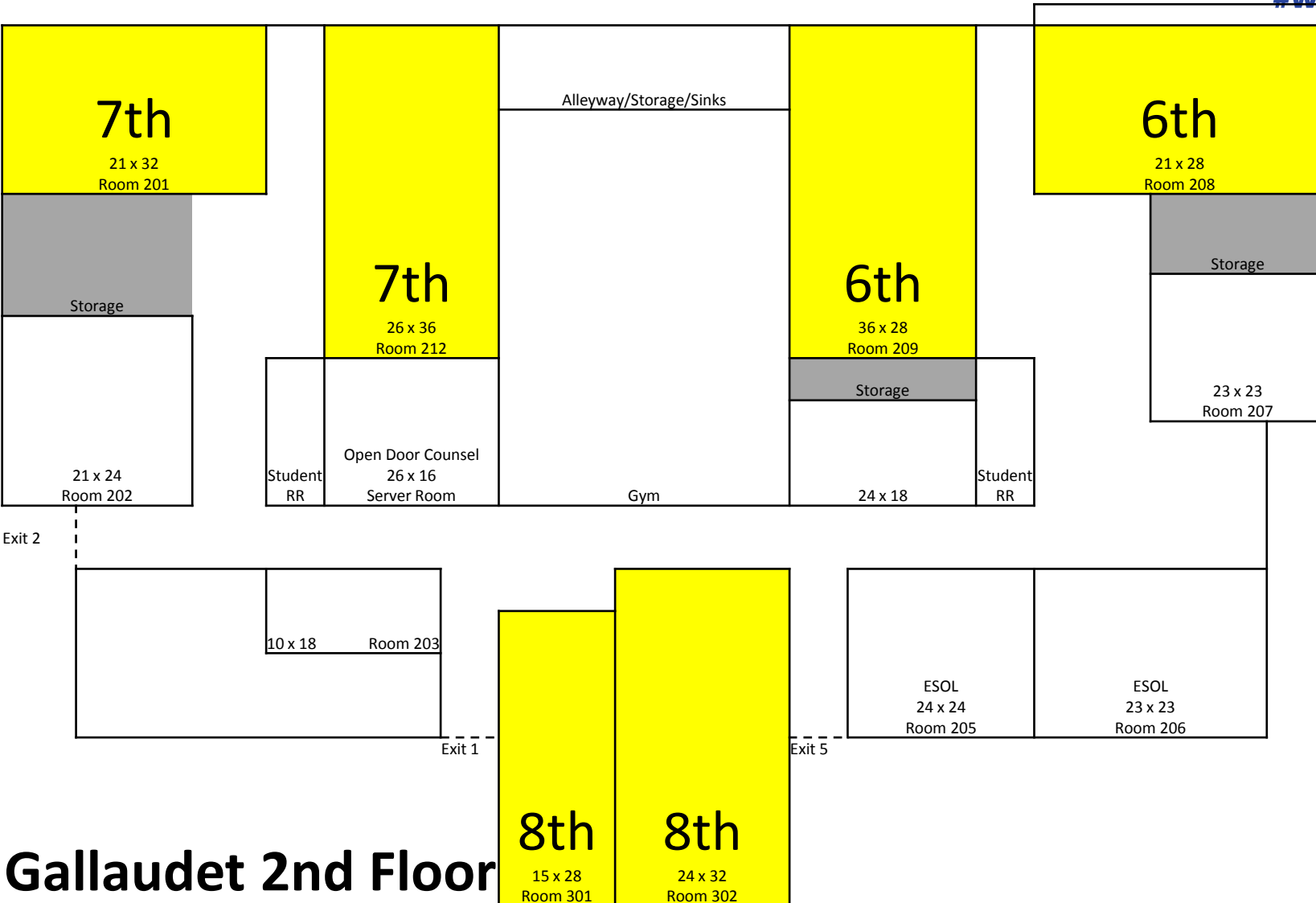

RATIONALE FOR GATEWAY STEM for the 9TH - 10TH NEWCOMER PROGRAM

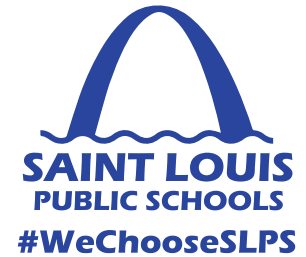

	ROOSEVELT	SOLDAN	GATEWAY STEM
Space availability	X Lower level/basement	X	X 3 rd floor
Current # of ELL students	57 RCV/73LEP	89RCV/110LEP	202RCV/332 LEP
School Access for ELL Parents	Good	Poor	Good
School Proximity to ELL Office	1.8 miles	4.7 miles	2.0 miles
Access to Sports	some	all	all
Staff Preparedness for Integration Experiences	some	none	some

GATEWAY STEM UTILIZATION PLAN



Room 312

Room 313

Room 314 (Major ceiling issue)

Room 315

Room 316 (Lecture Hall too small)

Room 106 (Major Repairs Needed)

Room 118 (Major Repairs Needed)

Room 119 (Major Repairs Needed)

Additional rooms for 9-10 Newcomer Program would be available if rooms on 1st and 4th floor are repaired for Gateway STEM students and staff.

ROOSEVELT UTILIZATION PLAN

Room 016

Room 017

Room 018

Room 019

Room 020

Room 021

Room 022

Room 027



OPTIONS FOR RELOCATION OF 9TH and 10TH GRADES:

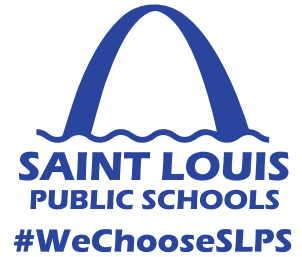

1. Remain at the NAPA site for the 2017- 2018 school session
2. Move to Roosevelt *
3. Make the major repairs needed for the Gateway STEM site and move for the 2018-2019 school session

QUESTIONS