

How to Factory Reset your Windows 11 Device

Step 1: Search for settings (grey gear icon)

Step 2: Go to system on the left

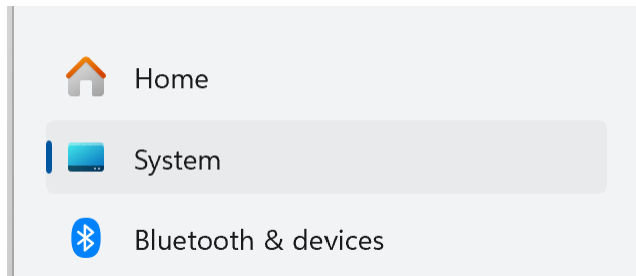

Step 3: Select Recovery at the bottom.

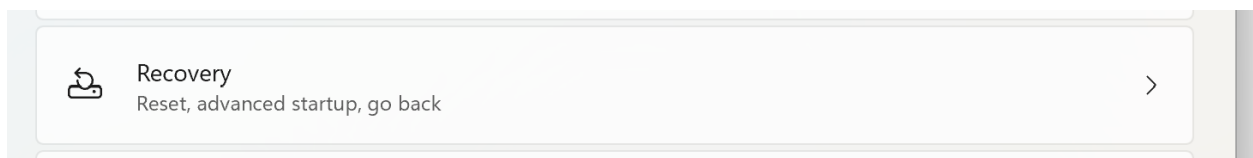

Step 4: Click on Reset PC

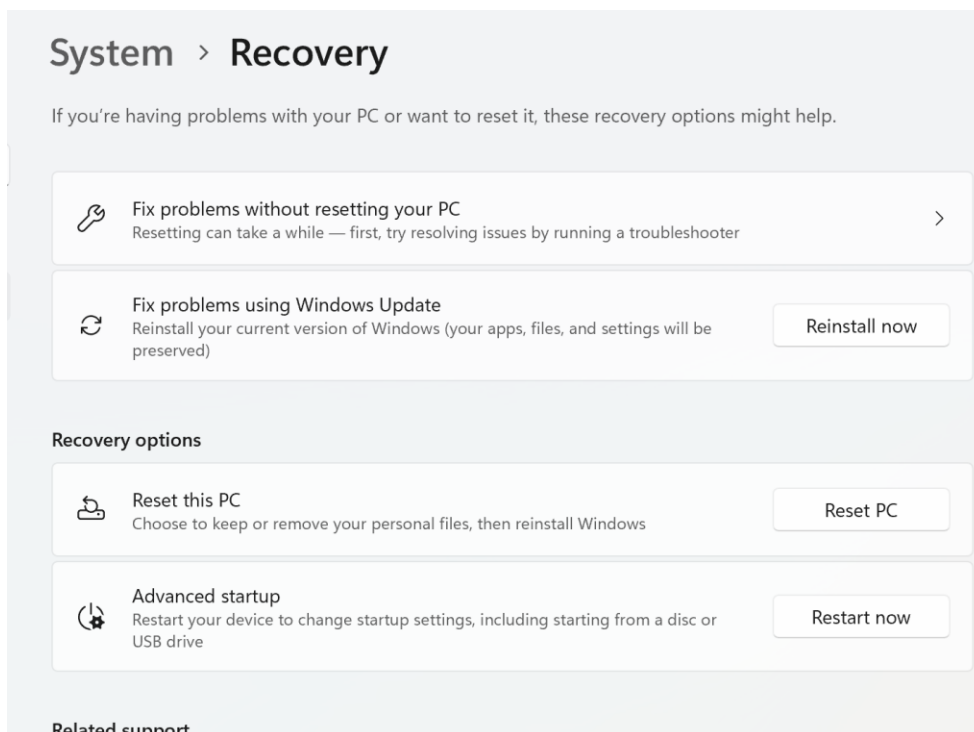

Step 5: Select Remove everything

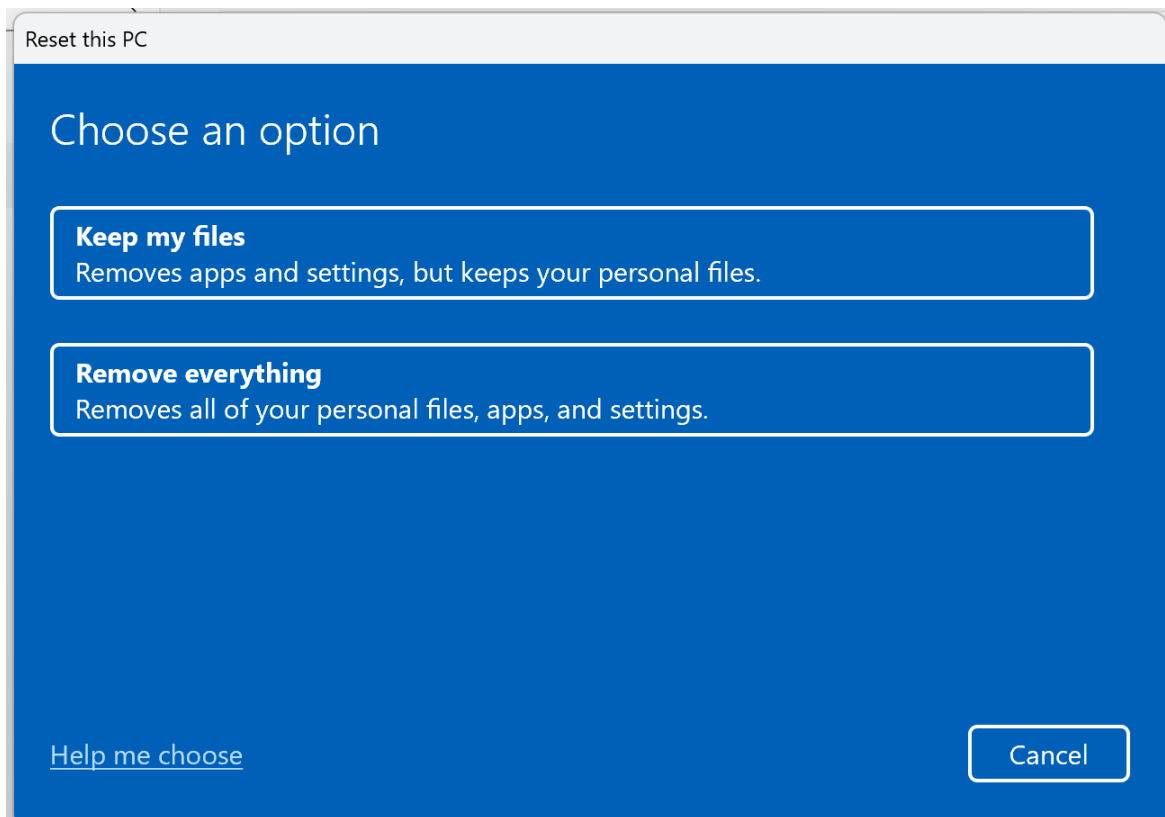

Step 6: Select Cloud or Local Reinstall. Local reinstall is fine.

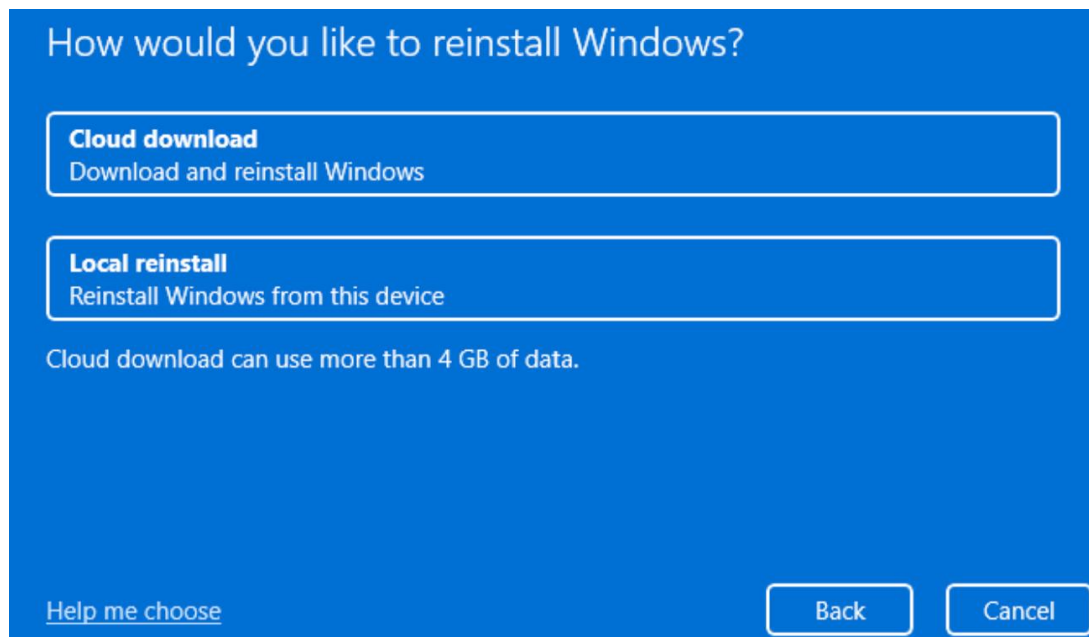

Step 7: Make sure its plugged into power and follow the prompts.