

Project: Replace Playground Equipment

Project # 127-15/16

Location: Day care playground at Pacific Avenue Education Center (PAEC)

440 West Lomita Ave, Glendale, CA 91204

Scope of Work

8-10-16

1. Isolate area utilizing temporary fencing provided to the site by GUSD. Contractor will erect and take down the fence. GUSD will remove the fence from the site it at the end of the project.
2. Dismantle and Haul Away all old playground equipment, concrete footings and approximate 1,050 sf of old tiles.
3. Scarify existing asphalt to prepare base for installation of approximate 1135 sf on 3.25" thick sofSURFACES tiles over existing AC paving.
4. Saw cut 36" x 128' (plus ramp area) around the entire perimeter (see attached drawing) and pour 3000 psi mix concrete keyway to accommodate rubber beveled edging and wheelchair ramp supplied by GUSD, see attached detail sheet.
5. Install new Little Tykes playground equipment supplied by GUSD per bid docs. Contractor must be Little Tykes certified installer.
6. Install approximate 1135 square feet of sofSURFACES tiles provided by GUSD contractor must be certified by sofSURFACES.
7. Complete an inspection to meet all playground equipment manufactures requirements for installation.
8. Power clean and seal areas to be sealed and prepare site for audit inspection.

Drawings 1-5

1. Drawing labeled "1 PAEC" Project #LP853_42402586843_1, Drawn 2016-02-03
2. Drawing labeled "2 PAEC" Project #LP853_42402583843_1, Drawn 2016-02-03
3. Drawing labeled "3 PAEC" Project #LP853_42468579560_1, Drawn 2016-04-12
4. Drawing labeled "4 PAEC" Tile layout – Area N^o 1- Glendale USD
5. Drawing Labeled "5 PAEC" Buried Curb Retainer # 2017-027 Dated 7-14-16

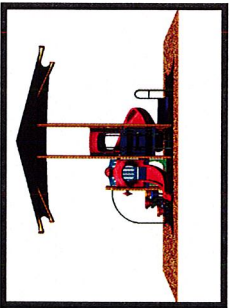
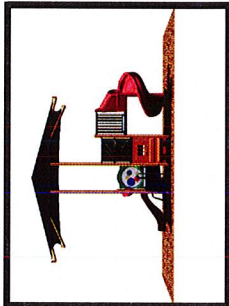
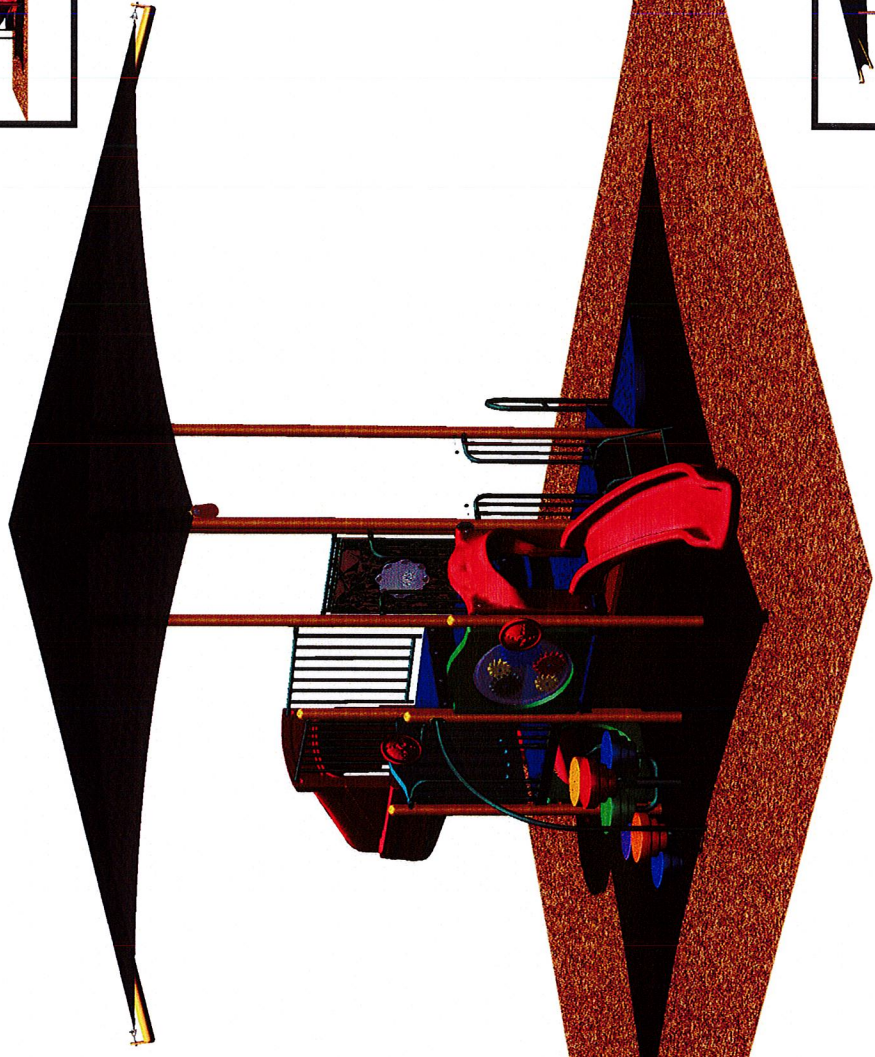
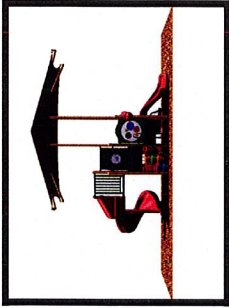
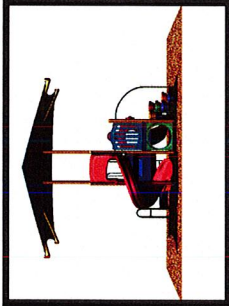

Project:
**Pacific Ave
 Learning Center**
 Project No.
 LP853_42402583843_1
 Drawn: 2016-02-03
 Presented By:



ENGINEERING INTENT
 Scott Muscolo
 Pacific Park and Playground, Inc
 805-581-0252



This play equipment complies with the safety performance specifications of ASTM for children 2-5 years old. Not all equipment may be appropriate for all children. Supervision is required.



1 PAEC



PlayPower L.T. Farmington, Inc.
 800-325-8828 www.lfpps.com



Representative:
 Scott Muscolo
 Pacific Park and Playground, Inc.
 805-581-0252

Project:
 Pacific Ave
 Learning Center

Project No.
 LP853_42402583843_1
 Drawn: 2016-08-10
 Drawn By: Scott Muscolo

PlayArea1
 Product Line: PlayBuilders
 Age Group: 2-5
 Post Type: Galv. 11ga. / Plastic
 Play Builder Accent Color: Green
 Play Builder Post Color: Tropical Yellow
 PB Panel/Crawl Tunnel Color: Train Green
 PB Roof/Table Color: Forest Green
 PB Slide Color: Sport Red
 PB Vinyl Clr: Blue
 Use Shade Fabric: Standard Fabric Color: Green
 PPE: 100% Recycled Yellow/Red/Yellow
 PB Village Panel Color: Yellow
 StoneCmb Stone 1 Clr: Blue
 StoneCmb Stone 2 Clr: Sport Red
 StoneCmb Stone 3 Clr: Tropical Yellow
 StoneCmb Stone 4 Clr: Train Green
 StoneCmb Stone 5 Clr: Orange
 StoneCmb Stone 6 Clr: Grape (Purple)
 StoneCmb Stone 7 Clr: Blue
 Mount Option: Burned

Playground Layout
 Compliance:

- ✓ Final Access Board Regulations
- ✓ CPSC Handbook for Public Safety
- ✓ ASTM F1487

This play equipment complies with the safety performance specifications of ASTM for children 2-5 years old. Not all equipment may be appropriate for all children. Supervision is required.

2 PAEC

PlayPower LT Farmington, Inc.
 P.O. Box 887
 Farmington, Missouri 63640
 Phone: 636-235-8828
 Fax: 636-235-8319
 www.litps.com

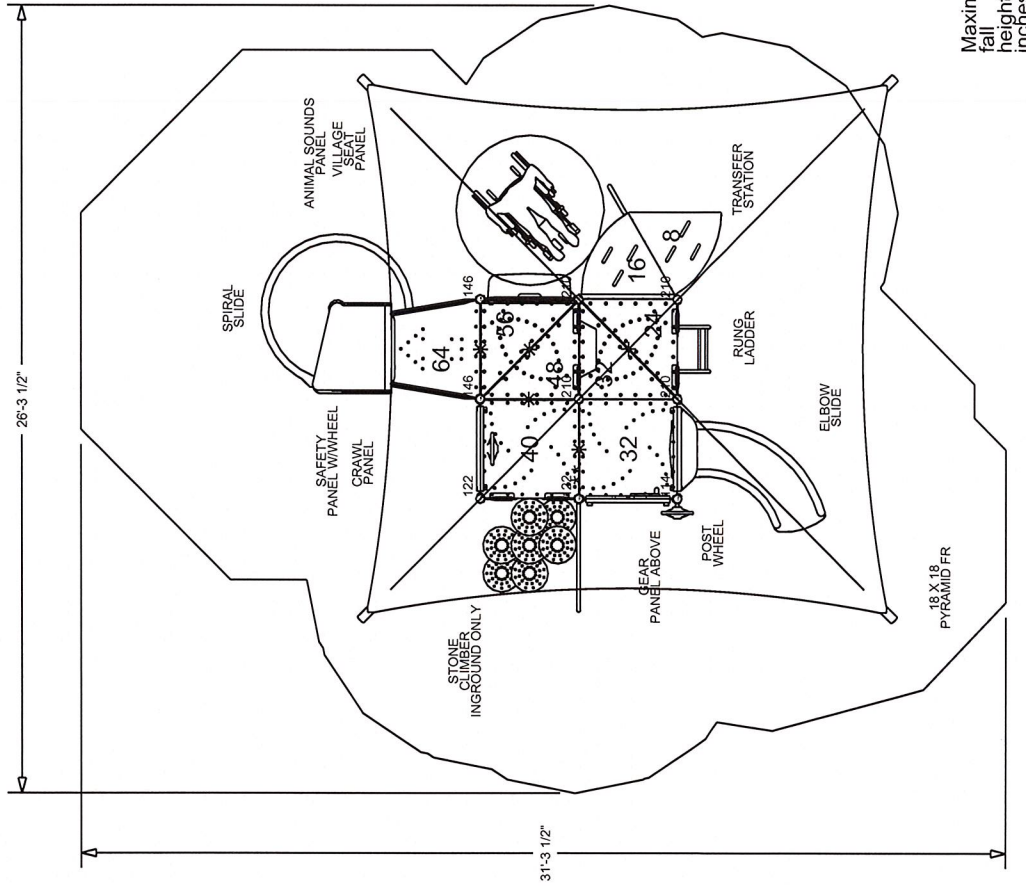

Maximum fall height 64 inches

Minimum recommended allzone Area:
 605 sq. feet
 Perimeter: 96 feet

NOTES

1. The 2010 American with Disabilities Act (ADA) along with Architectural Barriers Act (ABA) Accessibility Guidelines requires you by law to make your park/play area accessible when viewed in its entirety. Please consult the Accessible Guidelines.
 2. Equipment to be considered accessible an accessible route must be available with in the play area to all identified accessible components per ADA and ABA.
 3. When adding to an existing play area, it is important to consider ground level requirements to including accessible routes.
 4. All deck heights are measured from the top of the finished protective surfacing material.
 5. Fall absorbing protective surfacing material is required under and around all play area components.
 6. The minimum recommended use/fall zone around each play structure and/or independent play equipment is outlined on the layout drawing.
 7. Age appropriate label locations are marked with a double asterisk (**).
 8. The requirement for a Play Builder installation is that the post can not be set prior to installing the decks.
 9. All post lengths are identified by text showing the post lengths, is 2210 or 87' represents a 22' high or 87' high post. Scale for reference only. Use dimensions as shown.
 10. Elevated Play Activities Total:
 - Accessible By Transfer: 6 (3 req)
 - Accessible By Ramp: 0 (0 req)
 - Ground Level Activity Type: 3 (2 req)
 - Ground Level Activity Quantity: 4 (2 req)
- Scale for reference only. Use dimensions as shown.



Playgrounds Fun & Easy!

Representative:
Scott Muscolo
Pacific Park & Playground
714-846-4885

Project:
Glendale USD -
Pacific Ave Learn

Project No.
LP853_42468579560_1
Drawn: 2016-04-12
Drawn By: Scott Muscolo

Footings Drawing Legend:
Numbers in center of symbols
denote post length (inches).
Playground equipment:
Post footing for posts with caps.

Post footing for posts without caps.

Play event footing.

For surface mounted equipment:
Post footing for posts with caps.

Post footing for posts without caps.

Play event footing.

3 PAEC

PlayPower LT Farmington, Inc.
P.O. Box 887
F.O. Missouri 63640
Phone: 1-800-325-8828
Fax: 573-756-0319
www.ltcps.com

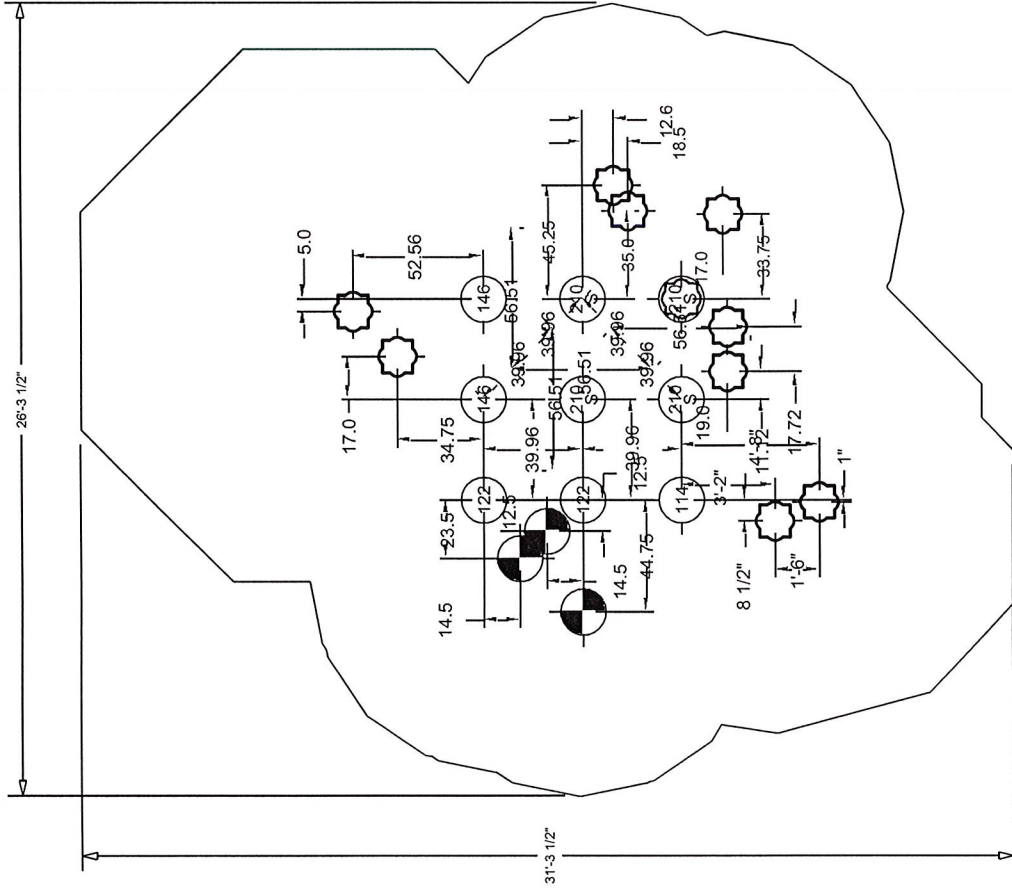

Minimum recommended fallzone
Area: 897 sq. feet
Perimeter: 120 feet

NOTES

Scale: 1/4"=1'

• See for reference only. Use dimensions as shown.

Tile Layout - Area N° 1 - Glendale USD, Pacific Ave. Learning Center

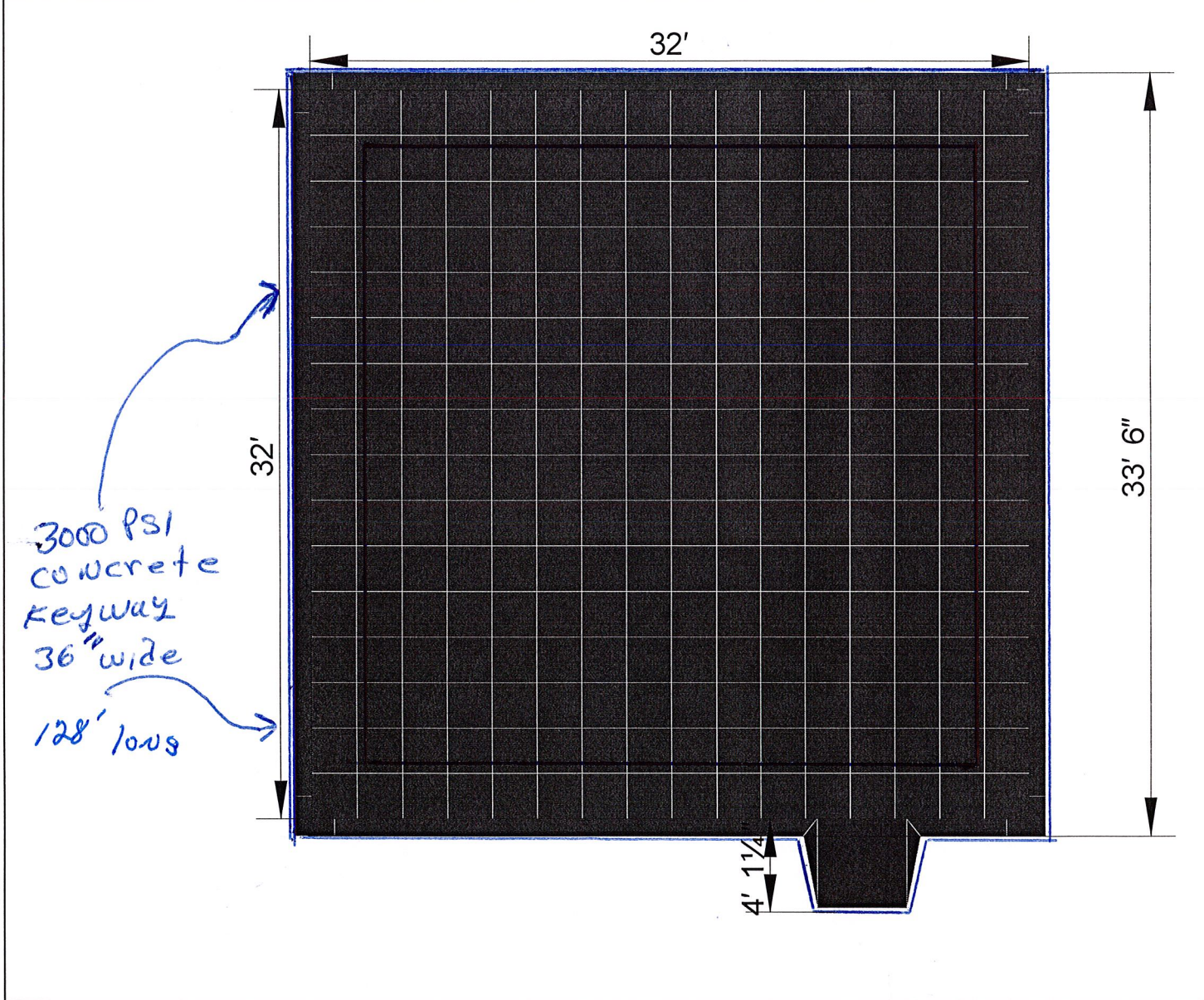

Quote Q90411-5-TP - Glendale USD, Pacific Ave. Learning Center NJPA 2/11/2016 3:22 PM Prepared by: Linda Stevens

4 PAEC



Buried Curb Retainer

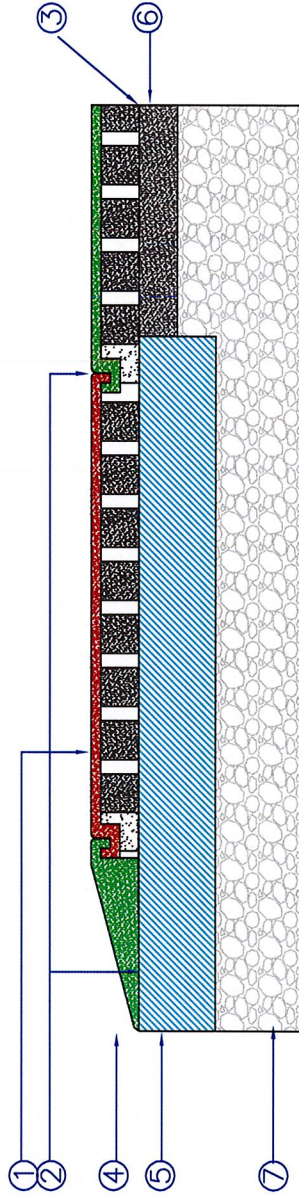

LEGEND:

- ① SofTILE® (See Specifications for Depth and Color).
- ② 1/2" Diameter Continuous Bead of SofTILE Adhesive at Each KrosLOCK Joint, full width under ramp and 24" of perimeter tile to base.
- ③ 1.0% Slope - 1/8" / 12" (3mm / 300mm).
- ④ SofRAMP Jr. Adhered down to Containing Curb as well as to the Adjacent SofTILE.
- ⑤ Concrete Under Ramp and 24" Minimum Under Tiles - ramp dimension determines width (see SofRAMP Detail)
- ⑥ Asphalt SubSurface
- ⑦ Compacted Granular A (Type I) Base To 95% S.P.D. (See Specifications for Depth).

NOTES:

- 1. Consult with a local Civil Engineer to find out what drainage system is best for your application.
- 2. Review Most Recent Installation Manual and Sub Surface Guide
- 3. Using a Concrete Saw Cut out a 3" Ribbon of Asphalt Around the Outside Perimeter. Compact the Aggregate Base Below then Pour the Concrete Base in the Voided Area. Let the Concrete Cure for 10 days Prior to Adhering the SofRAMPS/ADA's or duraSAFE tiles.

SofTILE Thickness	Critical Fall Height (FT)
2.00"	3'
2.25"	4'
2.75"	5'
3.25"	6'
3.75"	7'
4.25"	8'
4.75"	9'
5.00"	10'
5.75"	12'

FILE NAME	DESCRIPTION	PREPARED BY	DATE
Buried Curb Retainer	ORIGINAL ISSUE	B. GOSS	7/14/16
REV			
0			
SIZE	SCALE	DWG NO.	REV
A	N/A	2017-027	1



4393 DISCOVERY LINE
 PETROLIA, ONTARIO
 NON IRO
 PHONE: (800) 263-2363
 PHONE: (519) 882-8799
 FAX: (519) 882-2697
 EMAIL: info@sofsurfaces.com

5PAEC