

**ADDENDUM NO. 1**  
**RFP NO. 258-23/24 - COMMERCIAL KITCHEN EQUIPMENT**

1. Bid requested pricing to be firm for 1 year. When is the commencement date?

**Response:** Our goal is to take the awardees for Board approval on 10/10/23. So commencement date would follow shortly after once the contract(s) are signed.

2. Does prevailing wage install required to comply with DIR requirement?

**Response:** Yes

3. Is the district taking care of unhooking all utility connections for existing equipment?

**Response:** Please include cost for unhooking utility connections. We would like the option for vendor to unhook utility connections.

4. Item#62 - Model requested #H137-SUA-12DSD is a transport cabinet. Model #H137-SUA-12D is a standard unit for used in the kitchen. Pls confirm which model is required.

**Response:** We would like the standard unit for kitchen use Model #H137-SUA-12D.

5. Item#63 - Do the following options required to be included on the pricing :  
LONG.LIFE4 extended warranty, install kit, water filter, 20ea s/s grids,  
detergent & rinse chemicals and startup kit

**Response:** Yes, please include options.

6. Item #67 - Model XAVL-2021, do you need right hand control (add -DPRS to model) or left hand control (add -DPLS to model)?

**Response:** We will add UNOX Model XAVL-2021-DPRS for right hand control.

7. Item #77 - Model requested #15-0051MOD is invalid. The closest match is model #150-0051MOD.

**Response:** 150051-MOD is the correct model, see spec sheet attached. It's a modified 63.75 in. height non-insulated transport cabinet with vertical bail handles instead of

horizontal.

8. **Piggyback Clause** - I liked to take exception on the delivery, installation and haul away of equipment. We can only allowed piggyback on equipment price. Will that disqualify me from this bid?

- i. Piggybacking by Other Public Agencies. By submitting a bid, the contractor shall be deemed and construed to have acknowledged and agreed that, to the extent permitted by Public Contract Code Sections 20118 and 20652, and during the period in which the Agreement is in effect (including, without limitation, any extensions thereof), the contractor shall allow other California public school districts and California community college districts to procure serving lines and services for delivery, installation, and haul away specified in the Agreement on the same terms and conditions as set forth in the Agreement. The District hereby authorizes the purchase of the serving lines directly from the contractor by the other school districts and community college districts, and to make payment directly to the contractor under the same terms and conditions that are applicable to the District under the Agreement.

**Response:** We agree to equipment price only on the piggyback. Any vendor taking exception and only allowing piggybacking on equipment price will not be disqualified from this bid. Both vendor and respective District(s) interested in piggybacking must negotiate delivery, installation, and etc. and agree to the terms that are satisfactory to all parties.

9. Are you wanting “set in place” or “install” ? Some areas on the bid show set in place and in other places it shows install.

**Response:** We are requesting set-in-place for items #1 to #86 (refrigeration, heating, large equipment, and mechanical large equipment). We would like the option for vendor to disconnect utilities, install, and connect utilities as necessary per equipment.

10. Request to extend Bid Due Date.

**Response:** Bid Due Date Extended from September 8, 2023 to September 22, 2023 at 12 noon.

**ADDENDUM NO. 1 - RFP NO. 258  
QUESTION 7 - RESPONSE ATTACHMENT**

**150051**

REV. 1 (6/05)

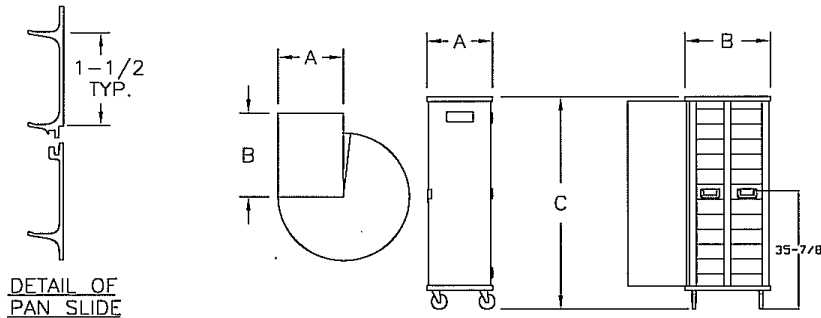

CRES-COR MODEL NO.	PAN			DIM A	DIM B	DIM C	INSIDE DIMENSIONS			WEIGHT ACT.	
	CAP	SIZE		WIDTH	DEPTH	HEIGHT	WIDTH	DEPTH	HEIGHT		
150051	36	18 X 26	IN	21	27-1/2	63-3/4	18-1/16	26	55-1/2	LBS	110
		457 X 660	MM	533	699	1619	459	660	1410	KG	50

ALL ALUMINUM CONSTRUCTION IS RIVETED, WELDED AND FINISHED

**CABINET:**

- Posts: Extruded aluminum channels, 7/8 x 2-1/4 x .102; welded to top and base, form a solid frame.
- Sides: Interlocking extruded 6" panels, smooth outer sides reinforced with 1 x 2 x .125 extruded channel; riveted and welded in place.
- Super Duty back panel: Fitted into posts, riveted to top and reinforced with additional bracing.
- Tie rods (2): One applied at front, one at back.
- Top: One piece .100 aluminum, reinforced corners.
- Bail Handles: 3/8" dia. black anodized aluminum rod; riveted and welded (2) each side.

**BASE:**

- One piece construction, .190 aluminum.
- Casters: 6" dia., swivel, polyurethane, 2" wide, load cap. 900 lbs. each, temp. range: -30°/+180°F. Zerk fittings in hub; suitable for cart wash. Front casters equipped with brakes.

**PAN SLIDES:**

- Extruded interlocking side walls act as pan slides on 1-1/2" centers.

**DOOR:**

- Panel: Formed .063 aluminum.
- Reinforcements: 3/8 x 1-1/2 extruded bars riveted and welded horizontally to top, center and bottom.
- Latch: Gravity type, nickel plated steel.
- Swings 270° on 3 heavy duty butt hinges, riveted to posts and door.
- 6" x 6" Lexan card holder riveted to front.

**SHORT FORM SPECIFICATIONS**

Cres-Cor Super Duty Cabinet Model 150051. Formed and welded aluminum top, .190 aluminum base. Interlocking extruded aluminum sidewalls for (36) 18" x 36" pans and plastic food boxes on 1-1/2" centers. Formed .063 door. Two additional extruded bars riveted and welded to back. 6" dia. swivel polyurethane casters; zerk fittings in hub; load cap. 900 lbs. each, temp. range -30°F to +180°F. (2) bail handles riveted & welded to each side.



5925 Helsley Road • Mentor, OH 44060-1833  
Phone: 877/CRESCOR • FAX: 440/350-7267  
( 877/273-7267 )  
www.crescor.com

© Crescent Metal Products, Inc. 2003 All rights reserved.

*In line with its policy to continually improve its products, CRES-COR reserves the right to change materials and specifications without notice.*