

DIRECTORY

DISTRICT

GLENDALE UNIFIED SCHOOL DISTRICT
223 NORTH JACKSON STREET
GLENDALE, CALIFORNIA 91206
PHONE: (818) 241-3111

SCHOOL

VERDUGO WOODLANDS ELEMENTARY SCHOOL
1751 NORTH VERDUGO ROAD
GLENDALE, CALIFORNIA 91208

ARCHITECT

ARCHITECTURE 9
8816 FOOTHILL BOULEVARD #103-224
RANCHO CUCAMONGA, CALIFORNIA 91730
PHONE: (918) 800-9325
EMAIL: A9CONTACT@ARCHITECTURE9.COM

CIVIL

ADKAN ENGINEERS
6879 AIRPORT DRIVE
RIVERSIDE, CALIFORNIA 92504
PHONE: (951) 688-0241 FAX: (951) 688-0599

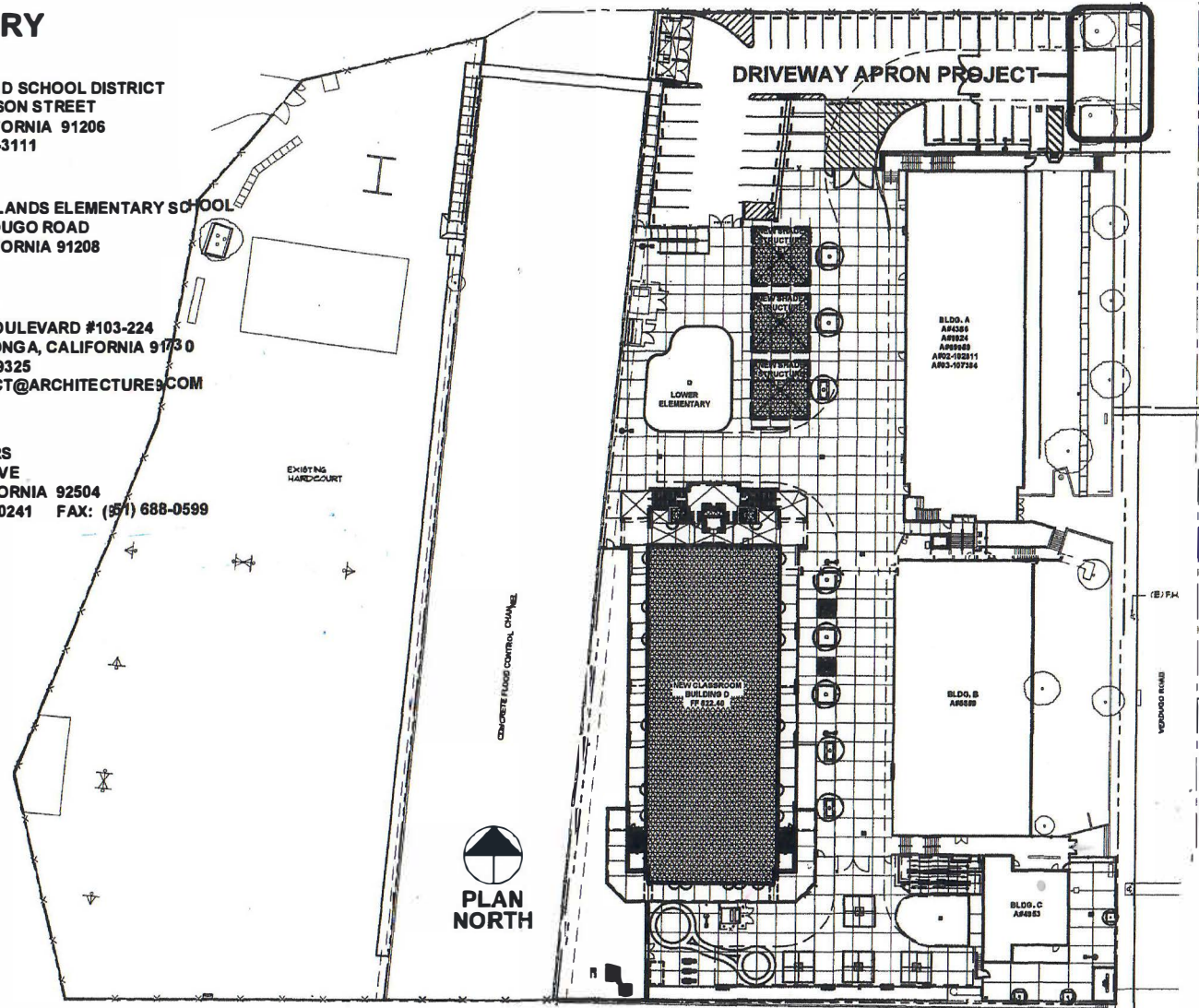

INDEX OF DRAWINGS

- 1 TITLE SHEET
- 2 PARTIAL SITE PLAN - EXISTING CONDITIONS
- 3 DEMOLITION PLAN
- 4 PARTIAL SITE PLAN
- 5 DETAILS
- 6 DETAILS

SCOPE OF WORK

REMOVE EXISTING DRIVEWAY APRON, SIDEWALL AND A PORTION OF THE FIRE LANE. INSTALL A LOWER DRIVEWAY APRON, SIDEWALK AND PORTION OF THE FIRE LANE. INSTALL NEW SLOPED WALKS ON EACH SIDE OF THE DRIVE APRON.

VICINITY MAP

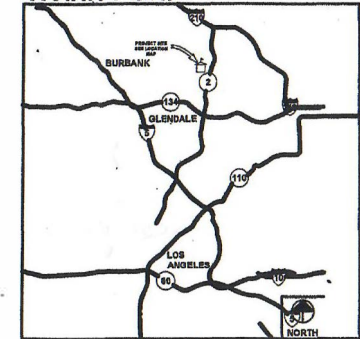

GLENDALE, CALIFORNIA
SCALE: N.T.S.

LOCATION MAP

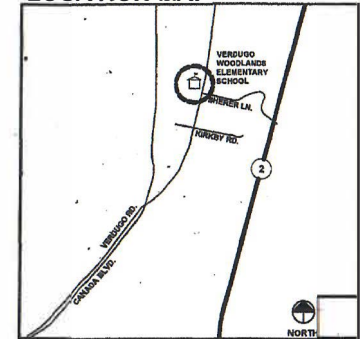

VERDUGO WOODLANDS ELEMENTARY SCHOOL.
SCALE: N.T.S.

DSA No.: N/A

Architecture PLLLP

9

GLENDALE UNIFIED SCHOOL DISTRICT

Verdugo Woodlands Elementary School

PROJECT NO.: 10.02.09

DATE: April 16, 2018

File No.: 19-41

DRAWING NO.

1



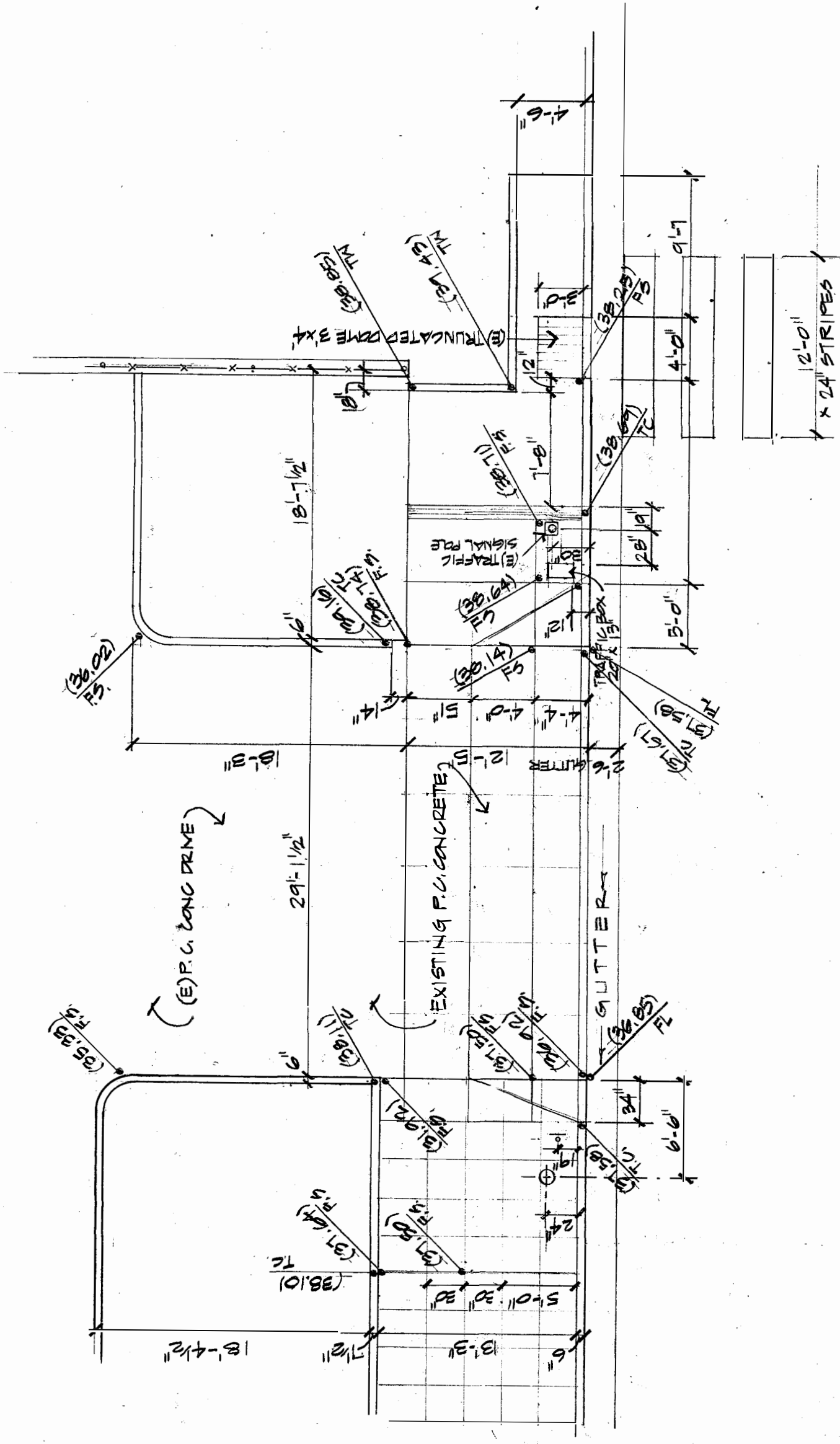

1 PARTIAL SITE PLAN EXISTING CONDITIONS

SCALE: 1/8" = 1'-0"

DSA Application No.: NA

File No.: NA

9 Architecture LLLP

Glendale Unified School District
VERDUGO WOODLANDS E.S.-DRIVE APRON
 Project No.: 10.02.09
 DATE: April 16, 2018

DRAWING NO.
2



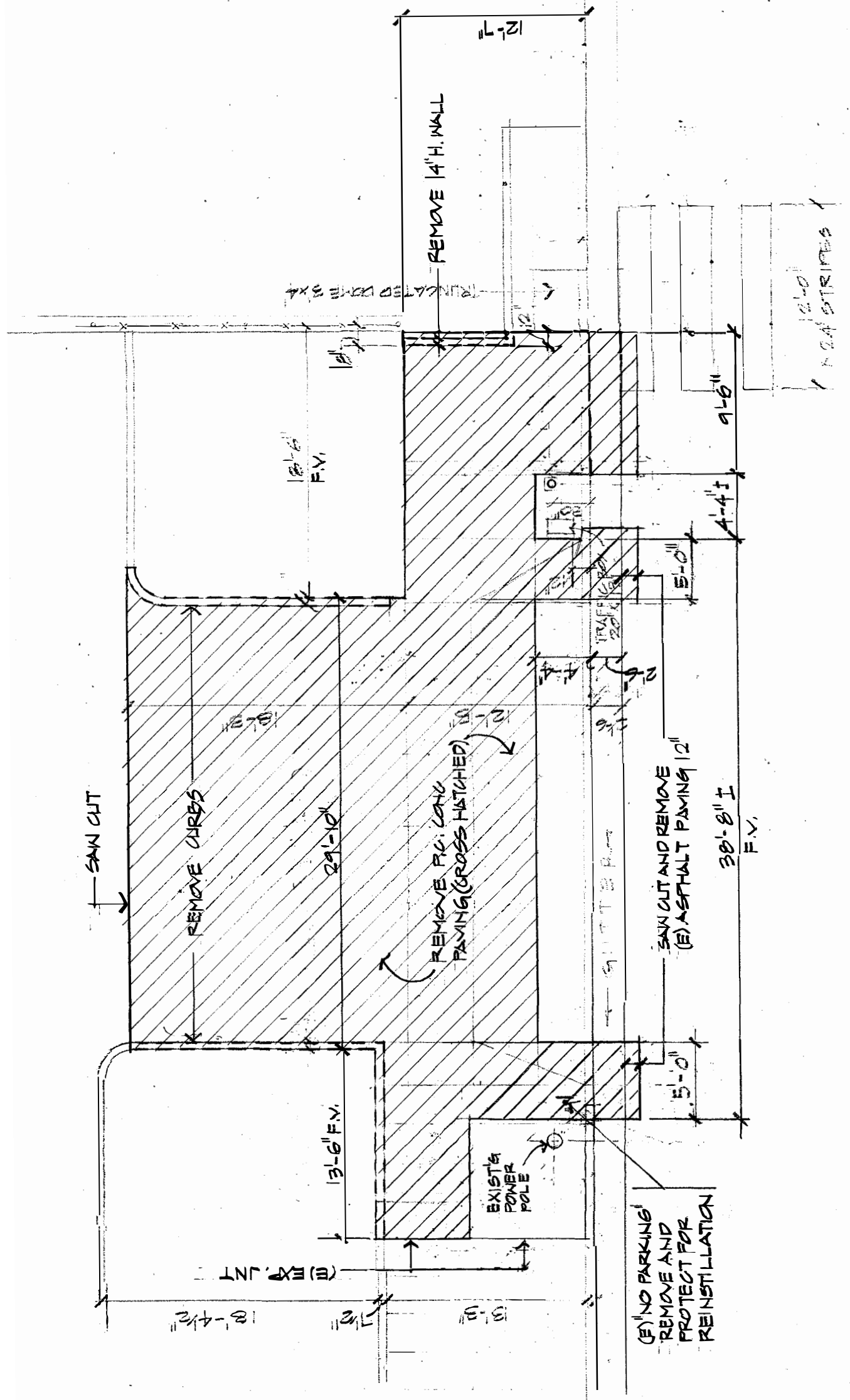

1 DEMOLITION PLAN
 SCALE 1/8" = 1'-0"

DSA Application No.: NA

File No.: NA

Architecture **9** LLLP
 Glendale Unified School District
VERDUGO WOODLANDS E.S.-DRIVE APRON
 Project No.: 10.02.09
 DATE: April 16, 2018

DRAWING NO.

3



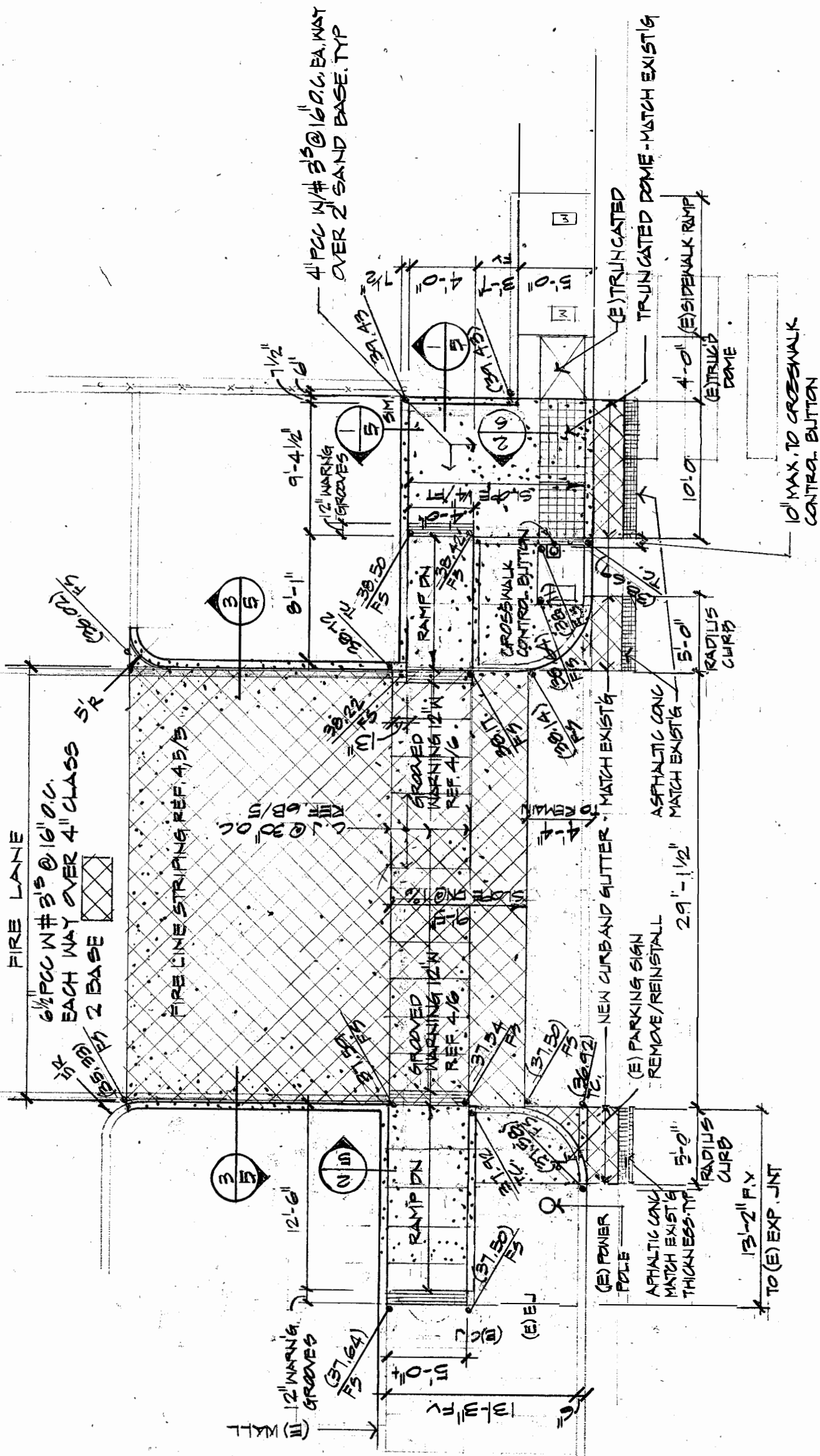

1 PARTIAL SITE PLAN

SCALE: 1/8"=1'-0"

DSA Application No.: NA

File No.: NA

Architecture
LLLP

Glendale Unified School District
VERDUGO WOODLANDS E.S.-DRIVE APRON
Project No.: 10.02.09
DATE: April 16, 2018

DRAWING NO.

4

9



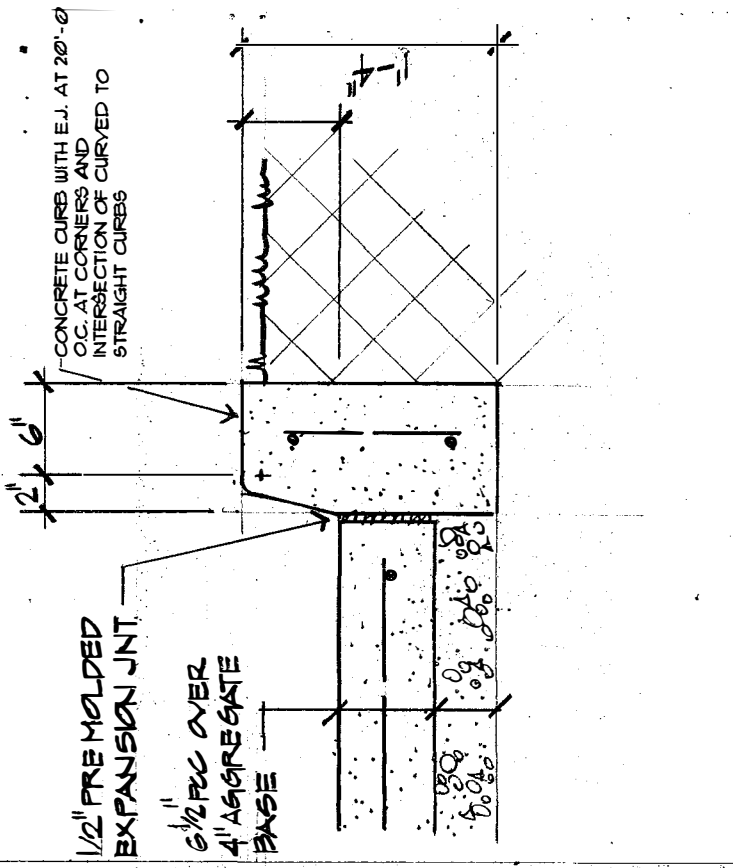

3 CURB DETAIL

SCALE: 1" = 1'-0"

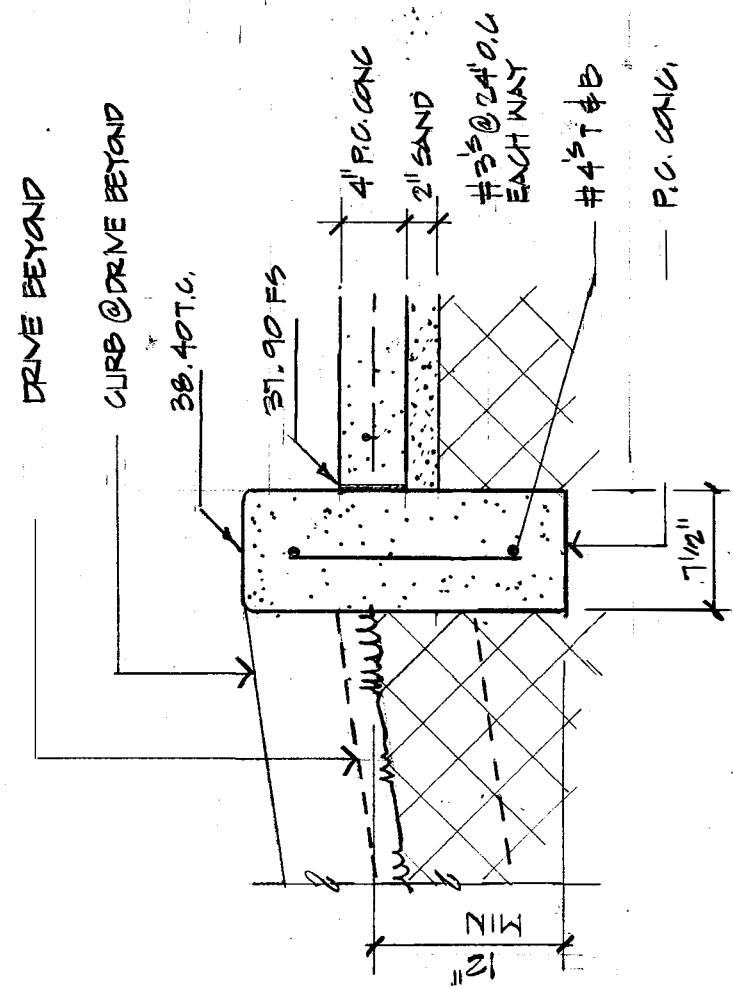

2 DETAIL

SCALE: 1" = 1'-0"

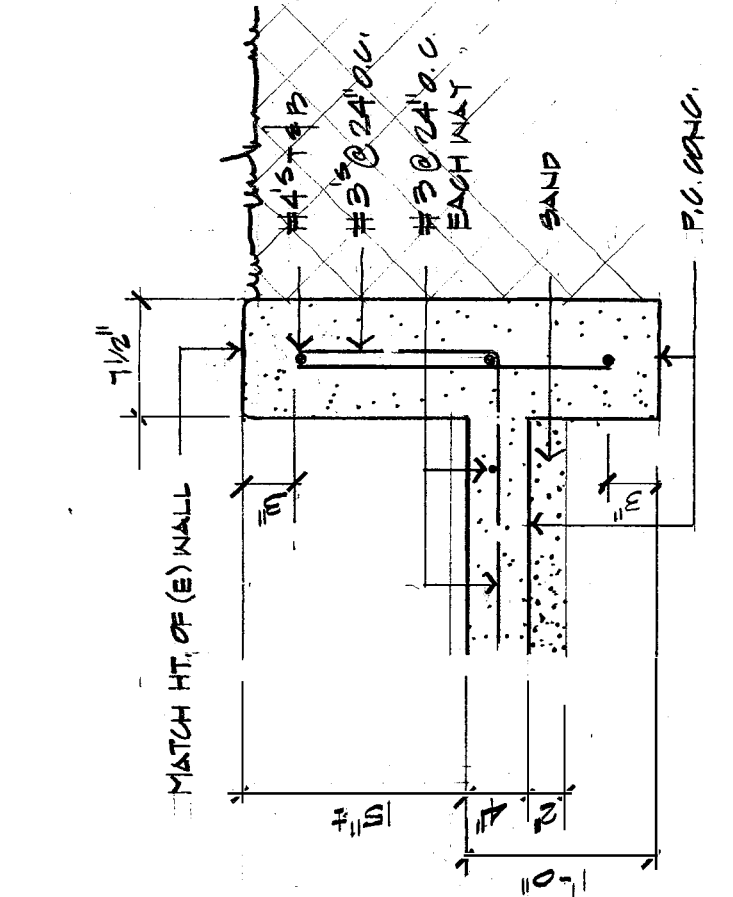

1 DETAIL

SCALE: 1" = 1'-0"

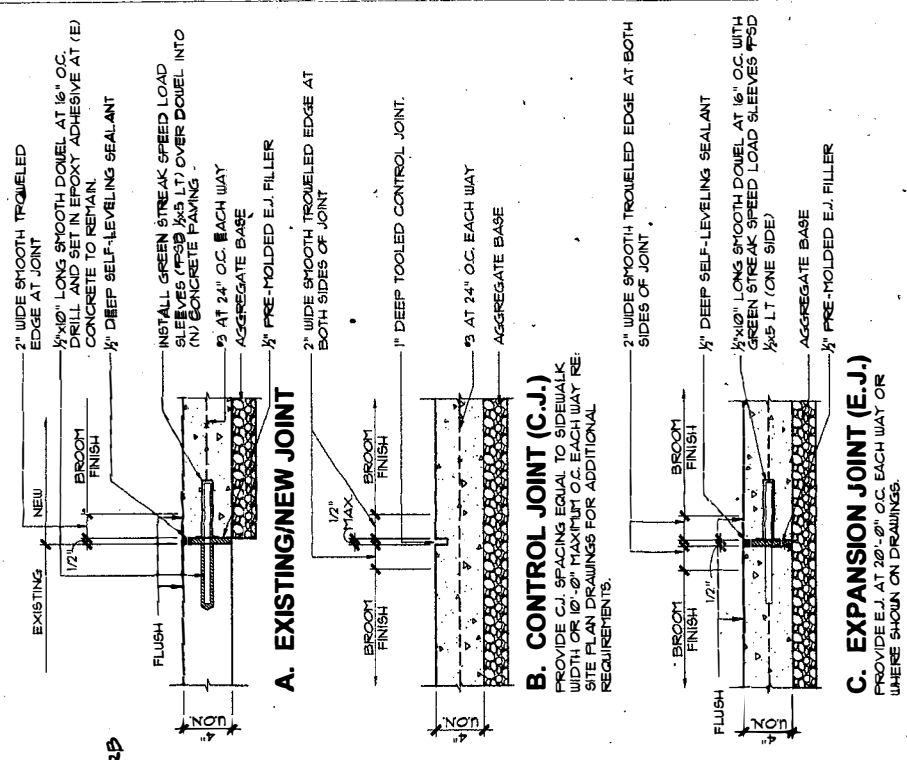

6 DETAILS - CONCRETE SIDEWALK AND PAVING JOINTS

SCALE: 3/4" = 1'-0"

NO PARKING - FIRE LANE

3" HIGH WHITE LETTERING ON TOP AND FACE CURB

- NOTES:
- ALL RAISED CURBS IN "NO PARKING - FIRE LANE" AREAS SHALL BE PAINTED RED WITH ACCEPTABLE RED CURB PAINT AND LETTERED TO THE ABOVE STANDARDS.
 - LETTERING SHALL BE 3" HIGH, WHITE AND HAVE A 3/4" STROKE. LETTERING SHALL BE ON TOP AND FRONT FACE OF ALL FIRE LANE CURBS.
 - MARKINGS TO BE LOCATED EVERY 25 FEET CENTER-TO-CENTER.

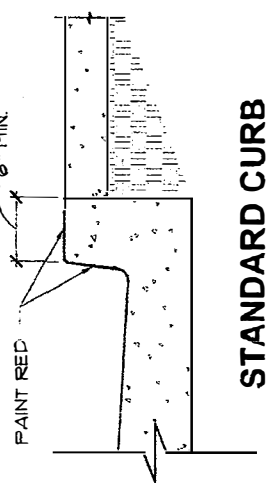

5 FIRE LANE CURB

SCALE: NONE

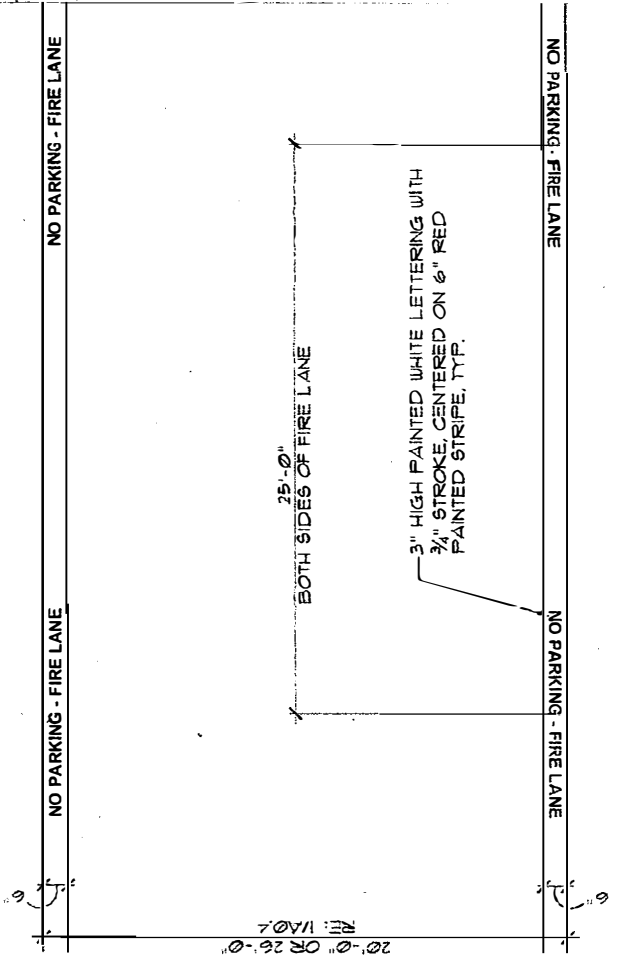

4 FIRE LANE STRIPING DETAIL

SCALE: NONE

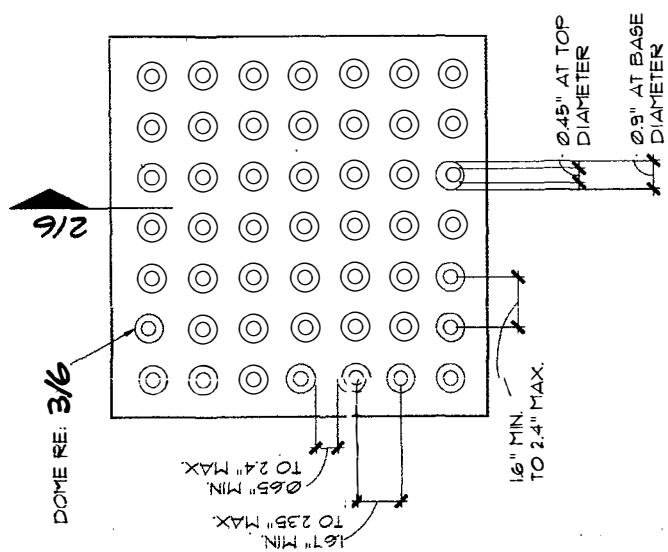

1 TRUNCATED DOME

SCALE: NONE

NOTE: PAVER SHALL HAVE FIVE YEAR WARRANTY

3 SECTION @ DOME

SCALE: NONE

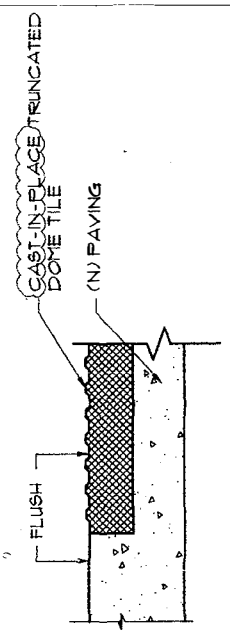

2 SECTION @ TRUNCATED

SCALE: NONE DOME PAVER

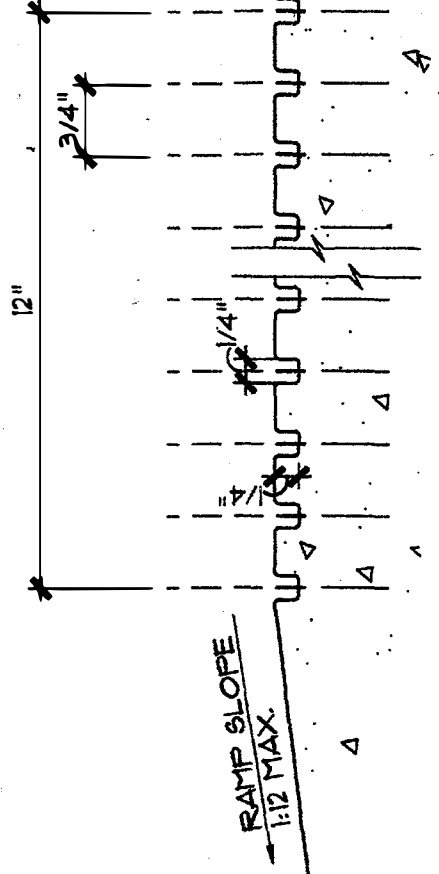

4 TACTILE WARNING GROVES

SCALE: NONE

