

## APPLICATION FOR APPROVAL OF CONSTRUCTION CHANGE DOCUMENT – CCD CATEGORY A/B

This application is for construction changes, as defined in IR A-6, to approved contract documents. This form shall be completed by the Design Professional in General Responsible Charge of the project, in accordance with California Code of Regulations, Title 24, Part 1, Section 4-338 (c) and in compliance with DSA IR A-6.

|                        |               |
|------------------------|---------------|
| School District/Owner: | DSA File #: - |
| Project Name/School:   | DSA App. #: - |

### APPLICANT

|   |                 |   |
|---|-----------------|---|
| CCD Cat. <input type="checkbox"/> A / <input type="checkbox"/> B, #:  | Date Submitted: | Attached Pages?: <input type="checkbox"/> No <input type="checkbox"/> Yes (____pages) |
| For CCD Cat. B, this is a <input type="checkbox"/> voluntary submittal, <input type="checkbox"/> DSA required submittal (attach DSA notification requiring submission). |                 |   |
| Firm Name:  | Contact Name:   |   |
| Email:  | Phone Number:   |   |
| Address:  |                 |   |
| City:   | State:          | Zip:  |
| <input type="checkbox"/> A DSA 301-N, DSA 301-P, or 90-Day Letter has been issued for this project.   |                 |   |
| <input type="checkbox"/> For project currently under construction.  |                 |   |
| <input type="checkbox"/> To obtain DSA approval of existing uncertified building(s).  |                 |   |

### DESIGN PROFESSIONAL IN GENERAL RESPONSIBLE CHARGE

|  |             |
|--|-------------|
| Name of Design Professional in General Responsible Charge: |             |
| Professional License #:                                    | Discipline: |

**Design Professional in General Responsible Charge Statement:** The attached Construction Change Documents have been examined by me for design intent and appear to meet the appropriate requirements of Title 24, California Code of Regulations and the project specifications. They are acceptable for incorporation into the construction of the project.

**Signature:** \_\_\_\_\_  
*DESIGN PROFESSIONAL IN GENERAL RESPONSIBLE CHARGE*

**CHECK THIS BOX:**  To confirm that **all** CCD drawings and, when applicable, first sheet or index of calculations and specifications have been stamped and signed by the Responsible Design Professional listed on DSA 1 for this this project.

|  |
|--|
| Brief description of construction change (attach additional sheets if needed): |
|--|

|   |
|---|
| List of DSA approved drawings affected by this CCD: |
|---|

|   |   |  |
|---|---|--|
| <p style="text-align: center; margin: 0;"><b>DSA USE ONLY</b></p> <p>SSS _____ Date _____ Approved / Disapproved / Not Req'd</p> <p>FLS _____ Date _____ Approved / Disapproved / Not Req'd</p> <p>ACS _____ Date _____ Approved / Disapproved / Not Req'd</p> <p>Remarks _____</p> | <p style="font-size: small; margin: 0;">For business office use only</p> <p>Date Sent _____</p> <p>Return By _____</p> <p>Delivery Method _____</p> | <p style="text-align: center; margin: 0;"><b>DSA Stamp</b></p> |
|---|---|--|





Balboa Elementary School  
1844 Bel Aire Drive, Glendale, CA 91201

DESIGNER

**osborn**

837 North Spring Street / Third Floor / Los Angeles, CA 90012  
Telephone (323) 859-3100 / Fax (323) 859-3100

CONSULTANTS

- CIVIL ENGINEER  
BREEN ENGINEERING
- STRUCTURAL ENGINEER  
KPF CONSULTING ENGINEERS
- MECHANICAL / PLUMBING / ELECTRICAL ENGINEER  
BREEN ENGINEERING
- FIRE PROTECTION ENGINEER  
BREEN ENGINEERING
- DOOR HARDWARE CONSULTANT  
ARCHITECTURAL HARDWARE SERVICES

REGISTRATION



AGENCY APPROVAL

IDENTIFICATION STAMP  
DIVISION OF STATE ARCHITECT  
OFFICE OF REGULATION SERVICES  
FILE NO. 19-41  
APPL. NO. 03-116-363  
AC \_\_\_\_\_ FLS \_\_\_\_\_ SS \_\_\_\_\_  
DATE \_\_\_\_\_

ISSUE

03-31-17 CCDA-035

MARK DATE DESCRIPTION

DESIGNER PROJECT NO.: A1104.7.05

DRAWN BY: Author

CHECKED BY: Checker

SCALE: As indicated

KEY PLAN

**CCDA-035**

SHEET TITLE

**SITE PLAN**

SHEET NUMBER

**A1.11**

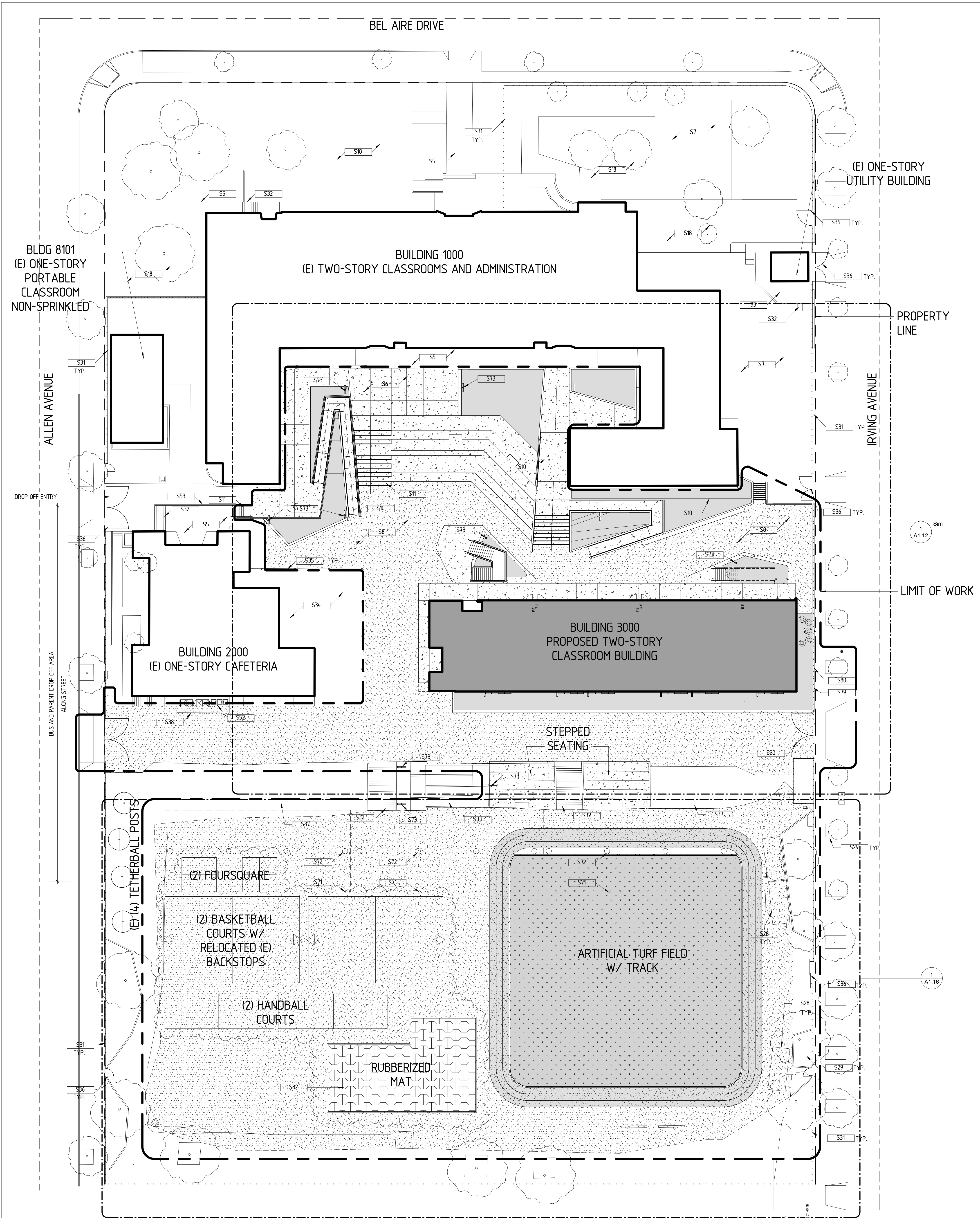

**LEGEND**

|           |                           |
|-----------|---------------------------|
| [Pattern] | EXISTING BUILDING         |
| [Pattern] | NEW BUILDING              |
| [Pattern] | CONCRETE PAVING           |
| [Pattern] | EXISTING A/C PAVING       |
| [Pattern] | A/C PAVING                |
| [Pattern] | PLANTING AREA             |
| [Pattern] | ARTIFICIAL TURF           |
| [Pattern] | ATHLETIC SURFACE COATING  |
| [Pattern] | RUBBERIZED TILE SURFACING |
| [Line]    | LIMIT OF WORK             |

**KEYNOTE**

| KEY | TEXT                                     | KEY | TEXT   |
|-----|--|-----|--|
| S5  | (E) CONCRETE PAVING                      | S36 | (E) GATE   |
| S6  | CONCRETE PAVING                          | S37 | (E) ASPHALT BERM   |
| S7  | (E) ASPHALT PAVING                       | S38 | (E) TRASH ENCLOSURE  |
| S8  | ASPHALT PAVING                           | S52 | (E) SORTING AND RECYCLING WASTE AREA. ALLOCATE A SPECIFIC CONTAINER FOR PAPER, CARDBOARD, GLASS, PLASTICS, METALS AND LANDSCAPE WASTE. |
| S10 | CONCRETE RAMP                            | S53 | (E) GUARDRAIL  |
| S11 | CONCRETE STAIRS SEE 1/S503               | S71 | (E) PV CANNOPY   |
| S18 | (E) PLANTING AREA                        | S72 | (E) STEEL COLUMN/CONCRETE BASE   |
| S20 | 20'-0" WIDE SWINGING GATE. DETAIL 2/A121 | S73 | POLE-MOUNTED SITE LIGHT. SEE 5/A121 AND E-10   |
| S28 | (E) STORAGE CONTAINER                    | S79 | CHAINLINK FENCE  |
| S29 | (E) PLANTER                              | S80 | CONCRETE RETAINING WALL. SEE WALL TYPE R4 4/S502   |
| S31 | (E) CHAIN LINK FENCE                     | S82 | PLAYGROUND OVERHEADS TO BE INSTALLED AT HEIGHTS SPECIFIED BY DISTRICT  |
| S32 | (E) CONCRETE STAIRS                      |     |  |
| S33 | (E) CONCRETE RAMP                        |     |  |
| S34 | (E) LUNCH SHELTER                        |     |  |
| S35 | (E) COLUMN                               |     |  |

**<AS REVISED>**

**1 SITE PLAN**  
SCALE: 1" = 20'-0"





Balboa Elementary School  
1844 Bel Aire Drive, Glendale, CA 91201

DESIGNER

**osborn**

837 North Spring Street / Third Floor / Los Angeles, CA 90012  
Telephone (323) 859 3100 / Fax (323) 859 3100

CONSULTANTS

- CIVIL ENGINEER  
BREEN ENGINEERING
- STRUCTURAL ENGINEER  
KPF CONSULTING ENGINEERS
- MECHANICAL / PLUMBING / ELECTRICAL ENGINEER  
BREEN ENGINEERING
- FIRE PROTECTION ENGINEER  
BREEN ENGINEERING
- DOOR HARDWARE CONSULTANT  
ARCHITECTURAL HARDWARE SERVICES

REGISTRATION



AGENCY APPROVAL

IDENTIFICATION STAMP  
DIVISION OF STATE ARCHITECT  
OFFICE OF REGULATION SERVICES  
FILE NO. 17-41  
APPL NO. 03-116-363  
AC \_\_\_\_\_ FLS \_\_\_\_\_ SS \_\_\_\_\_  
DATE \_\_\_\_\_

ISSUE

03-31-17 CCDA-035

MARK DATE DESCRIPTION

DESIGNER PROJECT NO.: A1104.7.05  
DRAWN BY: Author  
CHECKED BY: Checker  
SCALE: As indicated

KEY PLAN

CCDA-035

SHEET TITLE

PARTIAL SITE PLAN @ FIELD

SHEET NUMBER

A1.16

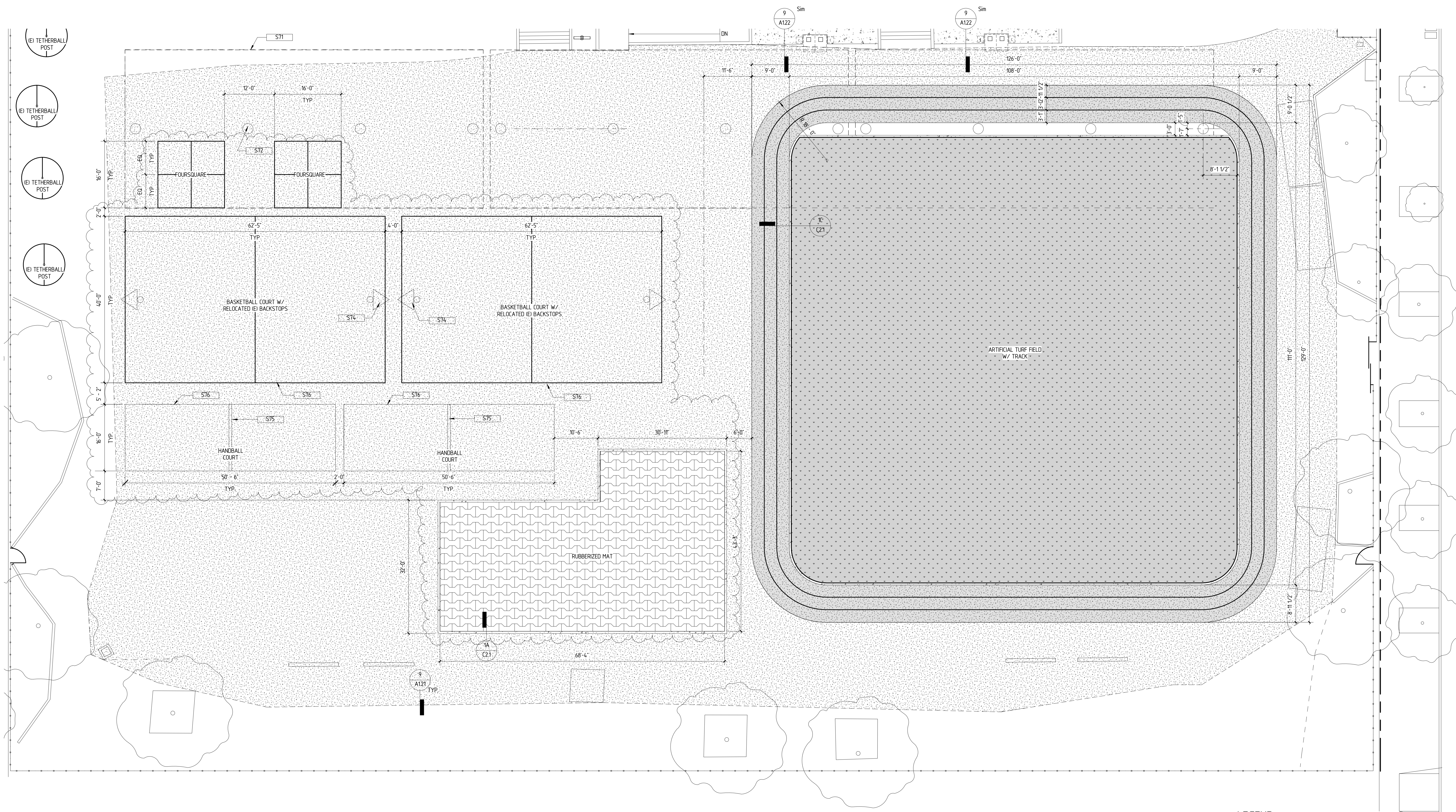

1 ENLARGED SITE PLAN @ FIELD  
SCALE: 1" = 10'-0"

KEYNOTES

| KEY | TEXT  |
|-----|---|
| S71 | (E) PV CANOPY   |
| S72 | (E) STEEL COLUMN/CONCRETE BASE  |
| S74 | RELOCATED (E) BASKETBALL BACKSTOP & GOAL. SEE 6/A121 FOR FOUNDATION DETAIL. |
| S75 | HANDBALL COURT WALL. SEE 7/A121.  |
| S76 | PAVEMENT STRIPING.  |

LEGEND

- EXISTING BUILDING
- NEW BUILDING
- CONCRETE PAVING
- EXISTING A/C PAVING
- A/C PAVING
- PLANTING AREA
- ARTIFICIAL TURF
- ATHLETIC SURFACE COATING
- RUBBERIZED TILE SURFACING
- LIMIT OF WORK

<AS REVISED>



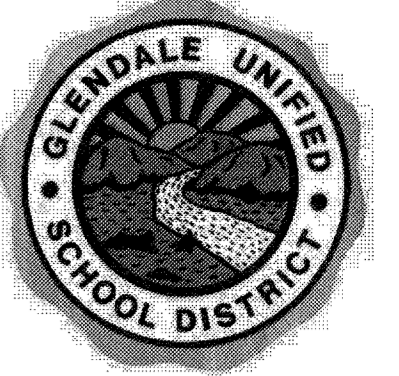

Balboa Elementary School  
1844 Bel Aire Drive, Glendale, CA 91201

DESIGNER



837 North Spring Street / Third Floor / Los Angeles, CA 90012  
Telephone (323) 859 3100 / Fax (323) 859 3110

CONSULTANTS

- CIVIL ENGINEER  
BREEN ENGINEERING
- STRUCTURAL ENGINEER  
KPF CONSULTING ENGINEERS
- MECHANICAL / PLUMBING / ELECTRICAL ENGINEER  
BREEN ENGINEERING
- FIRE PROTECTION ENGINEER  
BREEN ENGINEERING
- DOOR HARDWARE CONSULTANT  
ARCHITECTURAL HARDWARE SERVICES

REGISTRATION

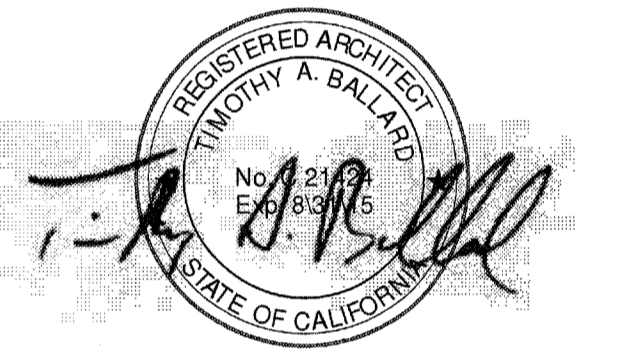

AGENCY APPROVAL

IDENTIFICATION STAMP  
DIVISION OF STATE ARCHITECT  
OFFICE OF REGULATION SERVICES  
FILE NO. 19-41  
APPL. NO. 03-114363  
AC \_\_\_\_\_ FLS \_\_\_\_\_ SS \_\_\_\_\_  
DATE \_\_\_\_\_

ISSUE

5-4-15 DSA ADDENDUM #1

MARK DATE DESCRIPTION

DESIGNER PROJECT NO.: A11047.05

DRAWN BY: Author

CHECKED BY: Checker

SCALE: As indicated

KEY PLAN

APPROVED  
DIV. OF THE STATE ARCHITECT  
LOS ANGELES BASIN REGIONAL OFFICE  
AC \_\_\_\_\_ FLS \_\_\_\_\_ SS \_\_\_\_\_  
APPL. NO. \_\_\_\_\_ DATE: OCT 7 2015  
3 - 1 1 4 3 6 3

SHEET TITLE

SITE PLAN

SHEET NUMBER

A1.11

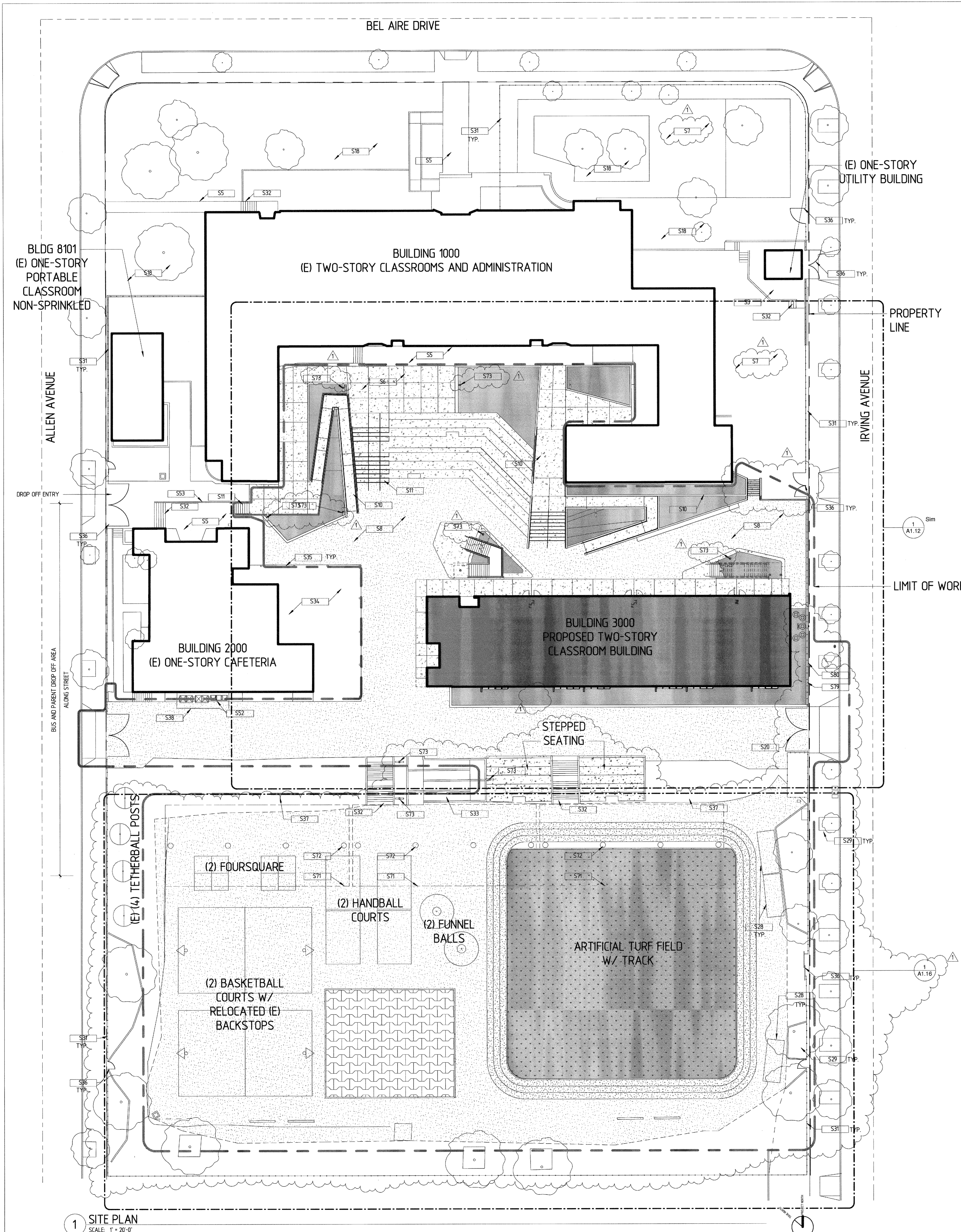

**LEGEND**

- EXISTING BUILDING
- NEW BUILDINGS
- CONCRETE PAVING
- EXISTING A/C PAVING
- A/C PAVING
- PLANTING AREA
- ARTIFICIAL TURF
- ATHLETIC SURFACE COATING
- RUBBERIZED TILE SURFACING
- LIMIT OF WORK

**KEYNOTE**

| KEY | TEXT                                     | KEY | TEXT  |
|-----|--|-----|---|
| S5  | (E) CONCRETE PAVING                      | S35 | (E) COLUMN  |
| S6  | CONCRETE PAVING                          | S36 | (E) GATE  |
| S7  | (E) ASPHALT PAVING                       | S37 | (E) ASPHALT BERM  |
| S8  | ASPHALT PAVING                           | S38 | (E) TRASH ENCLOSURE   |
| S10 | CONCRETE RAMP                            | S52 | (E) SORTING AND RECYCLING WASTE AREA. ALLOCATE A SPECIFIC CONTAINER FOR PAPER, CARDBOARD, GLASS, PLASTICS, METALS AND LANDSCAPE WASTE |
| S11 | CONCRETE STAIRS SEE 1/S503               | S53 | (E) GUARDRAIL   |
| S18 | (E) PLANTING AREA                        | S71 | (E) PV CANOPY   |
| S20 | 20'-0" WIDE SWINGING GATE. DETAIL 2/A121 | S72 | (E) STEEL COLUMN/CONCRETE BASE  |
| S28 | (E) STORAGE CONTAINER                    | S73 | POLE-MOUNTED SITE LIGHT. SEE 5/A121 AND E-10  |
| S29 | (E) PLANTER                              | S79 | CHAINLINK FENCE   |
| S31 | (E) CHAIN LINK FENCE                     | S80 | CONCRETE RETAINING WALL SEE WALL TYPE RA 4/S503   |
| S32 | (E) CONCRETE STAIRS                      |     |   |
| S33 | (E) CONCRETE RAMP                        |     |   |
| S34 | (E) LUNCH SHELTER                        |     |   |

<AS APPROVED>

1 SITE PLAN  
SCALE: 1" = 20'-0"



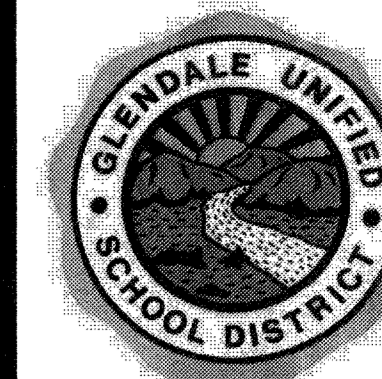

Balboa Elementary School  
1844 Bel Aire Drive, Glendale, CA 91201

DESIGNER



837 North Spring Street / Third Floor / Los Angeles, CA 90012  
Telephone (323) 859 3100 / Fax (323) 859 3100

CONSULTANTS

- CIVIL ENGINEER
- BREEN ENGINEERING
- STRUCTURAL ENGINEER
- KOFF CONSULTING ENGINEERS
- MECHANICAL / PLUMBING / ELECTRICAL ENGINEER
- BREEN ENGINEERING
- FIRE PROTECTION ENGINEER
- BREEN ENGINEERING

DOOR HARDWARE CONSULTANT  
ARCHITECTURAL HARDWARE SERVICES

REGISTRATION

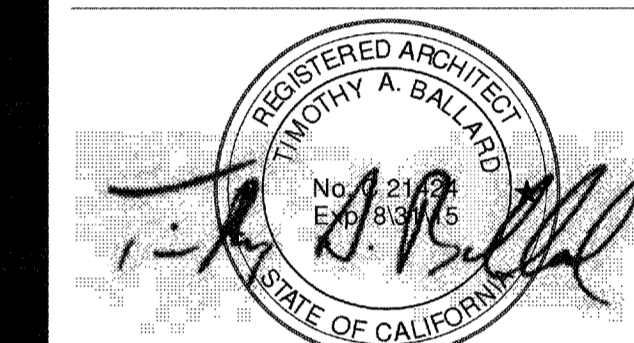

AGENCY APPROVAL

IDENTIFICATION STAMP  
DIVISION OF STATE ARCHITECT  
OFFICE OF REGULATION SERVICES  
FILE NO. 19-41  
APPL. NO. 03-114363  
AC \_\_\_\_\_ FLS \_\_\_\_\_ SS \_\_\_\_\_  
DATE \_\_\_\_\_

ISSUE

5-4-15 DSA ADDENDUM #1

MARK DATE DESCRIPTION

DESIGNER PROJECT NO.: A11047.05  
DRAWN BY: Author  
CHECKED BY: Checker  
SCALE: As indicated

KEY PLAN

APPROVED  
DIV. OF THE STATE ARCHITECT  
LOS ANGELES BASIN REGIONAL OFFICE  
AC \_\_\_\_\_ FLS \_\_\_\_\_ SS \_\_\_\_\_  
APPL. NO. 03-114363  
3-114363

SHEET TITLE

PARTIAL SITE PLAN @ FIELD

SHEET NUMBER

A1.16

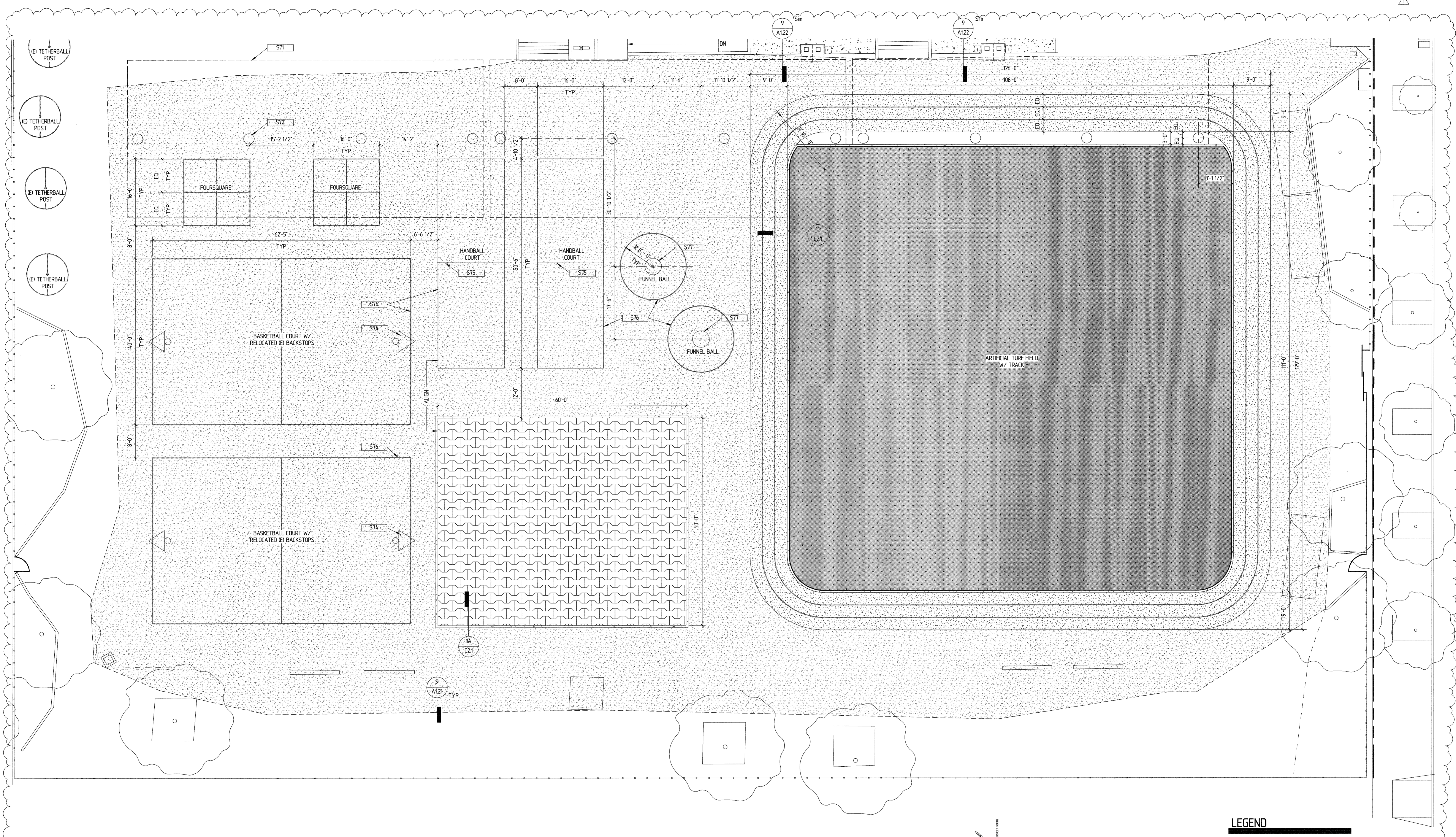

1 ENLARGED SITE PLAN @ FIELD  
SCALE 1" = 10'-0"

KEYNOTES

| KEY | TEXT  |
|-----|---|
| S71 | (E) PV CANDLEY  |
| S72 | (E) STEEL COLUMN/CONCRETE BASE  |
| S74 | RELOCATED (E) BASKETBALL BACKSTOP & GOAL. SEE 6/A121 FOR FOUNDATION DETAIL. |
| S75 | HANDBALL COURT WALL. SEE 7/A121   |
| S76 | PAVEMENT STRIPING   |
| S77 | FUNNELBALL EQUIPMENT. SEE 6/A121 FOR FOUNDATION DETAIL.                     |

LEGEND

- EXISTING BUILDING
- NEW BUILDING
- CONCRETE PAVING
- EXISTING A/C PAVING
- A/C PAVING
- PLANTING AREA
- ARTIFICIAL TURF
- ATHLETIC SURFACE COATING
- RUBBERIZED TILE SURFACING
- LIMIT OF WORK

<AS APPROVED>