

Germantown Central School District
Capital Project Update
Schematic Design Report

SAMMEL ARCHITECTURE PLLC

January 27, 2016

Germantown Central School District Capital Project Update

Work in Progress – JANUARY 2016

A. Meetings

Tectonic Engineering & Surveying Consultants

OLA Consulting Engineers

Theatre Projects Consultants

B. Borings complete

C. Survey complete

D. Estimate evaluated – work prioritized – estimate revised

Work Planned – FEBRUARY 2016

A. Continue project development

B. Final Design Meetings

C. Meet with Sewer Department regarding connecting to trunk on 9G.

D. Refine Auditorium shape and volume for sightlines and acoustics.

E. Develop Schedule

F. Begin discussions about Construction / Project Manager

Borings Report

Of the eleven borings drilled three pertain to a new sewer line connected to the municipal sewer.

These borings drilled to a six foot depth did not show the presence of rock massing.

Boring log from 1968 HS Gym Addition Indicates rock mass at seven and twelve feet below grade.

Sewer trunk ends on the North side of the Bank property and would need to be extended to the school property line.

+/- 170' TO SEWER LINE

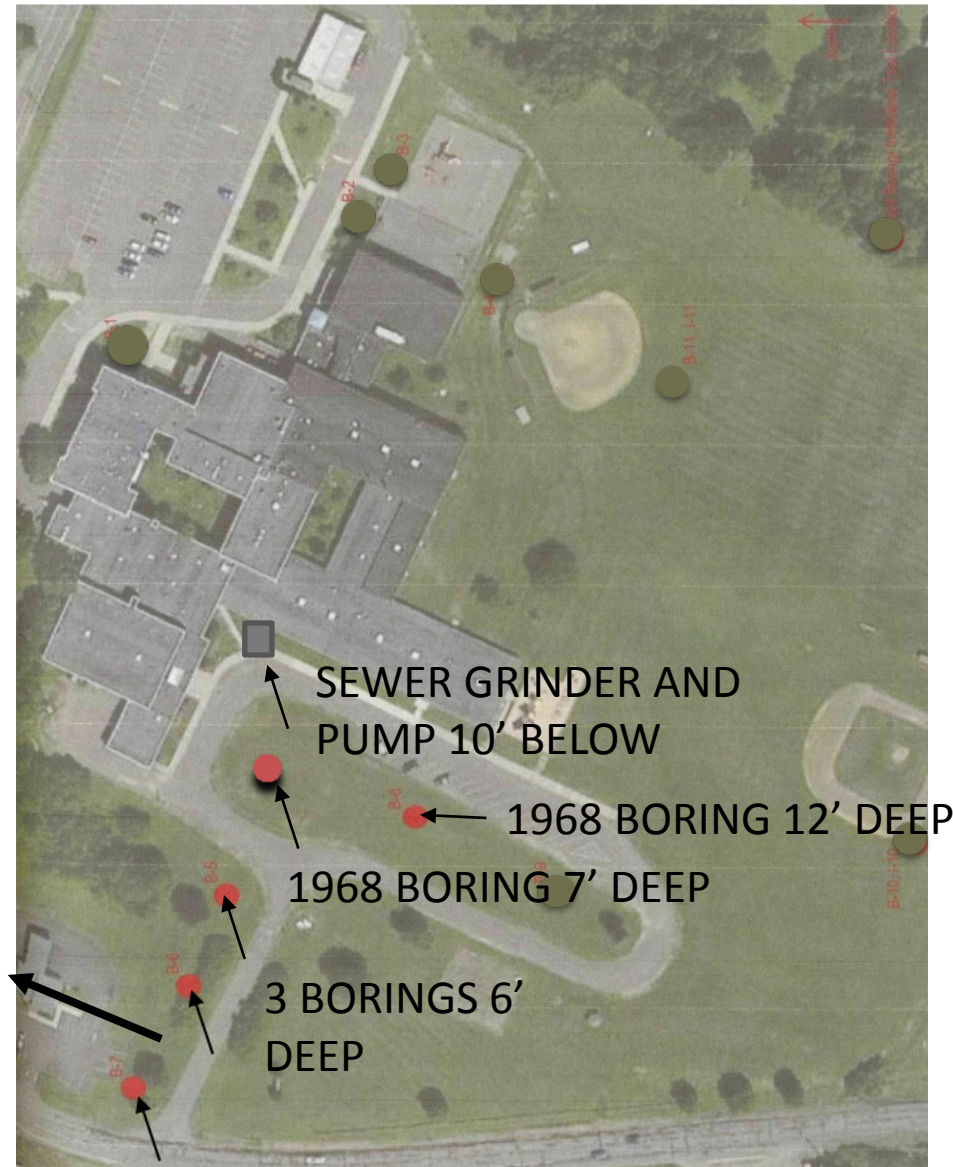

Walking Path

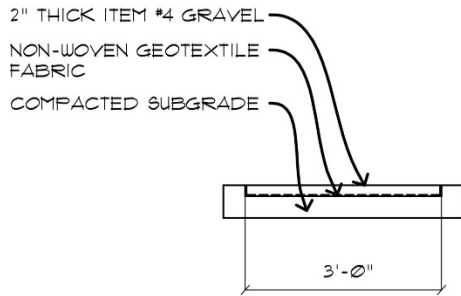

1 GRAVEL TRAIL DETAIL
SCALE: 1/2" = 1'-0"

GRAVEL TRAIL



GRAVEL TRAIL

In order to meet access requests and reduce cost, the path will be reduced from six feet wide to three feet wide and may utilize Mountain View Road to continue the loop.

SCOPE NOTES:

GRAVEL TRAIL: 2139 LF @ 3 FT WIDE

Sinks and Countertop Replacement



Four existing counter tops and cabinets are stainless steel and in good shape. These eleven foot long units will be refinished and will remain.

Secure Vestibule

Rework Elementary Principals office and under utilized adjacent office and provide Security Office. Add new secure entry area.

○ VISITOR ENTRANCE

✦ STAFF ENTRANCE

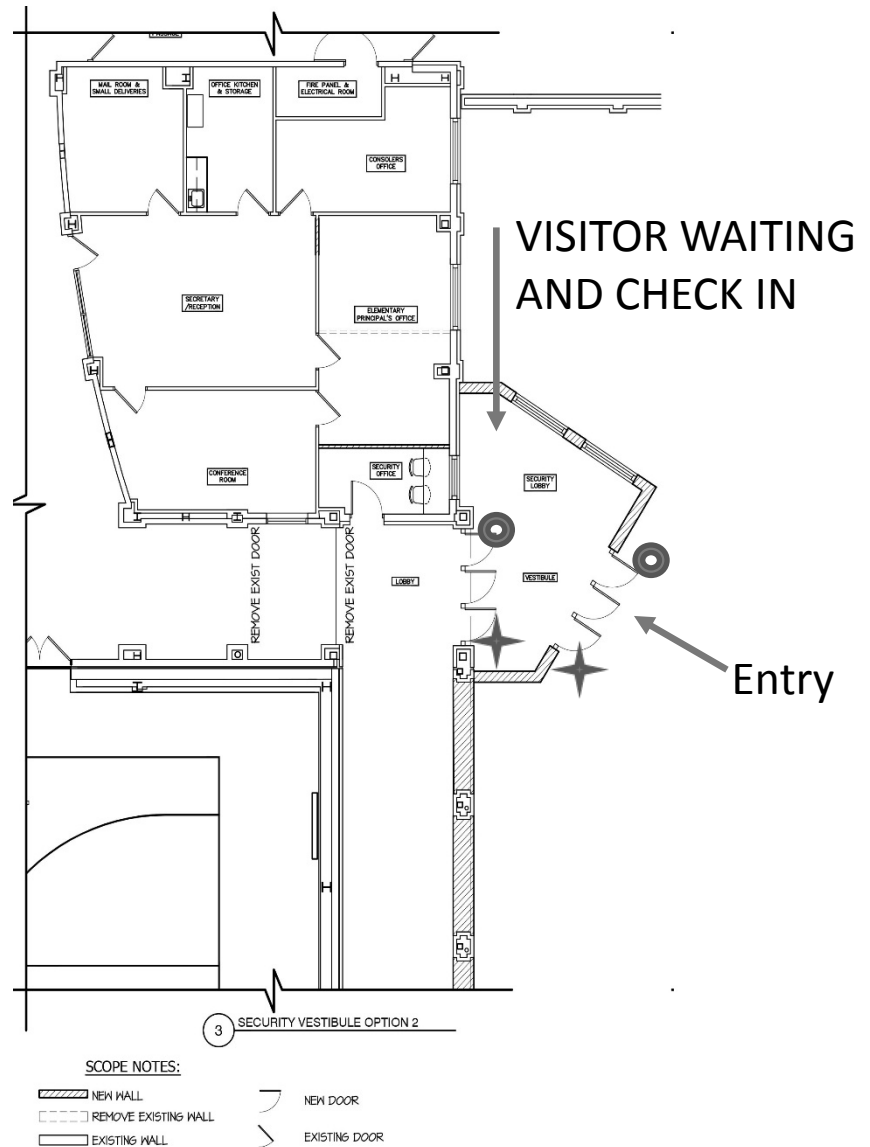

Kitchen

Work scope prioritized and scaled back permitting most efficient use of space based on the original budget.

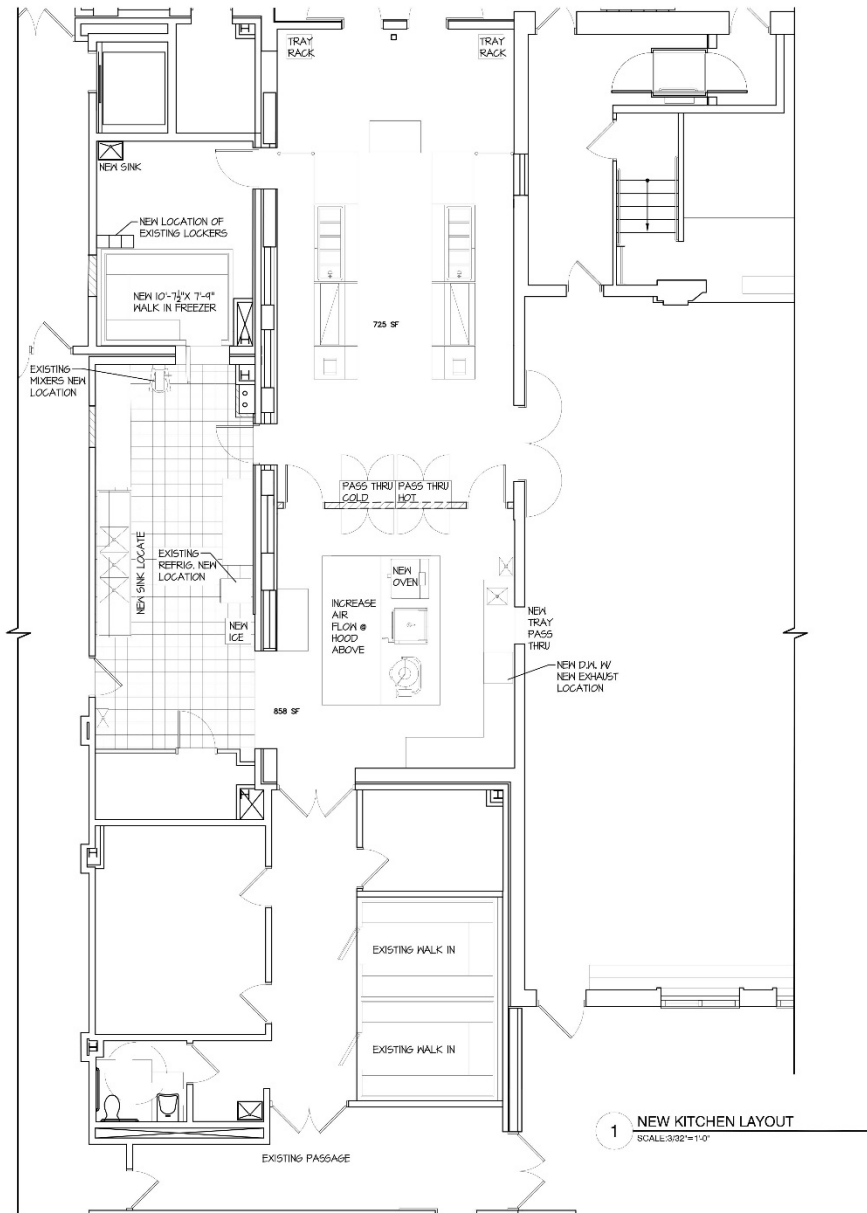

-  NEW MALL
-  REMOVE EXISTING WALL
-  EXISTING WALL
-  NEW DOOR
-  EXISTING DOOR TO REMAIN
-  EXISTING DOOR TO BE REMOVED

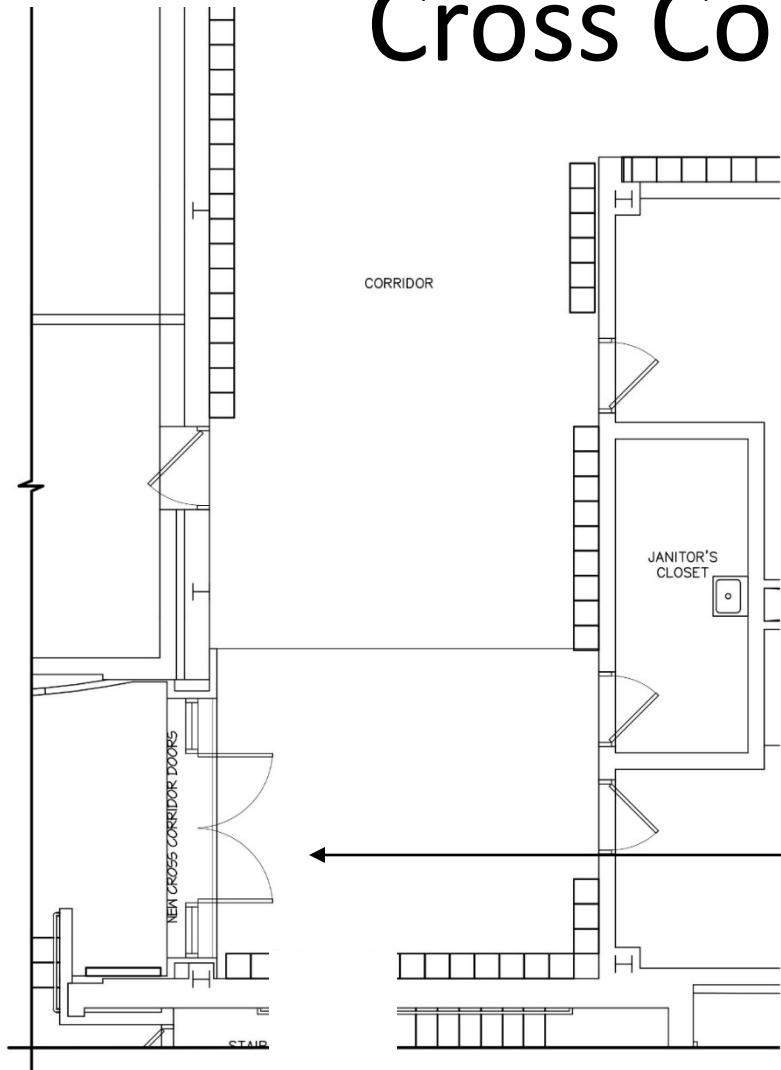

PROVIDE: 471 SF FLOOR TILE
1540 SF WALL TILE
100 SF FLOOR LEVELING
900 SF PAINT WALL
671 SF PAINT CEILING

Cross Corridor Doors



1 NEW CROSS CORRIDOR DOORS
SCALE: 3/16"=1'-0"

SCOPE NOTES:

-  NEW WALL
-  REMOVE EXISTING WALL
-  EXISTING WALL

-  NEW DOOR
-  EXISTING DOOR TO REMAIN
-  EXISTING DOOR TO BE REMOVED

NOTES:

REMOVED 24 CORRIDOR LOCKERS WITHO

SED permitted a variance for cross corridor secure doors 2'-0" beyond code limit.

Having been granted a variance for cross corridor doors by the SED renovation to the toilet rooms is not necessary.

Stage Renovation

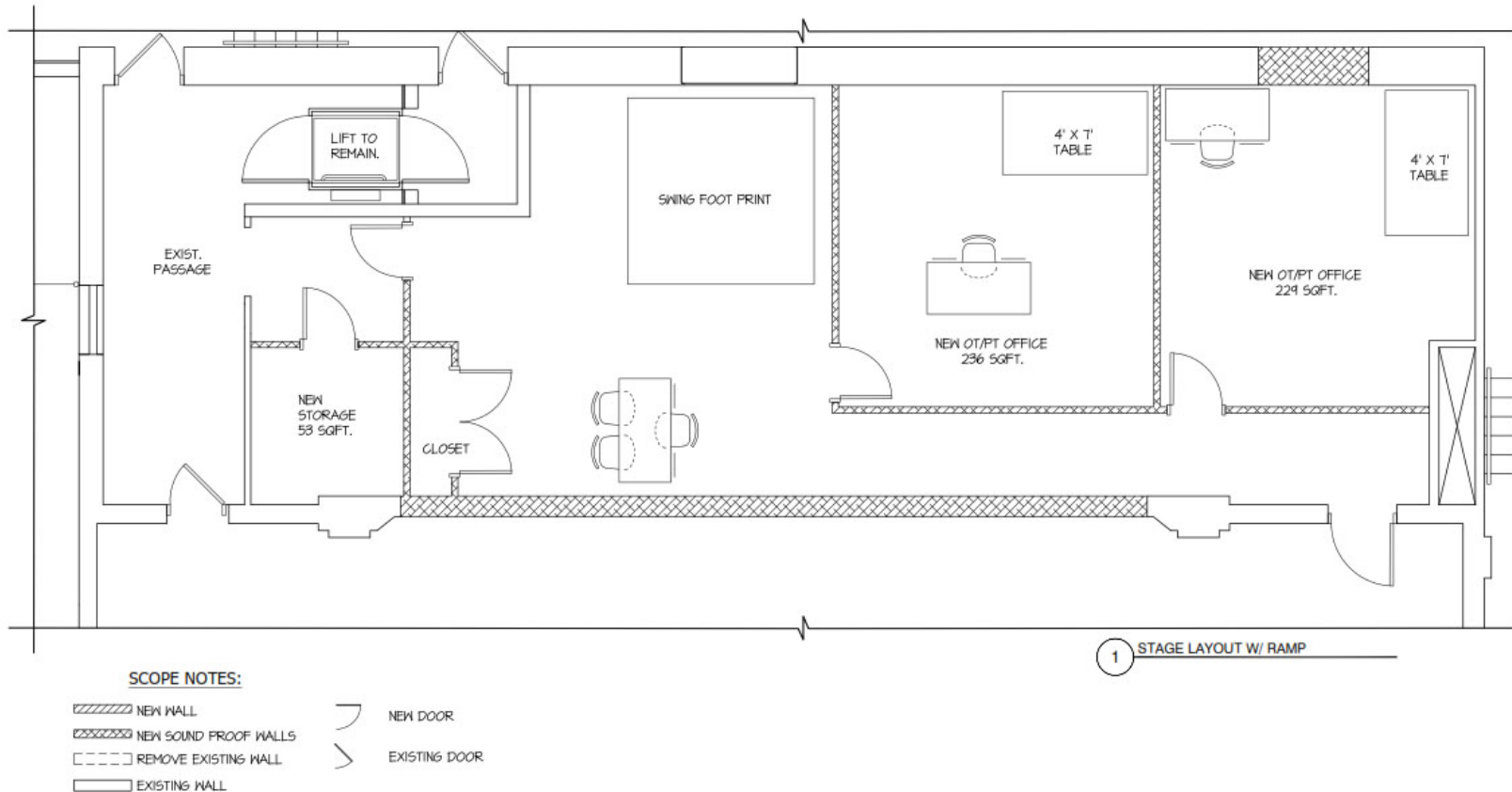

Current layout for OT/PT at existing stage

Renovate Baseball and Softball Fields

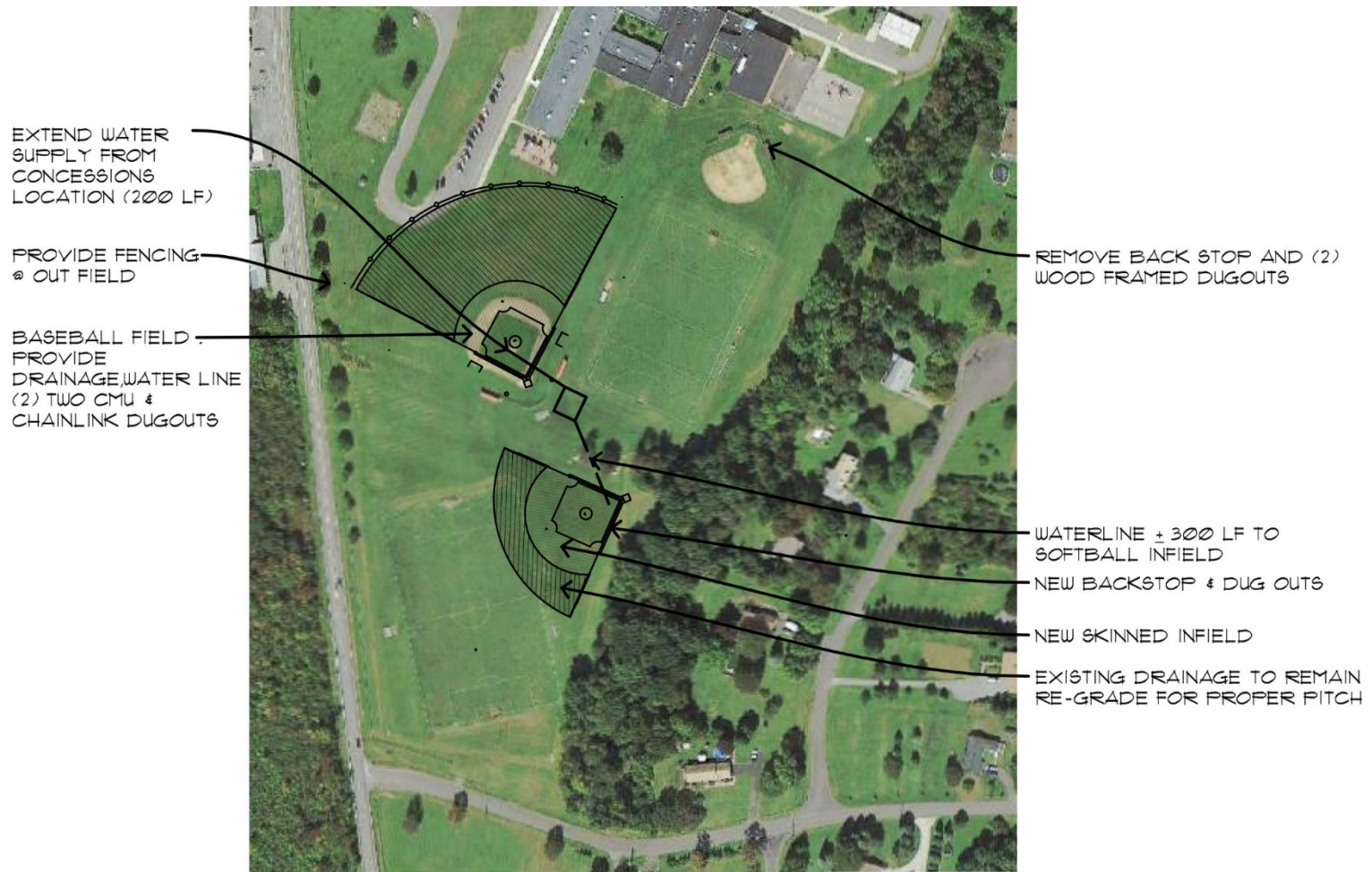

The area adjacent to the soccer field have drain piping which was installed when the soccer field was renovated. Locating the softball field here will reduce the cost and allow for larger play fields behind elementary gym.





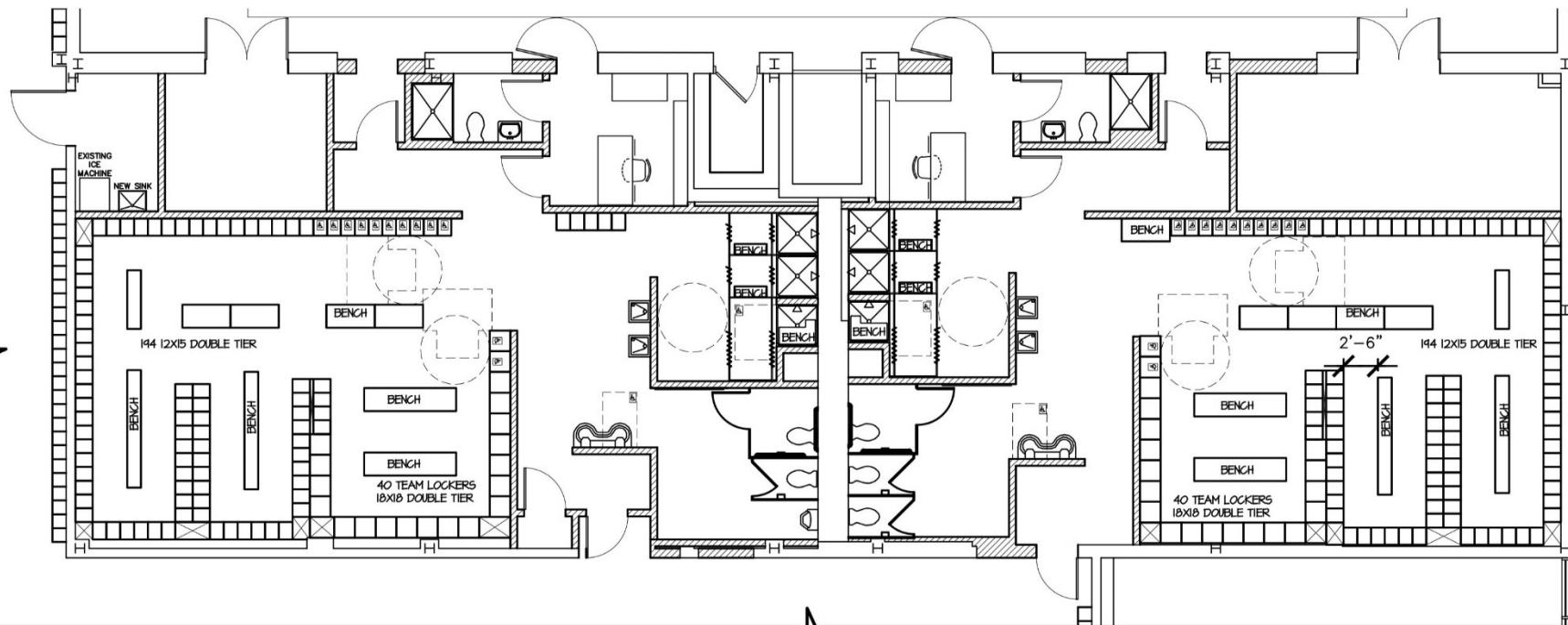



Locker Rooms

Design substantially complete.



2 NEW LOCKER ROOMS LAYOUT
SCALE: 3/32" = 1'-0"

SCOPE NOTES:

-  NEW WALL
-  REMOVE EXISTING WALL
-  EXISTING WALL
-  ADA LOCKER (5%)
ADA LOCKER IN SINGLE OR DOUBLE TIER
-  LOCKERS TO BE REMOVED
-  NEW DOOR
-  EXISTING DOOR TO REMAIN
-  EXISTING DOOR TO BE REMOVED

NOTES:

REMOVED 7 CORRIDOR LOCKERS WITHOUT REPLACEMENT

GYM LOCKER:

GIRL'S LOCKER ROOM
234 LOCKERS TOTAL
144 15X12 DOUBLE TIER
40 18X18 DOUBLE TIER

BOY'S LOCKER ROOM
234 LOCKERS TOTAL
144 15X12 DOUBLE TIER
40 18X18 DOUBLE TIER

Fitness Center

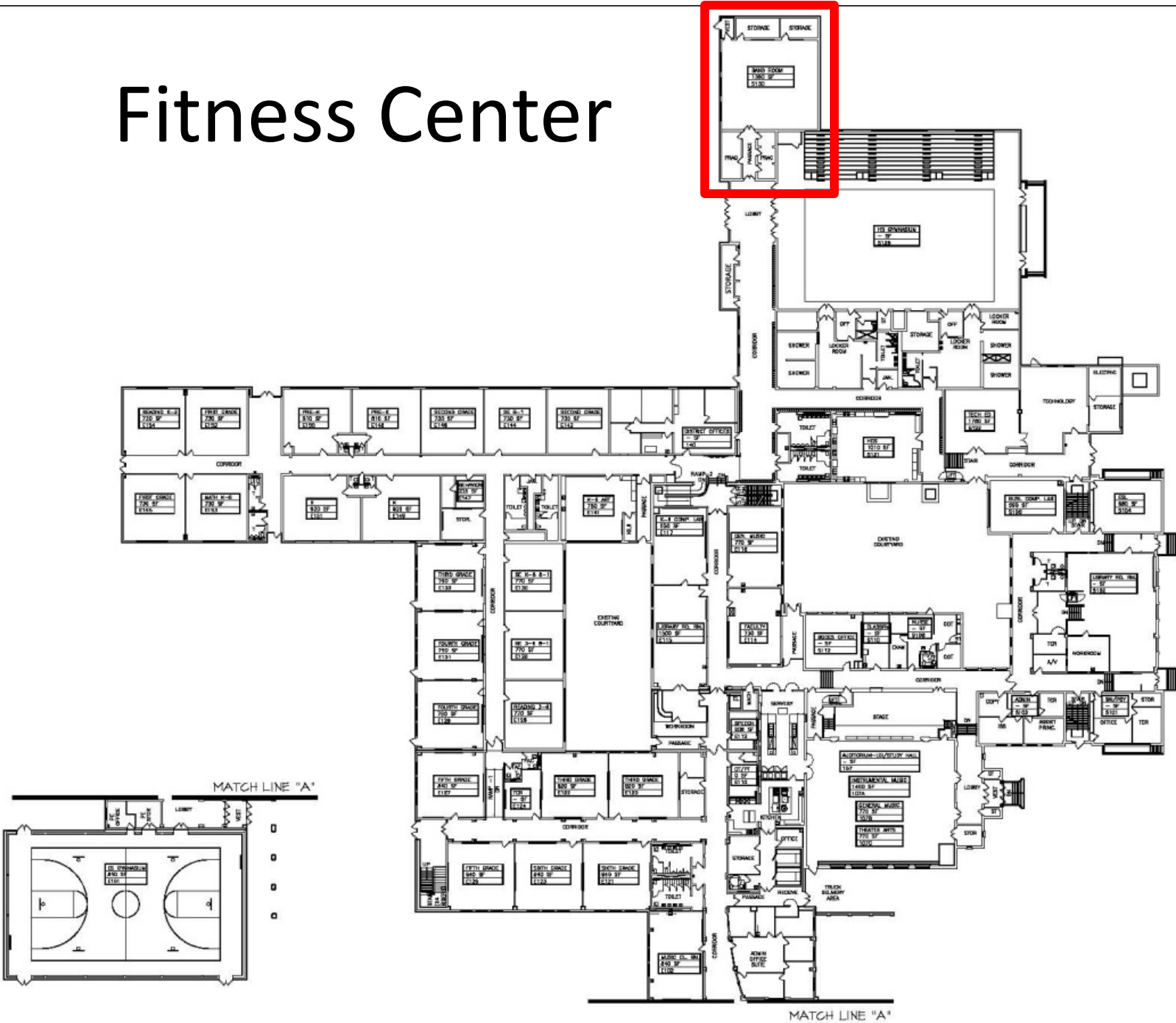

Addition

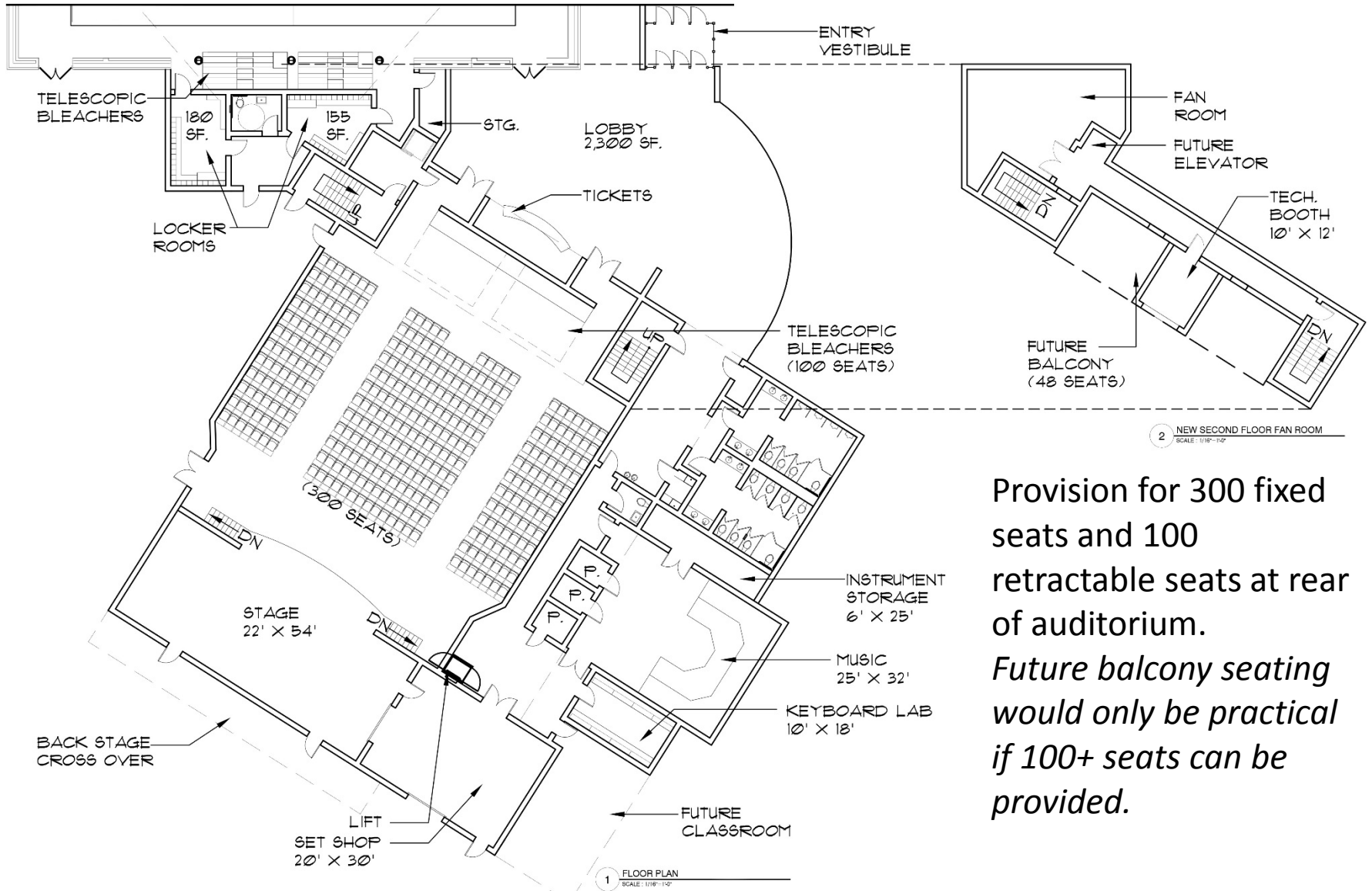

Provision for 300 fixed seats and 100 retractable seats at rear of auditorium. *Future balcony seating would only be practical if 100+ seats can be provided.*

Retractable Auditorium Seating



Folding upholstered bench seating will allow for a multi-function space at the rear of the Auditorium House

Addition



Proposed Building Massing of Music Suite Addition

Questions?

