

FULLER MIDDLE SCHOOL PROJECT  
Neighborhood Presentation  
Fuller Middle School

June 26, 2021

# Agenda

1. Project Timeline
2. Construction Logistics
3. Parent, Staff, and Bus Circulation Routes
4. Questions and Input

# SCHOOL BUILDING COMMITTEE MEMBERS

Dr. Yvonne Spicer

David Miles

Dr. Edward Gotgart

Thatcher Kezer, III

Adam Freudberg

Dr. Robert Tremblay

Scott Wadland

Richard Finlay

Mary Ellen Kelley

Jennifer Pratt

Matt Torti

Anne Ludes

Kerry Wood

Mayor

Co-Chair

Co-Chair

Chief Operating Officer

School Committee Chair

Superintendent of Schools

School Committee Member

School Committee Member

Chief Financial Officer

Chief Procurement Officer

Director of Buildings and Grounds

Assistant Superintendent for

Secondary Education

Principal, Fuller Middle School

# SCHOOL BUILDING COMMITTEE MEMBERS

Charlie Sisitsky

Former City Council Member

Noval Alexander

Former School Committee

Member

Richard Weader II

Member

Michael Grilli

Member

Dr. Jennifer Krusinger Martin

Member

Donald C. Taggart III

Member

David Panich

Member

Cynthia Blackwell

Member

# PROJECT TIMELINE

Summer 2019 – Construction Commenced

Summer 2021 – New Building Completed

December 2021 – Demolition Completed

Summer 2022 – Sitework Completed



# SITE PLAN

3-Story, 137,000 sq ft Middle School  
630 Students for Grades 6-8

COMMUNITY ACCESS  
GYM & AUDITORIUM

NEW FULLER MIDDLE SCHOOL

NEW PARKING

NEW PARKING

FARLEY / MASS BAY

FOOTPRINT OF EXISTING 1958  
BUILDING TO BE REMOVED

SLOPED LAWN

MCCARTHY ELEMENTARY SCHOOL





# Construction Update

## Fuller Middle School



## June Project Updates

### FOUR WEEK LOOK AHEAD

- Complete gym bleacher install
- Complete landscaping work at amphitheater and main entrance
- Complete installation of breakout space glazing
- Substantially complete installation of metal panel facade on exterior of building
- Substantially complete installation of finishes including paint, millwork, wall tile and ceilings

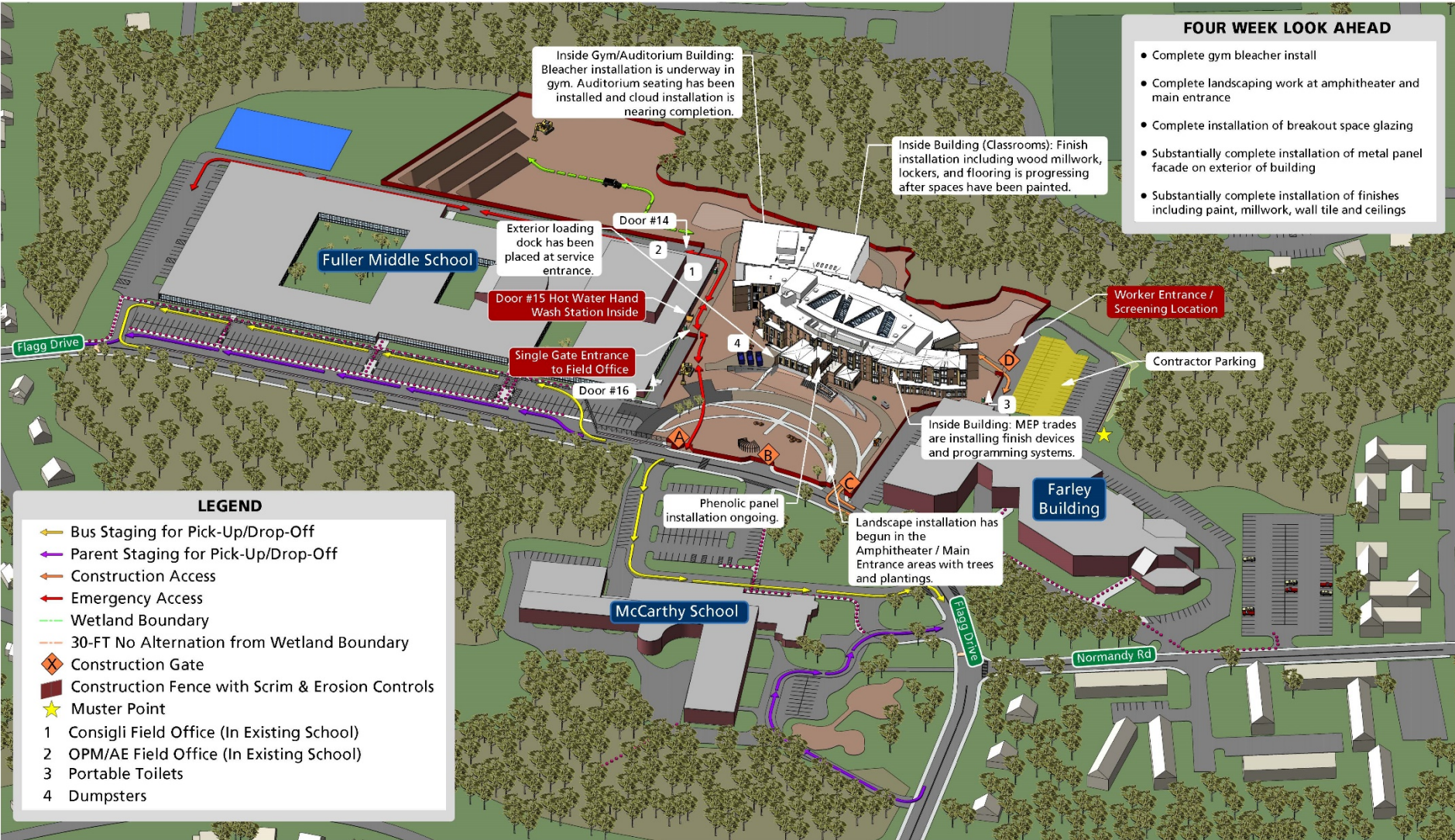

### LEGEND

- ↔ Bus Staging for Pick-Up/Drop-Off
- ↔ Parent Staging for Pick-Up/Drop-Off
- ↔ Construction Access
- ↔ Emergency Access
- ↔ Wetland Boundary
- ↔ 30-FT No Alternation from Wetland Boundary
- ◆ Construction Gate
- Construction Fence with Scrim & Erosion Controls
- ★ Muster Point
- 1 Consigli Field Office (In Existing School)
- 2 OPM/AE Field Office (In Existing School)
- 3 Portable Toilets
- 4 Dumpsters



# Construction Logistics – Fall 2021

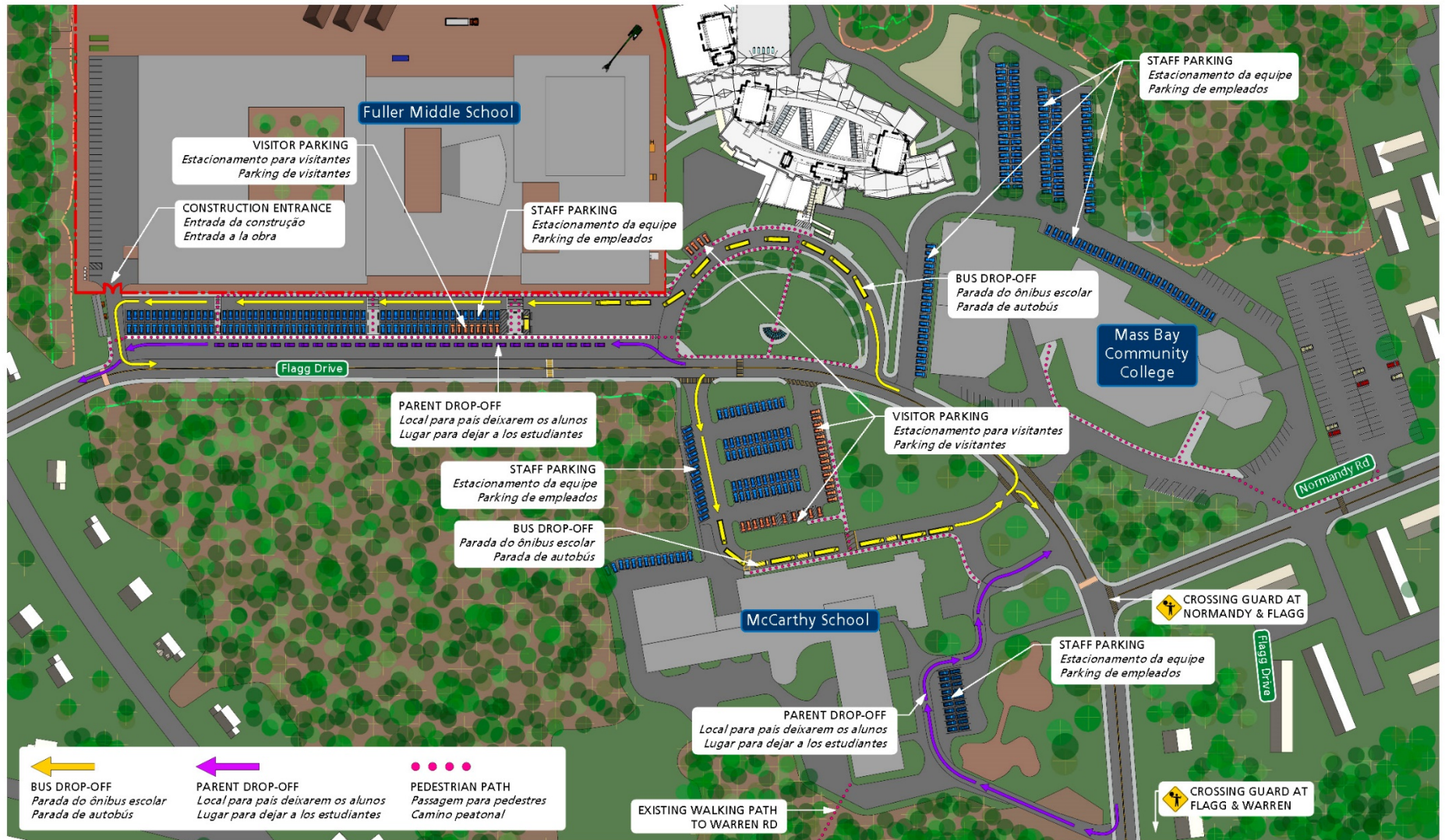

## FULLER MIDDLE SCHOOL & MCCARTHY ELEMENTARY SCHOOL

FALL 2021 TRAFFIC PLAN

Plano de tráfego do outono de 2021

Plan de tráfico para el otoño de 2021



# Construction Logistics – Spring 2022

## Fuller Middle School



Phase 4 New Site Construction  
Spring 2022

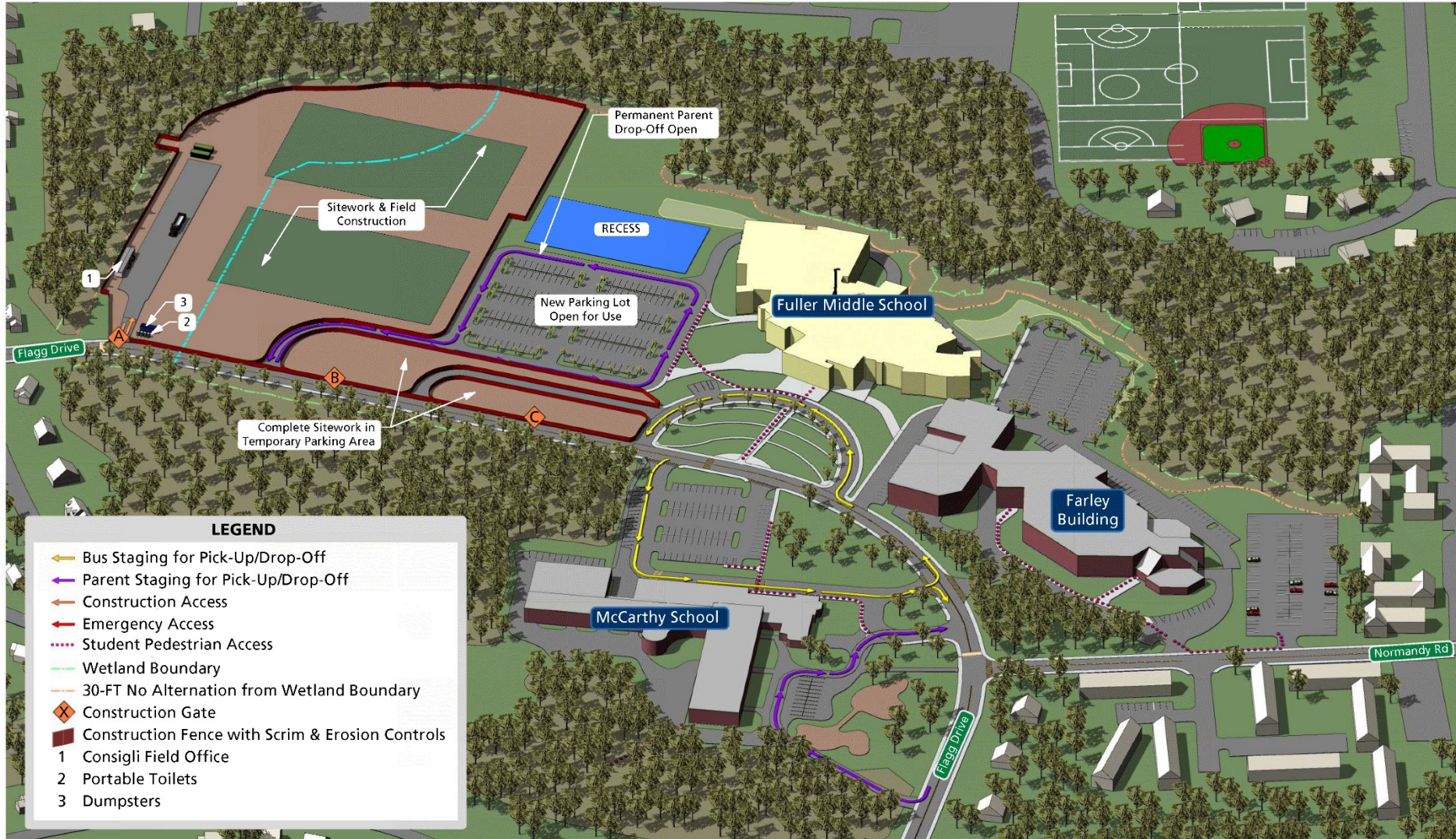

### LEGEND

- Bus Staging for Pick-Up/Drop-Off
- Parent Staging for Pick-Up/Drop-Off
- Construction Access
- Emergency Access
- Student Pedestrian Access
- Wetland Boundary
- 30-FT No Alteration from Wetland Boundary
- Construction Gate
- Construction Fence with Scrim & Erosion Controls
- 1 Consigli Field Office
- 2 Portable Toilets
- 3 Dumpsters



# Fuller Parent, Staff, and Bus Circulation Routes

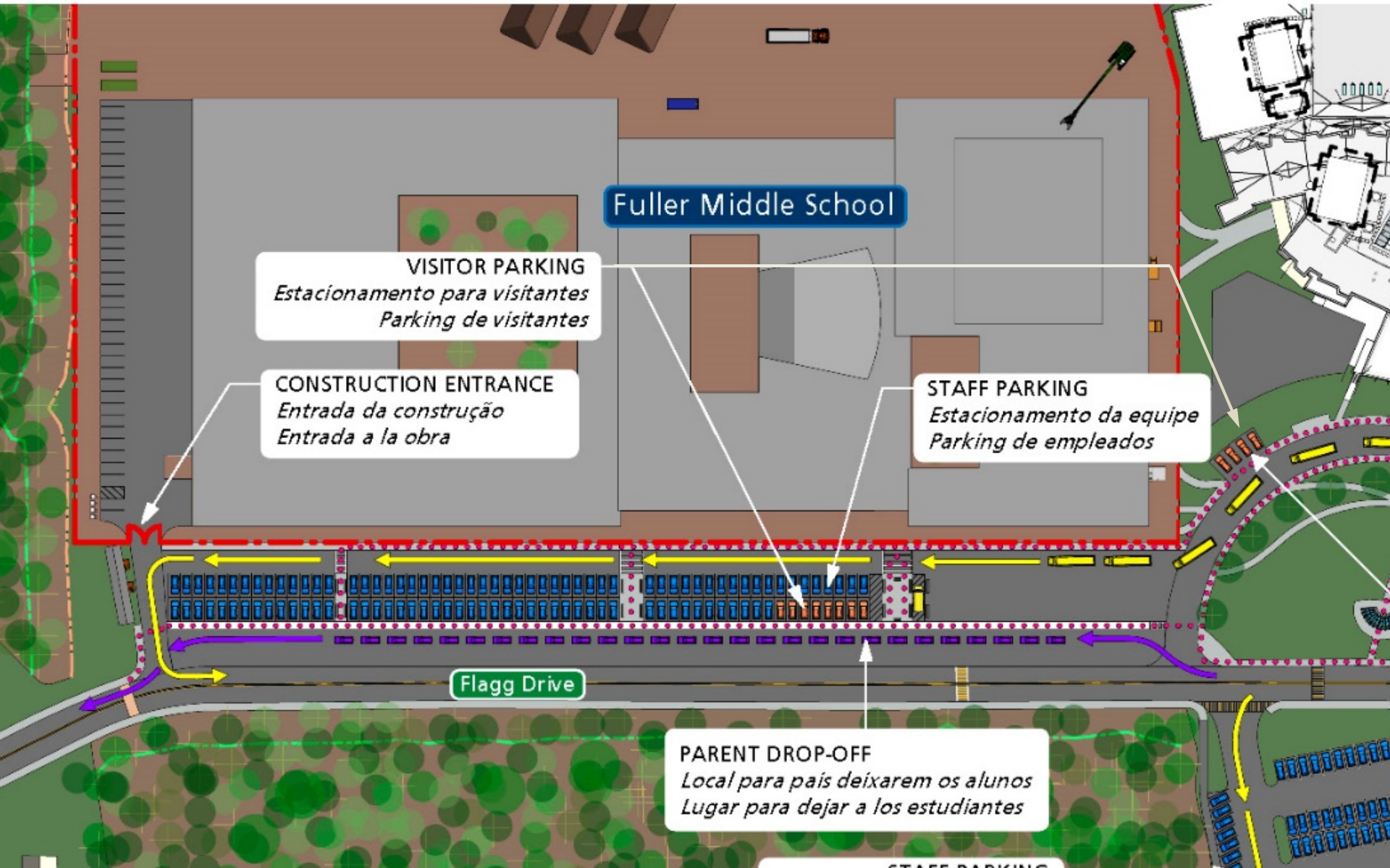



# Phase 3 Site Plan

**Phase 3 Parking  
Demolition  
Fall 2021 to Winter 2021**

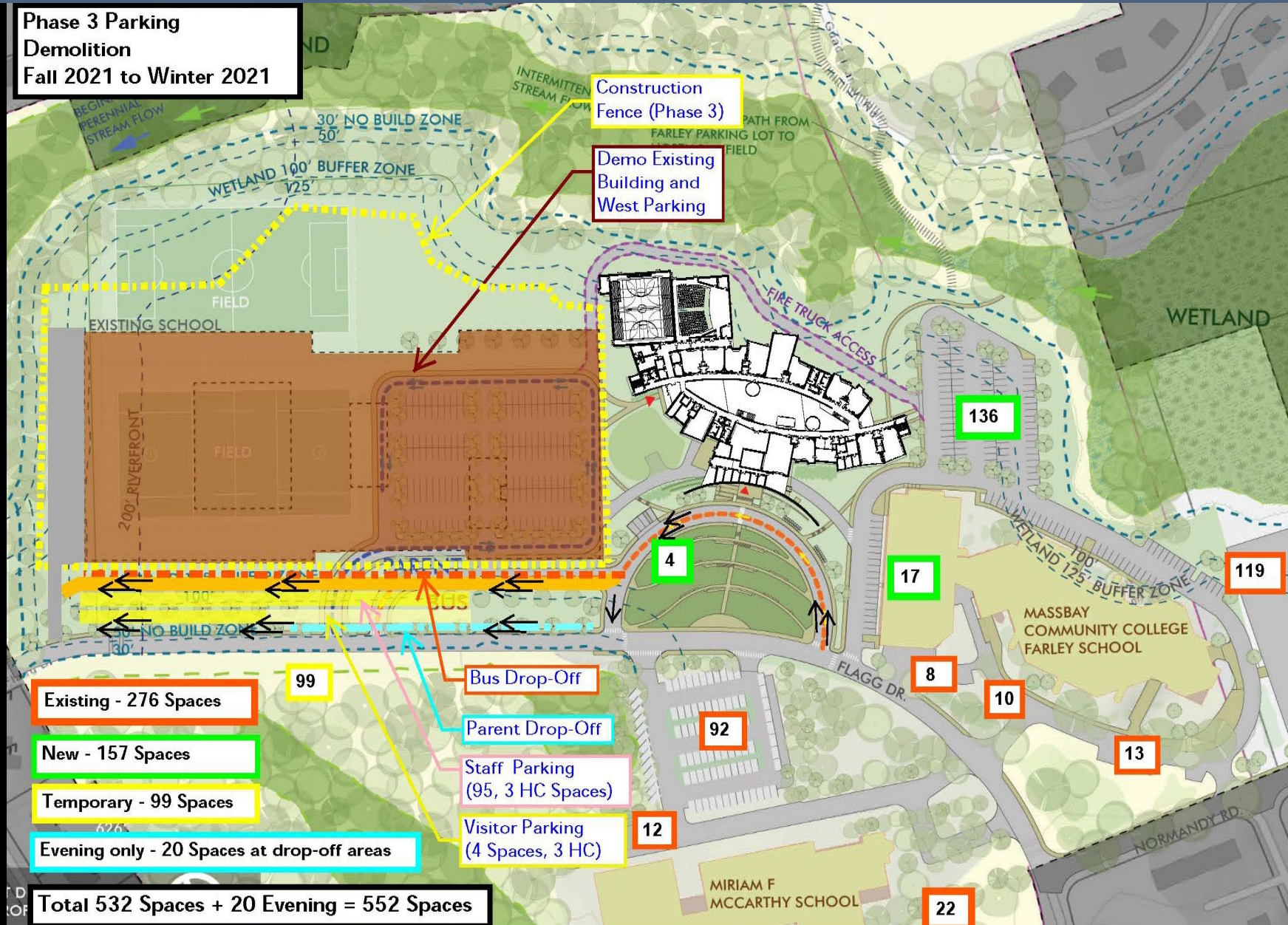

**Existing - 276 Spaces**

**New - 157 Spaces**

**Temporary - 99 Spaces**

**Evening only - 20 Spaces at drop-off areas**

**Bus Drop-Off**

**Parent Drop-Off**

**Staff Parking  
(95, 3 HC Spaces)**

**Visitor Parking  
(4 Spaces, 3 HC)**

**Total 532 Spaces + 20 Evening = 552 Spaces**



# Post Construction Site Plan

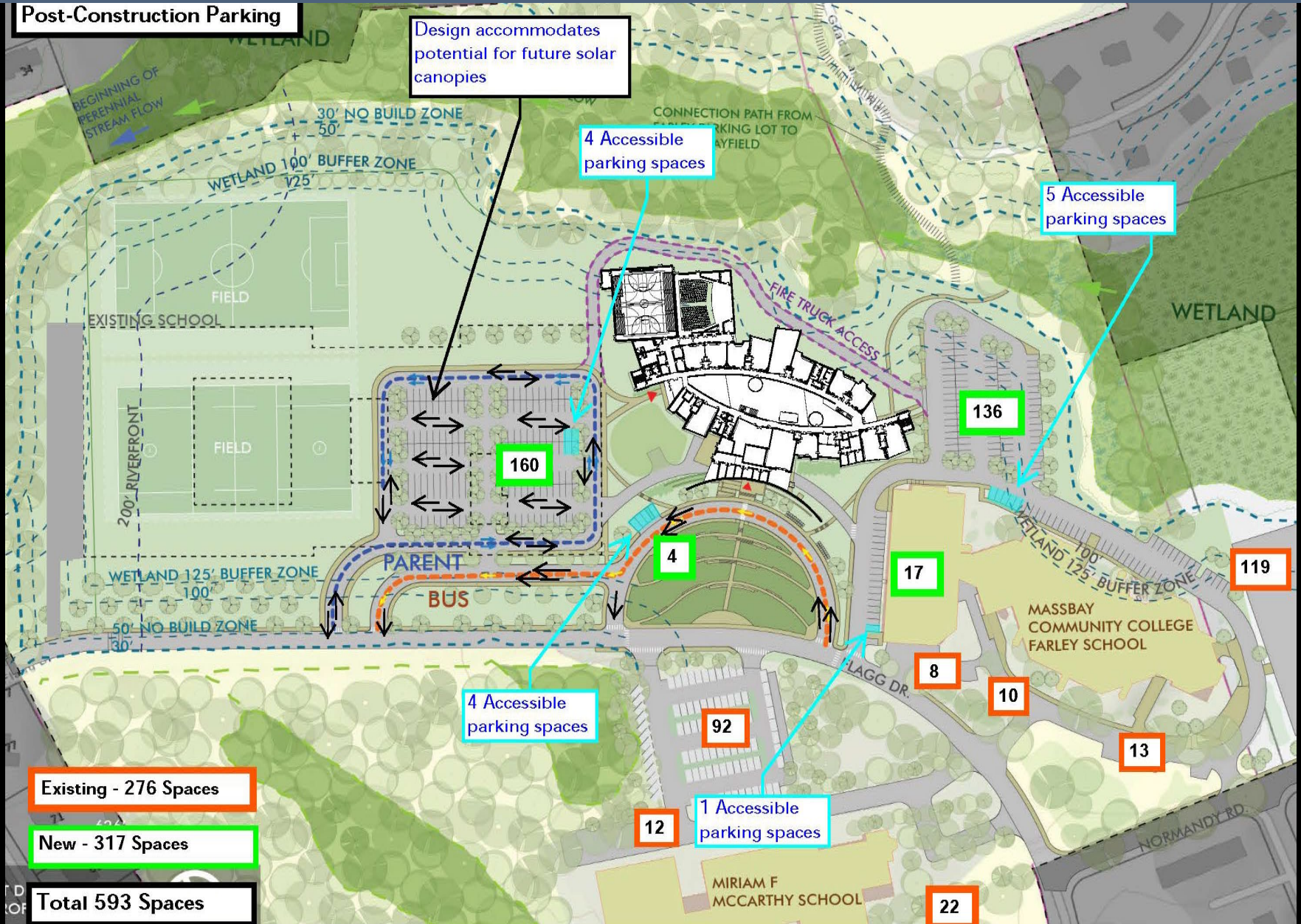

# Questions