

FULLER MIDDLE SCHOOL FEASIBILITY STUDY

School Building Committee Meeting
January 7, 2019

Elevator Count

Elevator Count

On November 28, 2018, the Framingham Disabilities Commission requested that the City consider adding a second elevator to the new Fuller School for redundancy and shortened travel distance.

Background Information

- Current design, approved by MSBA and DESE, includes one elevator.
- Current design meets all applicable building and accessibility code requirements.
- Typical access into a Middle School elevator requires use of a school-issued security card for access.

FIRST FLOOR PLAN

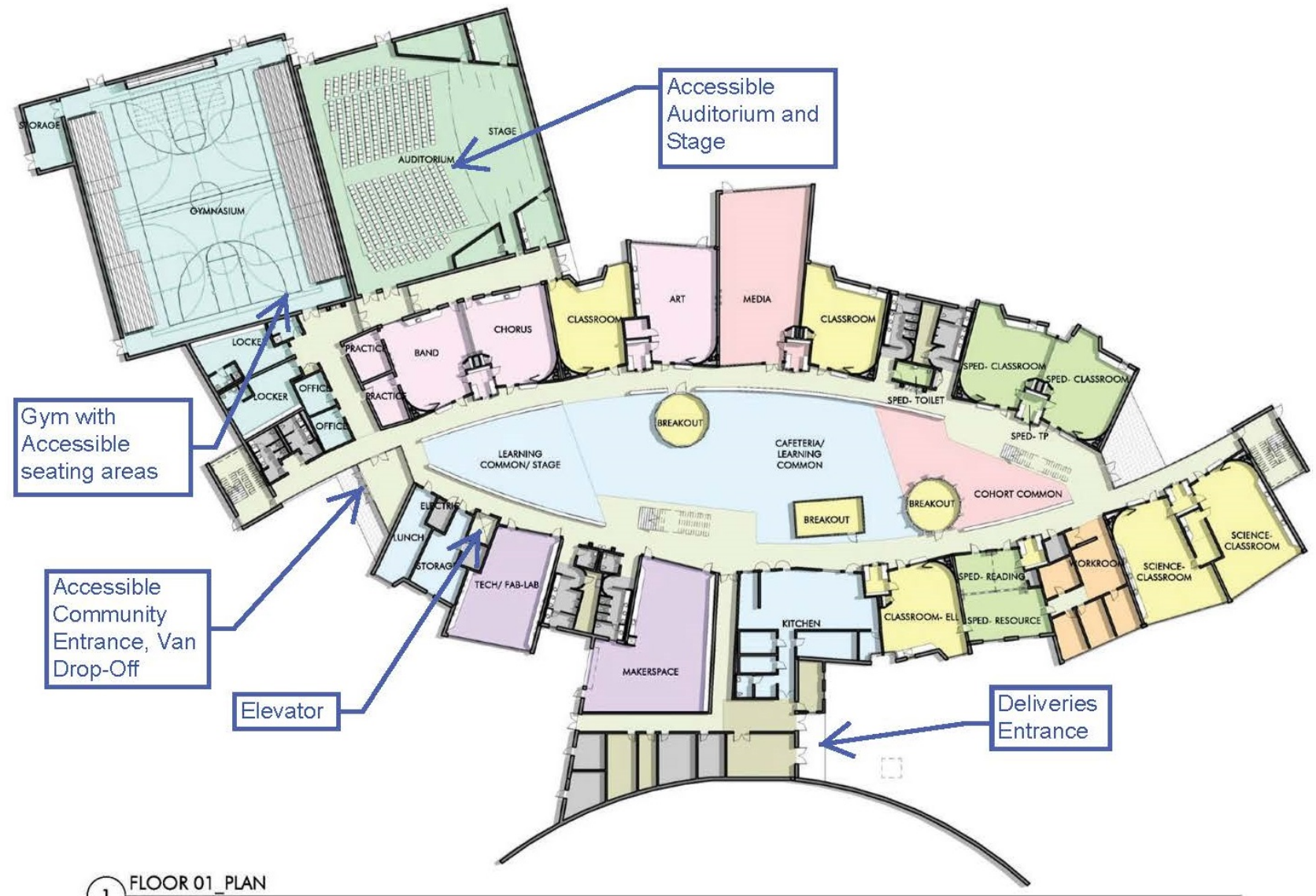

SECOND FLOOR PLAN



Elevator

Accessible School Entrance

THIRD FLOOR PLAN

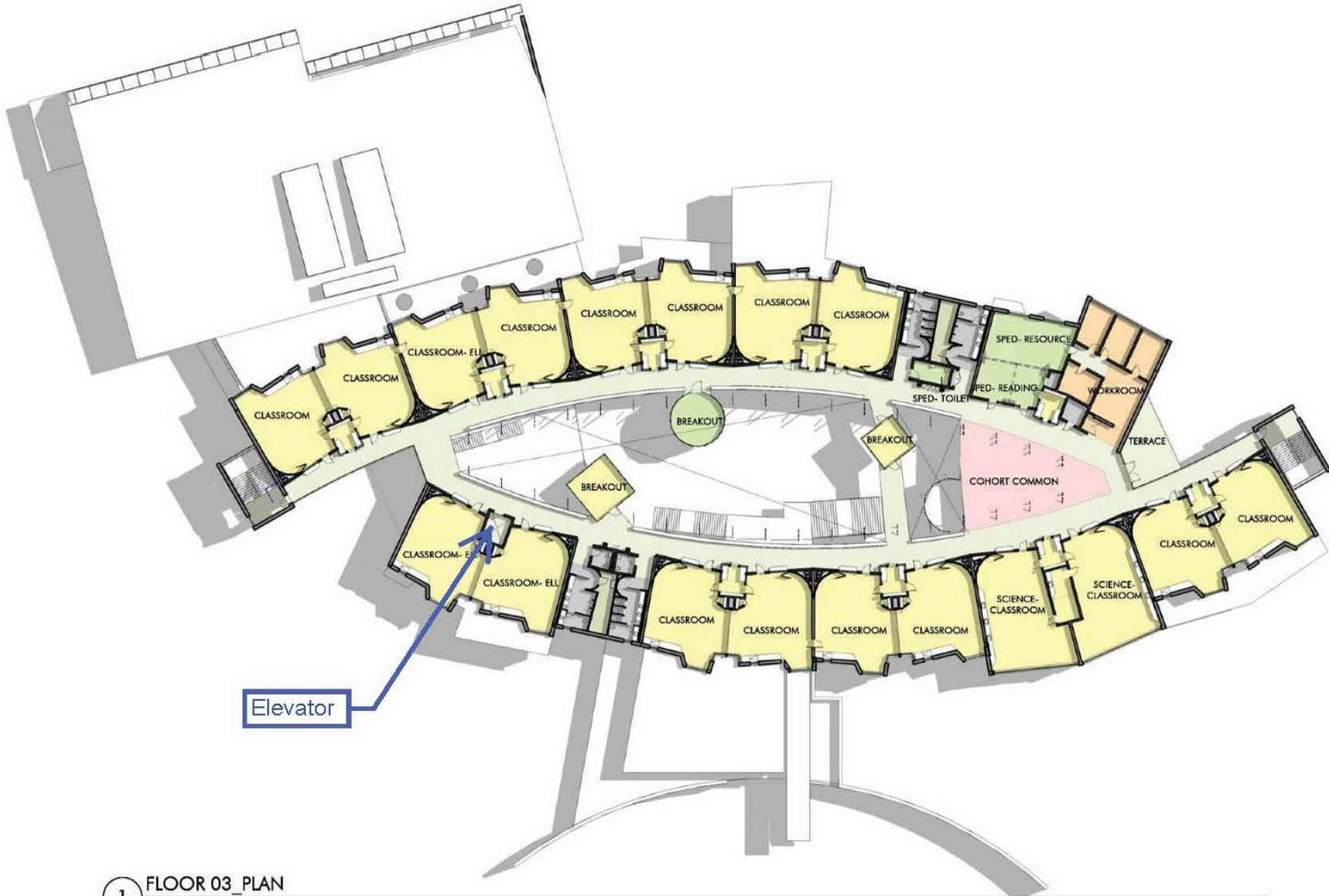

1 FLOOR 03_PLAN
1/32" = 1'-0"

Length of Travel Comparison

	Entry to Most Remote Room, Using Elevator	Maximum Room-to-Room Distance, Using Elevator
Fuller SD Design 1 Elevator	320 ft	540 ft
Existing Fuller	650 ft	780 ft
Woodrow Wilson	510 ft	1,010 ft
Cameron	375 ft	710 ft

Cost Impacts

- An additional elevator would have a construction cost of approximately \$350,000.
- The additional elevator would incur ongoing maintenance and operation costs.

All MSBA Schools Listed on Website Currently in Design or Construction

School	Design Enrollment	Passenger Elevators
Hannigan School, New Bedford	400 Students	1
Wyman Elementary School, Woburn	410 Students	1
Sterling Middle School, Quincy	430 Students	1
Peebles Elementary School, Bourne	460 Students	1
Sylvester Elementary School, Hanover	560 Students	1
Templeton Center School, Narragansett	580 Students	1
Richer Elementary School, Marlborough	610 Students	1
Hastings Elementary School, Lexington	645 Students	1
Gates Intermediate School, Scituate	720 Students	1
Carver Elementary School, Carver	750 Students	1
Mountview Middle School, Wachusett	800 Students	1
North Middlesex High School, Townsend	870 Students	1

Framingham School Experience to Date with Single Elevator, including Emergency Procedures

- Operations and Maintenance
- School Department

