

Edgewood and Spencer Butte Sidewalk Upgrade Project

ADDENDUM NO 2

December 13, 2021

This addendum is being issued for clarification and/ or revision of the Contract Documents as noted. This document is hereby made a part of the Contract Documents to the extent as though it was originally included herein.

Bidder shall notify all sub-bidders of this addendum, and shall acknowledge receipt of this addendum by inserting the above addendum number in the space provided on the bid form prior to submitting bids. Failure to acknowledge receipt of any addendum will subject the bidder to disqualification.

The following are clarifications to the Contract Documents:

Item	Reference	Description
1.00	Revised Edgewood and Spencer Butte Drawings	Revisions to Drawing A-2. Replace Drawing.
1.01	Revised Edgewood and Spencer Butte Drawings	Added Drawing A-6.
1.02	Bid time Change	Bids are now due at 3:00 PM and first tier at 5:00 PM

END OF ADDENDUM NO. 2

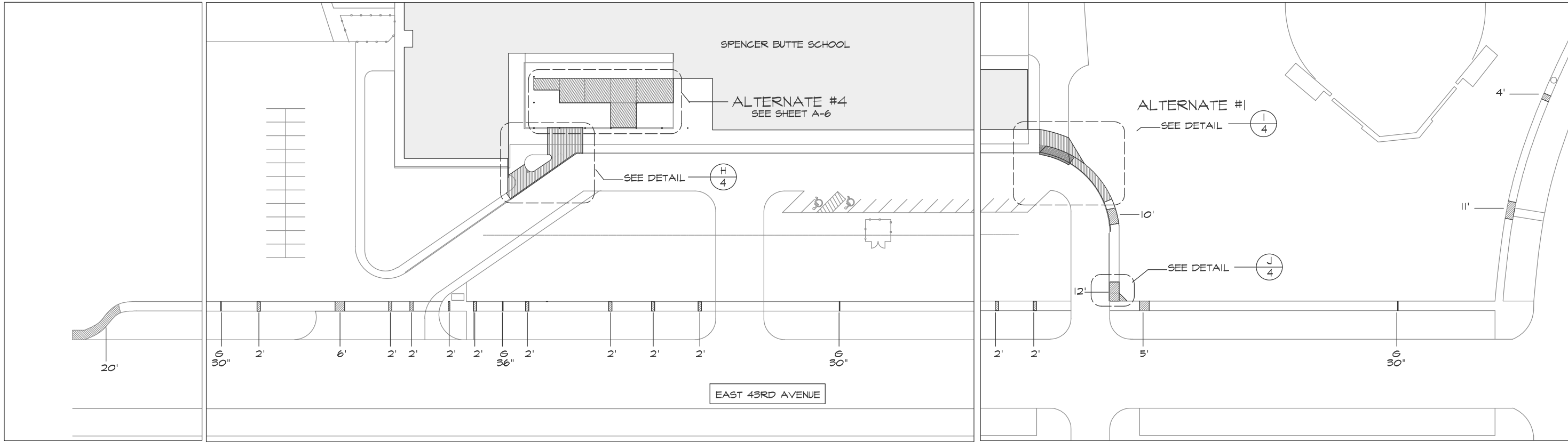

(A) SITE DETAIL
SCALE: - 1/64"=1'-0"

(B) SITE DETAIL

(C) SITE DETAIL

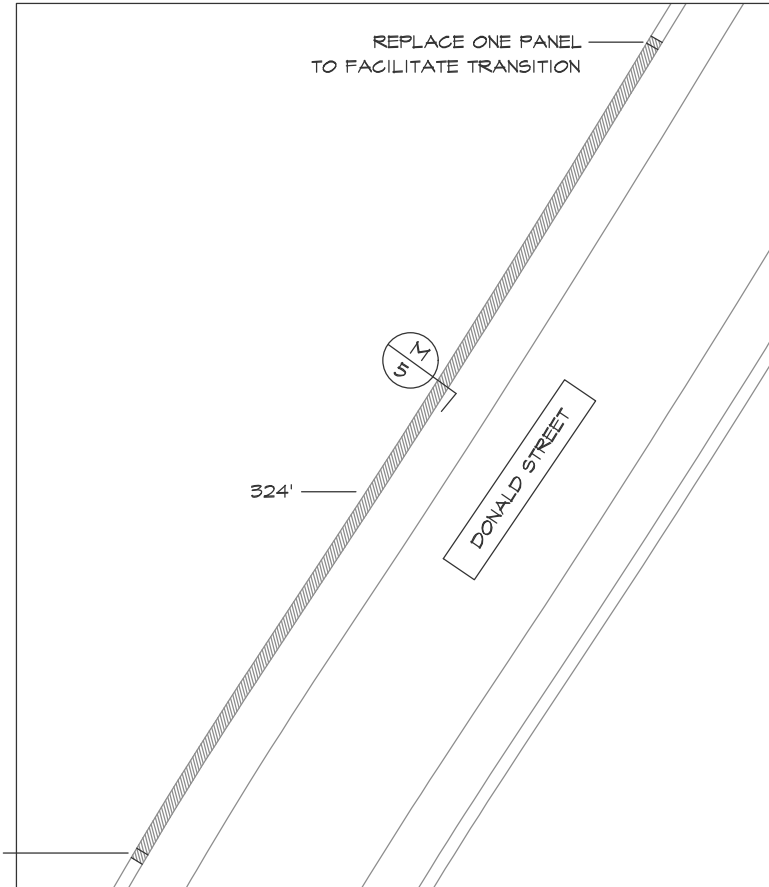

(D) SITE DETAIL

NOTE:
G = GRIND RAISED EDGE, LENGTH OF GRIND IS INDICATED

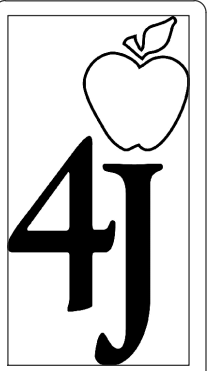

Facilities Management
School District 4J
715 W. 4th Avenue
Eugene, OR 97402
(541) 790-7400

EDGEWOOD AND SPENCER BUTTE
SIDEWALK REPAIR FIP 21911

DATE: 12-1-2021
REV: 12-13-2021

DRAWN BY B. MARTIN

SHEET
A=2

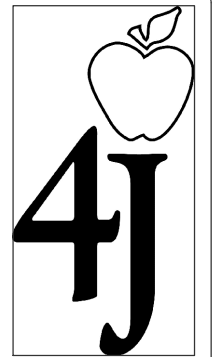

Facilities Management
 School District 4J
 715 W. 4th Avenue
 Eugene, OR 97402
 (541) 790-7400

EDGEWOOD AND SPENCER BUTTE
 SIDEWALK REPAIR FIP 21911

DATE: 12-13-2021
 REV: -

DRAWN BY B. MARTIN

SHEET

A=6

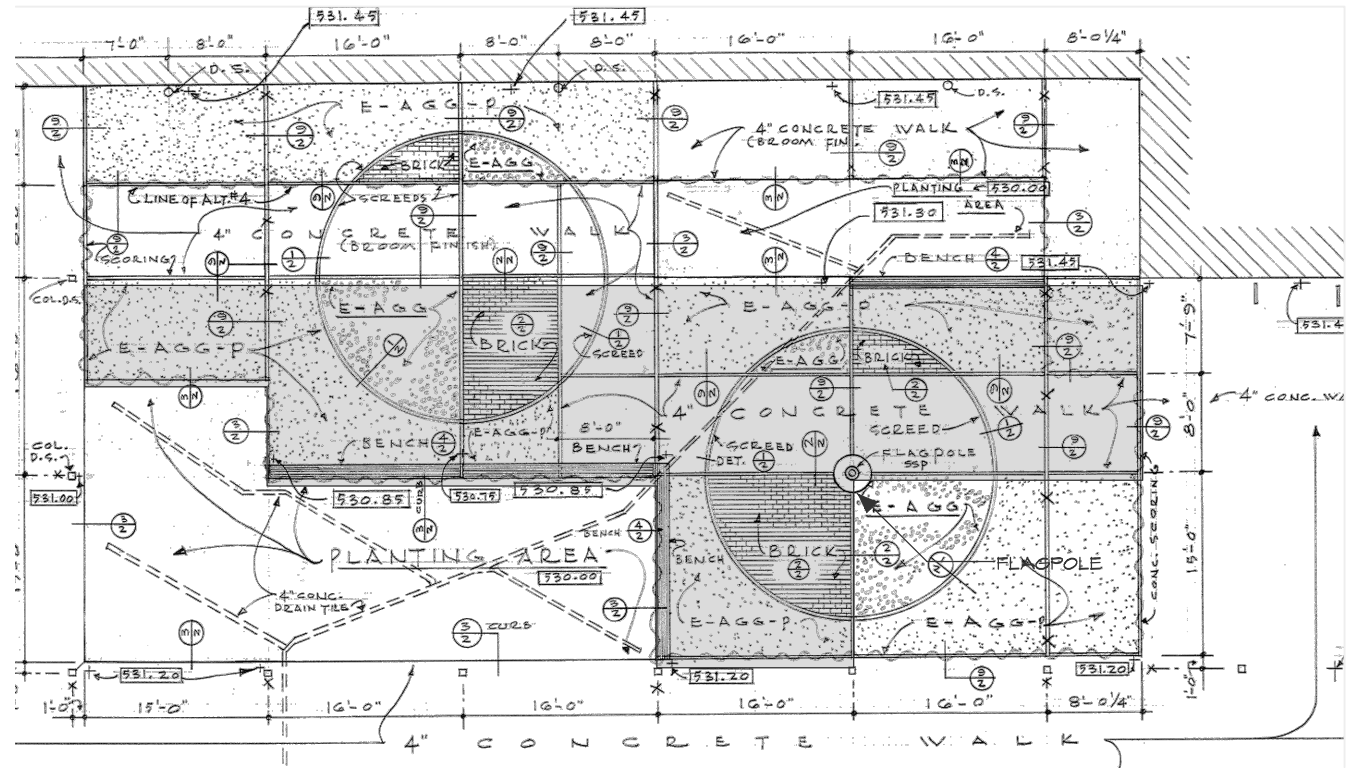

FRONT COURTYARD PLAN ALTERNATE #4
 SCALE: - 1/16"=1'-0" (DOES NOT REPLACE ANY BASE BID SCOPE)

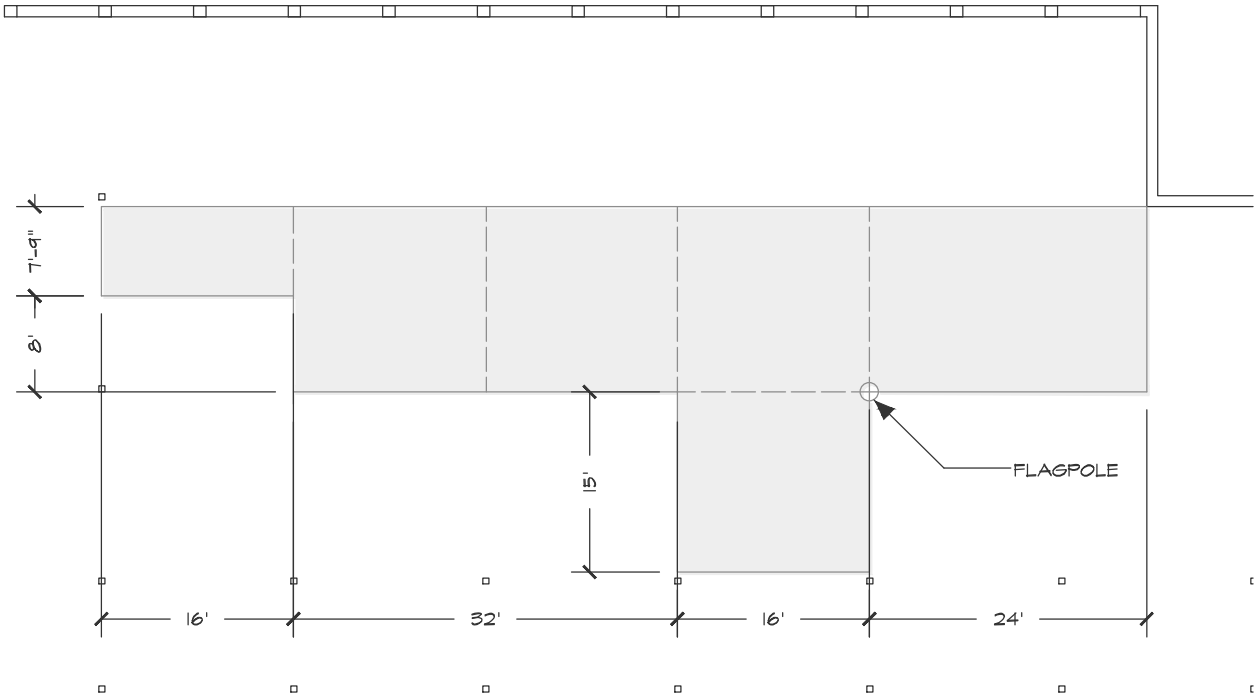

FRONT COURTYARD PLAN
 SCALE: - 1/16"=1'-0"

- ① REMOVE EXISTING PAVING AND REFRESH GRADE AS NEEDED.
- ② REMOVE ALL BENCHES, REINSTALL ON NEW PAVING WITH TITANS.
- ③ NEW CONCRETE TO BE 4" THICK, COMPRESSIVE STRENGTH TO BE 2500 PSI AT 28 DAYS.
- ④ NEW CONCRETE TO BE REINFORCED WITH #4 ASTM A-615 GRADE 60 REBAR, 16" ON CENTER EACH WAY, INSTALLED ON CHAIRS AND TIED AT ALL INTERSECTIONS.
- ⑤ SCORE JOINTS PER ACI 360R.
 ----- INDICATES COLD JOINT.