

ADDENDUM NUMBER ONE

November 17, 2020

This addendum is issued to clarify, change, and correct the Project Manual and Contract Documents and shall form a part of the Contract.

GENERAL –

1. A. It was asked if fingerprinting is required? Yes, since the work is inside, the background check and fingerprinting specified is required. Also asked was if there are any liquidated damages? Yes, damages will be \$100 per calendar day after final completion date.

B. The Substantial Completion date has been extended to Dec. 24, 2020. The Final Completion date is now Dec. 31.

C. A substitution request to include 'Ardex' with the listed grouting and setting materials has been approved for use.

DRAWINGS - Revise the following drawing notes:

1. **Sheet A3.1, Demolition Plan:**
A. The toilet and light fixtures, floor tile, and wall/ceiling finishes and insulation will all be removed by 4J asbestos abatement contractor. The Health room space will have exposed wood studs, ceiling joists, and a concrete floor. An as-built plumbing drawing is attached that shows a 2" sewer running beneath the shower area from the sink in the breakroom. It is the intent to only sawcut the shower area to connect the shower to this existing drain line. It is assumed that the new sink will drain into this line as well.
2. **Sheet A3.1, Floor Plan:**
A. Reference the 4J revised Floor Plan layout. Note that the restroom door location has moved. (There is also an existing floor drain next to the toilet that will remain.)

B. All new walls shown shall be 2x4 wood stud construction to match existing.

C. A portion of full ht. furred wall also needs to be added in order to reduce the distance from the wall to the toilet to be code.

D. The unfinished side of the existing cabinet is to get covered with a new finished wood panel to match the cabinet.
3. **Sheet A3.1, Reflected Ceiling Plan:**
A. Reference the 4J revised Ceiling layout. Note that it shows 2 waterproof LED 6" canless fixtures in the shower and 4 regular LED fixtures in the restroom. Lithonia ultra-thin or equal. The exhaust fan shall be Panasonic or equal installed on a curb up on the Built-up roof.

B. References to Owner furnished items has been revised. The owner will only furnish the Toilet room accessories for the Contractor to install. Everything else shown on the drawings will be furnished and installed by the Contractor.
4. **Sheet A8.1, Finish Schedule:**
A. Revise the Health rm finish schedule to patch back the FRP over gyp board inside the room where removed for construction. Also patch back the outside of the health room at the door as

2020 Fox Hollow Health Rm Renovation
Eugene School District 4J
CIP # 410.187.002

needed with gyp., base, and epoxy paint to match existing.

B. Interior elevation 2 and 4 show detail 16 at the tile drop at the shower. Provide a metal Schluter tile edge trim at the edge of the floor tile similar to the existing facilities shower.

5. **Sheet A8.1, Door schedule:**

A. The intent is to match the existing doors. Provide (2) 3'-0" x 6'-8" tall wood door in matching metal frames. For the health rm door, provide a half lite window in it with laminated safety glass to match the size of the adjacent Principal door. The restroom door shall be solid.

6. **Sheet A8.1, Hardware schedule:**

A. Re-use the existing hardware for the Health rm door, and provide a new Schlage ND70, Grade 1 cylindrical lock in matching style and finish for the restroom door. There are only hinges, doorstops, and locksets required for these doors.

SPECIFICATIONS - Revise the following specification notes:

1. **Quotation Form, Section 00 30 00:**

A. Under Alternate 1, Provide an alternate deduct price to have 4J perform the VCT patch-back at the Health room door and the new restroom door/wall.

2. **Tiling, Section 09 30 00:**

A. The ceramic tile types shown at the end of the section are only examples from our restroom at 4J. Submit actual sample tile boards to select final tile colors based on this basis of design.

3. **Plumbing Fixtures, Section 22 42 00:**

A. For the shower use Kohler Hand Held Shower K-10286-SN / K-349-SN / K-355-SN / K-8524-SN / K-8593-SN / K-T10940-4 : Kohler Shower K-10282 / K-T10940-4.

ATTACHMENTS:

1. Pre-Bid Sign Up Sheets.
2. 4J Revised Floor Plan Layout.
3. 4J Revised Reflected Ceiling Plan Layout.
4. 4J Existing Plumbing as-built showing existing drain line.

Michael Heffernan, AIA

END OF ADDENDUM NUMBER ONE

Pre Bid Meeting		
Project: FOX HOLLOW ELEMENTARY Health Restroom renovation		
Date: 11/12/20, 2pm		

PLEASE PRINT THIS INFORMATION

Name	Company Name	E-Mail	Address
Kirk Miller	Preferred Const.	timk@BuildwithPa.com	
Adam Alexander	Bineham const. inc.	adam.alexander@BinehamConstruction.com	
Jodi Arend	Bineham Construction, Inc.	jodiarend@binehamconstruction.com	
Gerry Bush	Twin Rivers Plumbing	gerry@twiriversPlumbing	
DOUG JOST	2G CONSTRUCTION	djost@2gconstruction.com	

Pre Bid Meeting			
Project: FOX HOLLOW ELEMENTARY Health Restroom renovation			
Date: 11/12/20, 2pm			
PLEASE PRINT THIS INFORMATION			
Name	Company Name	E-Mail	Address
J. Valencia	Bridgeway Contracting		Lowell
Bob Buss	"	bobb@bridgewaycontracting.com	Lowell
Jerod Parks	Hermanson	JParks@Hermanson.com	Eugene
Shawn Connell	Ryan Thomas Construction	Ryan@rthomasconstruction.com	Coburg
Brad Anderson	Dorman Construction	brad@dormanconstruction.com	Springfield
WADE COHN	KEVIN COHEN	Wade@KevinCohenplumbing.com	EUGENE
NITAI STEIN	ORDELL CONSTRUCTION LLC	nstein@ordellconstruction.com	EUGENE

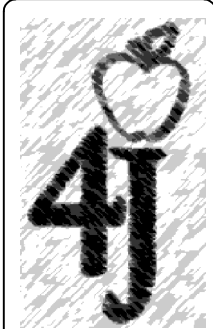

Facilities Management
 School District 4J
 715 W. 4th Avenue
 Eugene, OR 97402
 (541) 790-7400

FOX HOLLOW ELEMENTARY SCHOOL
 HEALTH RESTROOM RENOVATION
 5055 MAHALO DRIVE

DATE: 11/17/20

DRAWN: M. HEFFERNAN

SHEET
 FP

PATCH EXIST GYP., BASE,
 & PAINT AT EXIST. WALL

EXISTING CABINET AND SINK

LOWER EXISTING POWER

NEW TOILET IN EXIST LOC.

NEW 3' DOOR

PROVIDE FINISHED WOOD
 SIDE PANEL AT CABINET.

PATCH EXIST VCT, GYP., BASE,
 & FRP AT EXIST. WALL.

HEALTH ROOM

PRINCIPAL

COAT HOOK

DOOR STOP

STROBE

RESTROOM

NEW 3' DOOR

18"

EXIST. F.D.

TOILET PAPER

TAMPON DISPENSOR/DISPOSAL

BREAK ROOM

PAPER TOWEL

LOWER EXIST POWER

NEW SINK / MIRROR

SOAP

PATCH EXIST VCT,
 CEILING TILE, & FRP
 AND BASE AT NEW WALL.

4'-0"

42" DEEP SHOWER

CONTROLS
 FIXED SHW.

CONTROLS
 HAND HELD SHOWER

CURTAIN

EXIST. SINK AND DISHWASHER

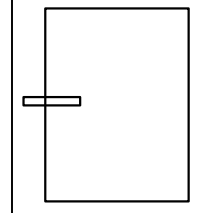

FLOOR PLAN
 SCALE: 1/2"=1'-0"



Facilities Management
 School District 4J
 715 W. 4th Avenue
 Eugene, OR 97402
 (541) 790-7400

FOX HOLLOW ELEMENTARY SCHOOL
 HEALTH RESTROOM RENOVATION
 5055 MAHALO DRIVE

DATE: 11/16/20

DRAWN: M. HEFFERNAN

SHEET
 RCP

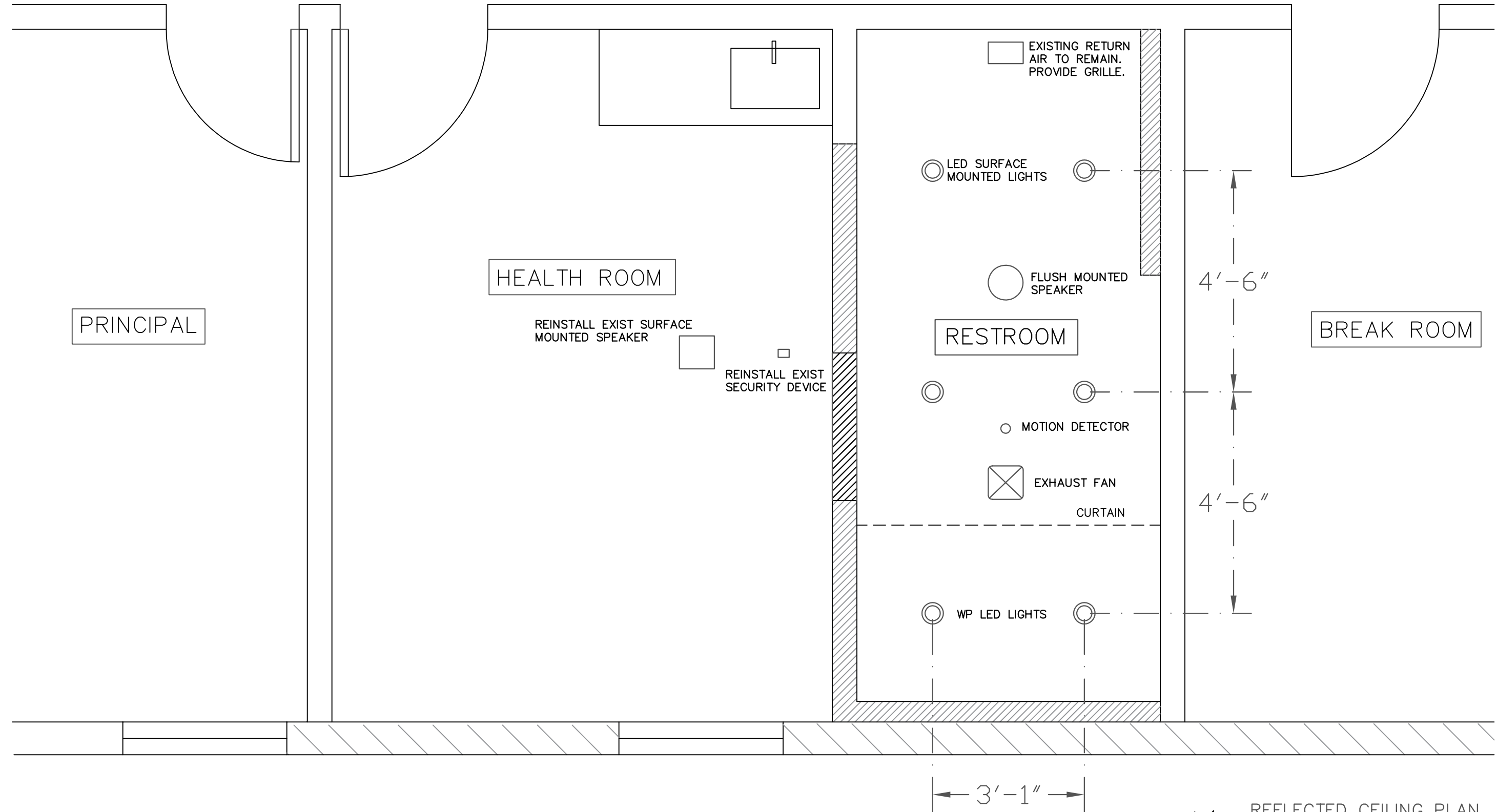

REFLECTED CEILING PLAN
 SCALE: 1/2"=1'-0"

Fox Hollow Health Room - Existing Plumbing

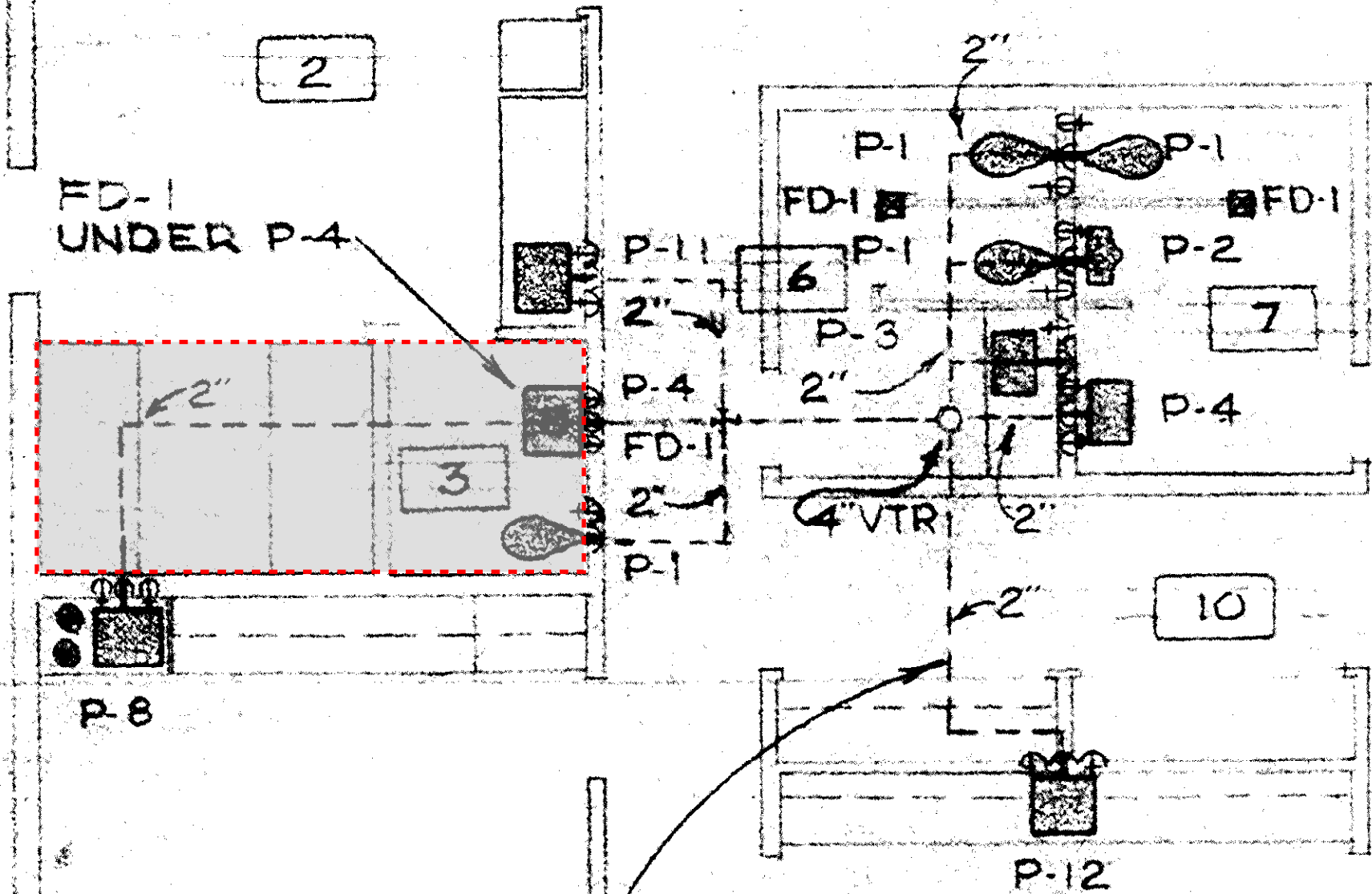

VENT PIPE IN
FURRED DOWN CEILING
SEE ARCHTL.