



NORTH EUGENE HIGH SCHOOL

Eugene School District 4J

Schematic Design Update

21 January 2020
PUBLIC MEETING

AGENDA

- Schedule
- Engagement
- Design Progress

ENGAGEMENT PROCESS and PLANNING: So Far

TIMELINE

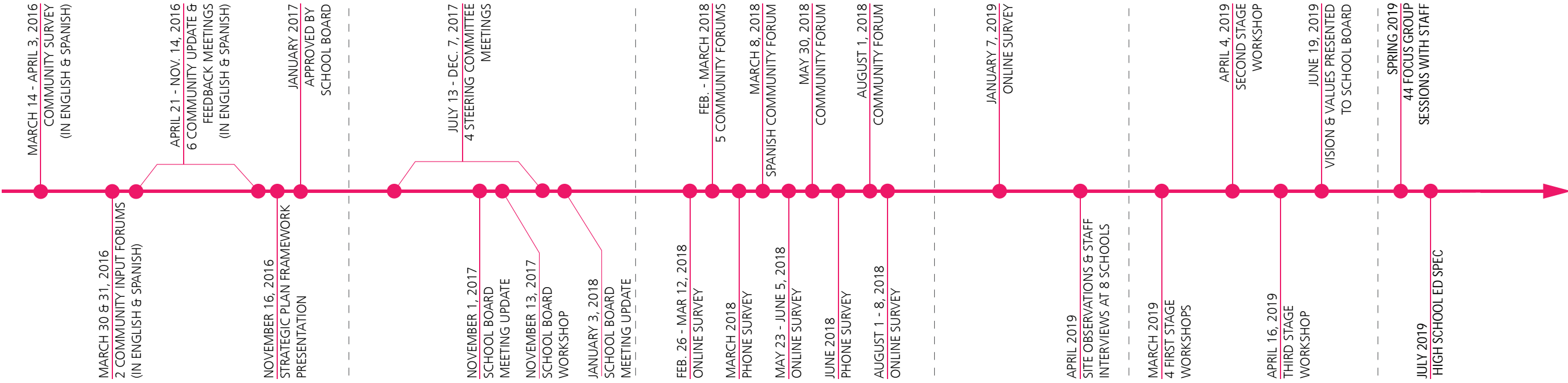

4J Vision 20/20 Strategic Plan



Long-Range Facilities Plan



Bond Measure Planning



Facility User Experience Study



School Design Vision & Values



High School Educational Specifications



HIGH SCHOOL EDUCATION SPECIFICATIONS
 EUGENE SCHOOL DISTRICT 4J
 EUGENE, OREGON

© 2019 MAHLUM ARCHITECTS

PROJECT SCHEDULE



DESIGN PROCESS - Considerations for Evaluation

WAYFINDING | CIRCULATION

Site

- **Clarity of site circulation - Traffic/Pedestrian/Bike safety**
- Clarity of Front Door and other entries
- Location and entry for Preschool and Community Clinic

Building

- **Interior Wayfinding: Internal visual connections, Understanding the whole**
- Minimize dead ends and long paths, Relief of long hallways
- **Commons integral with circulation and centrally located**
- Crowd management for Theater and Gym events, and After-hours partitioning

NEIGHBORHOOD | COMMUNITY IMPACT

- **Sensitivity to single-family neighbors: Setback, Scale, Screening, Noise, Traffic**
- Connection / Visibility of activity within the school
- Identity from Silver Lane (Public Face)
- Community Resource: Meeting space, Clinic, Preschool

QUALITY OF DESIGN & ENVIRONMENT

- Placement of Trees: Screening, wayfinding, scale
- **Usable, Quality Outdoor Space: extension of indoor activities, sun access**
- Natural Light Access: Calibrate quality/quantity, control, variety
- Balance between simplicity and variety of experience

COST DRIVERS

- **Overall layout and massing efficiency**
- Skin to volume ratio
- Large building massing: Cohesive vs. Articulated
- Immediate Occupancy Zone: Consolidation
- Adaptability, Flexibility, Expansion capability

OPERATIONS | MAINTENANCE | SECURITY

- **Discreet Service: Minimize public view, Operationally shielded from school activity**
- **Safety: Minimize hiding spots / Maximize visible monitoring of site and building**
- Proper distribution of building support functions (restrooms, custodial, IT, etc.)
- Respond to climate to reduce energy use: Building orientation, shading.

SITE CONSIDERATIONS

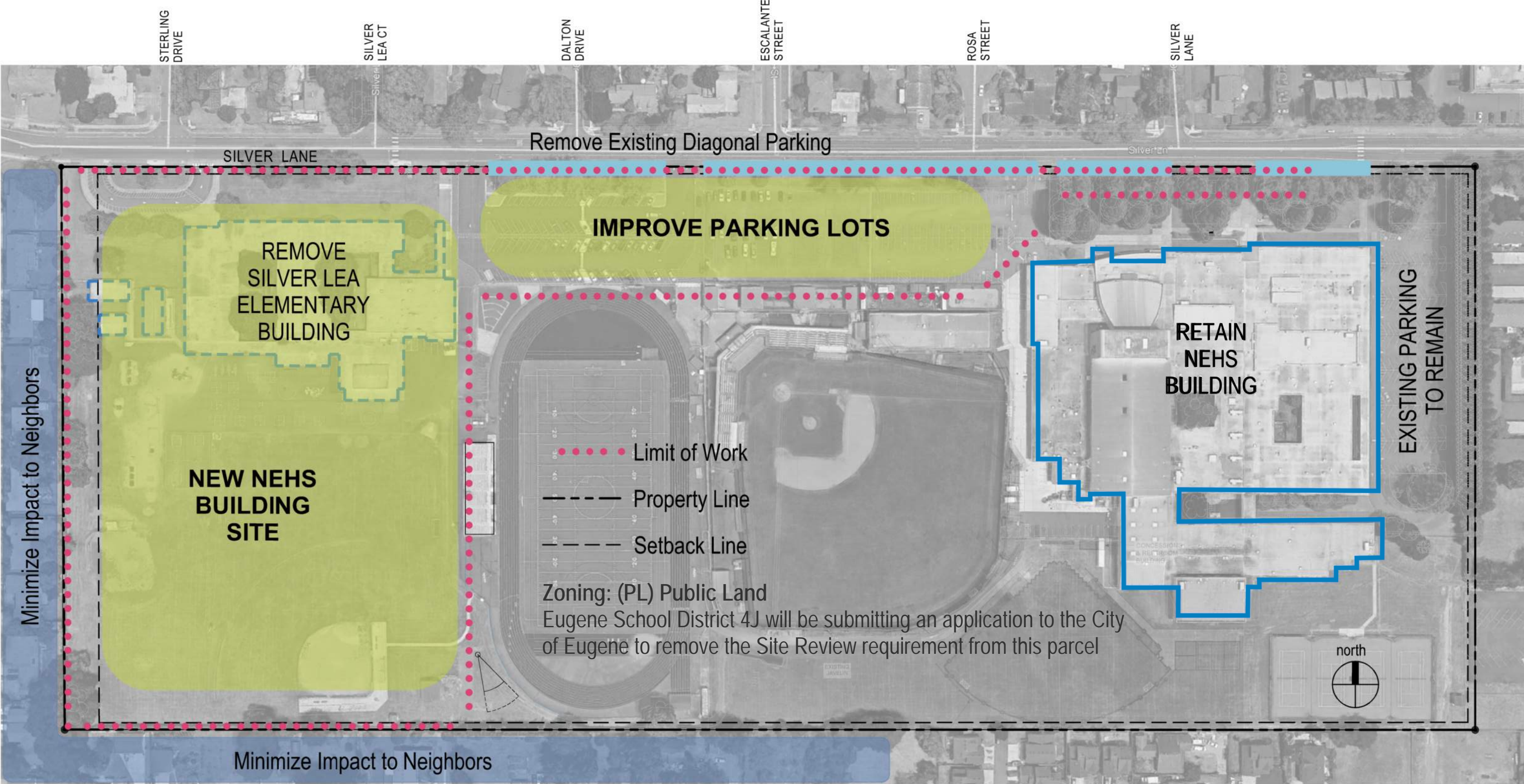

SITE PLAN CONCEPT

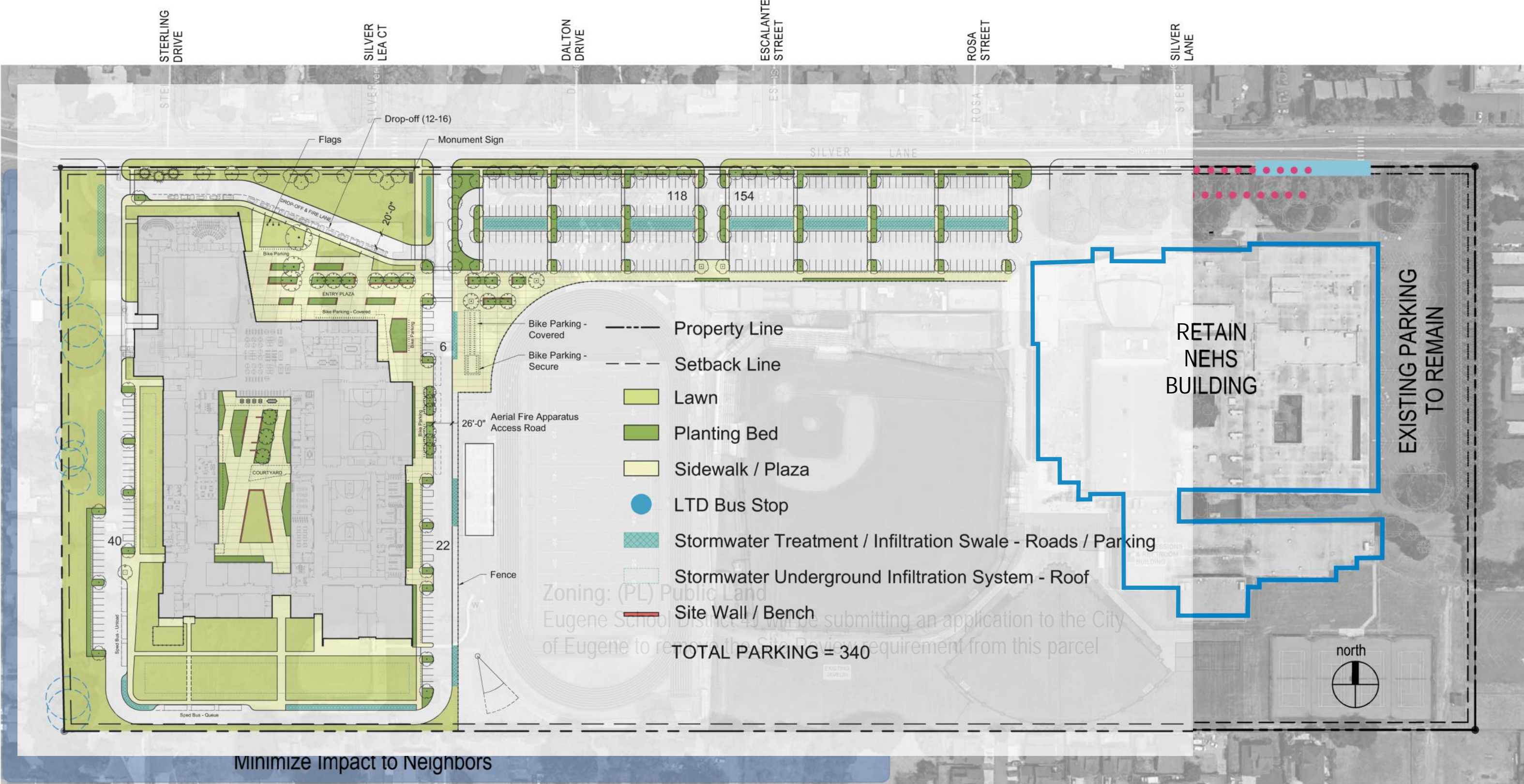

DESIGN PROCESS - Concept Options

N-S BAR 1.0

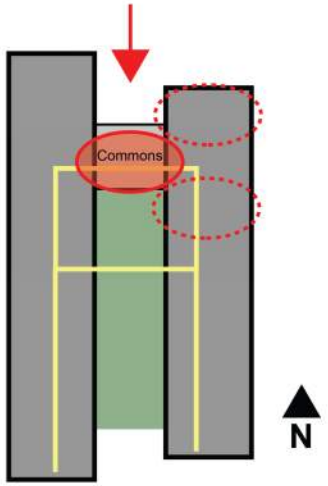

WHEEL 2.0

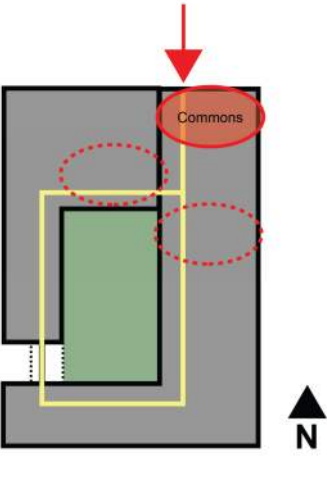

E-W BAR 3.0

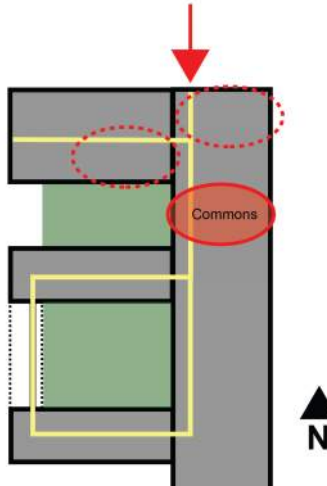

HYBRID 4.0

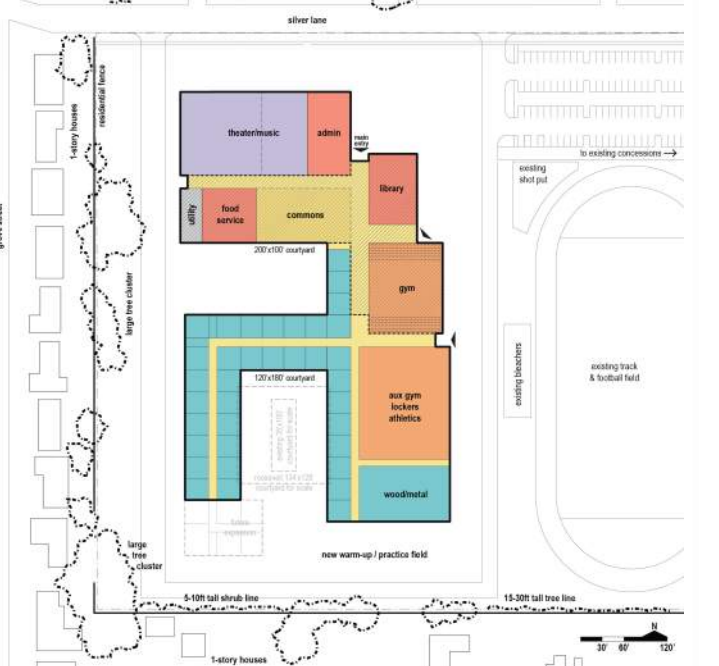
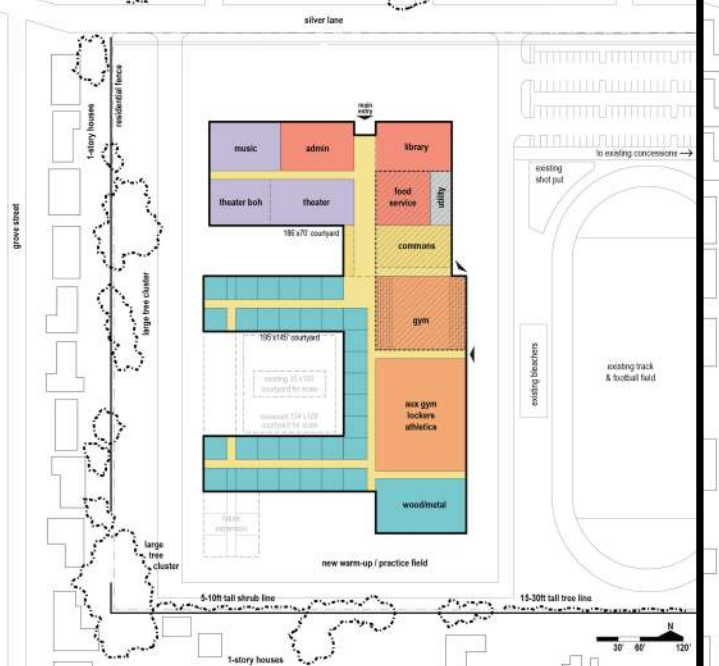
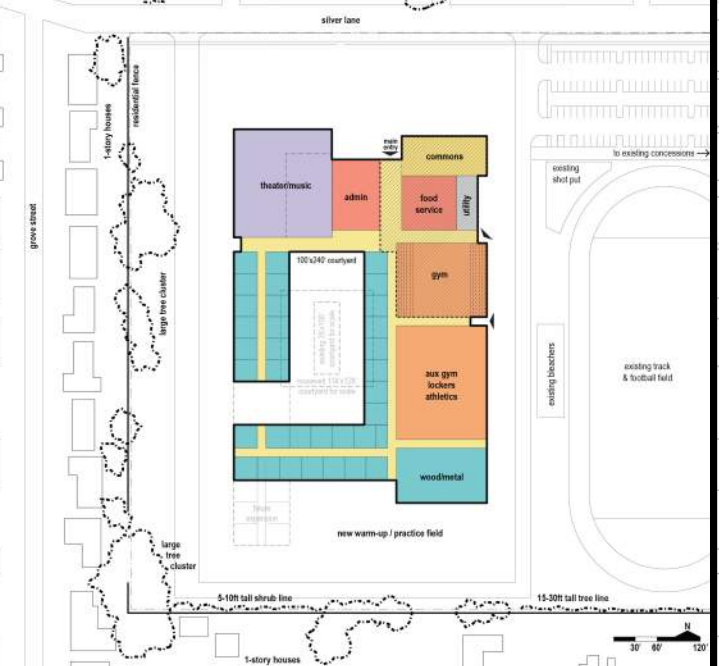
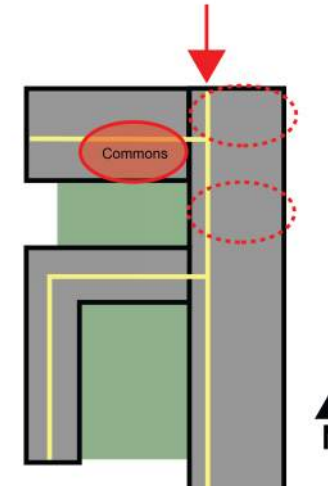

CONCEPT NOTES:

- elongated south facing courtyard
- west and east facing classrooms
- need to alleviate long hallways
- long building wall facing west neighbors

CONCEPT NOTES:

- consolidated overall building footprint
- single large courtyard
- north, south, west and east facing classrooms
- full loop circulation

CONCEPT NOTES:

- two west facing courtyards; different character for each
- north, south and west facing classrooms
- loop circulation in classroom zone
- minimizes building wall facing west neighbors

CONCEPT NOTES:

- west and south facing courtyards; different character for each
- north, south, west and east facing classrooms
- potential for loop circulation in classroom zone
- breaks up building wall facing west neighbors

DESIGN PROGRESS

DESIGN STUDIES:

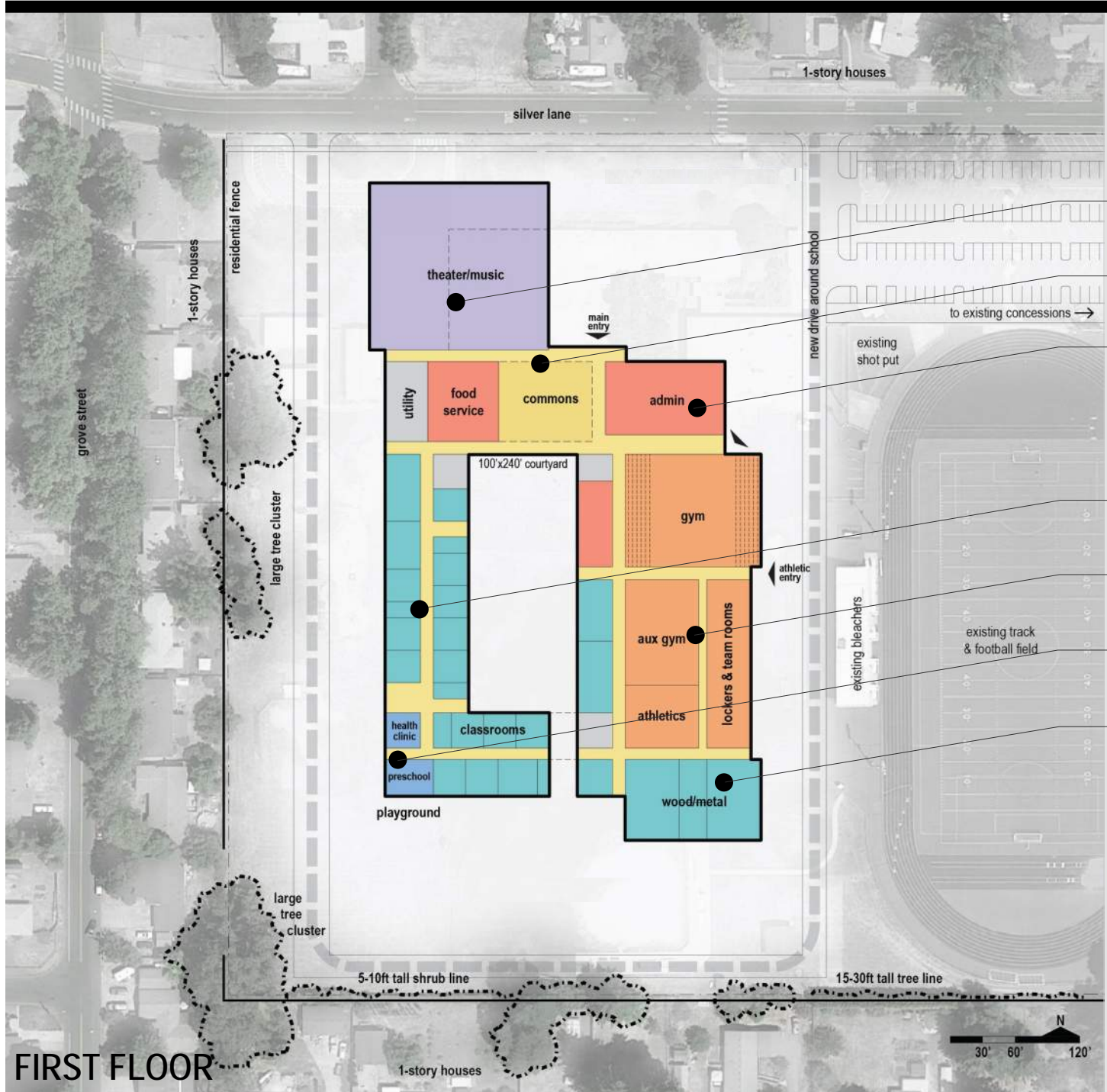
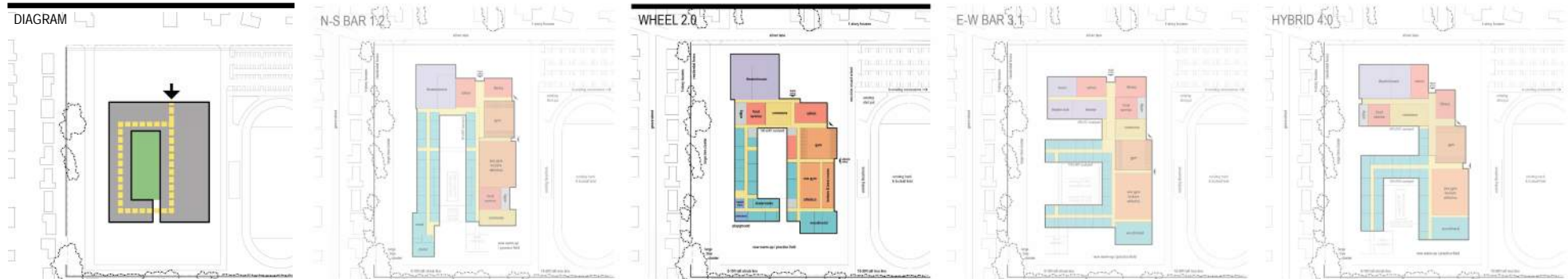

PROGRAM

1200 Students

Theater / Music

Commons

Administration

Library

Classrooms

PE / Athletics

Preschool / Clinic

CTE

- Manufacturing / Construction
- Culinary Arts
- Early Childhood Education
- Health Occupations
- Digital Design

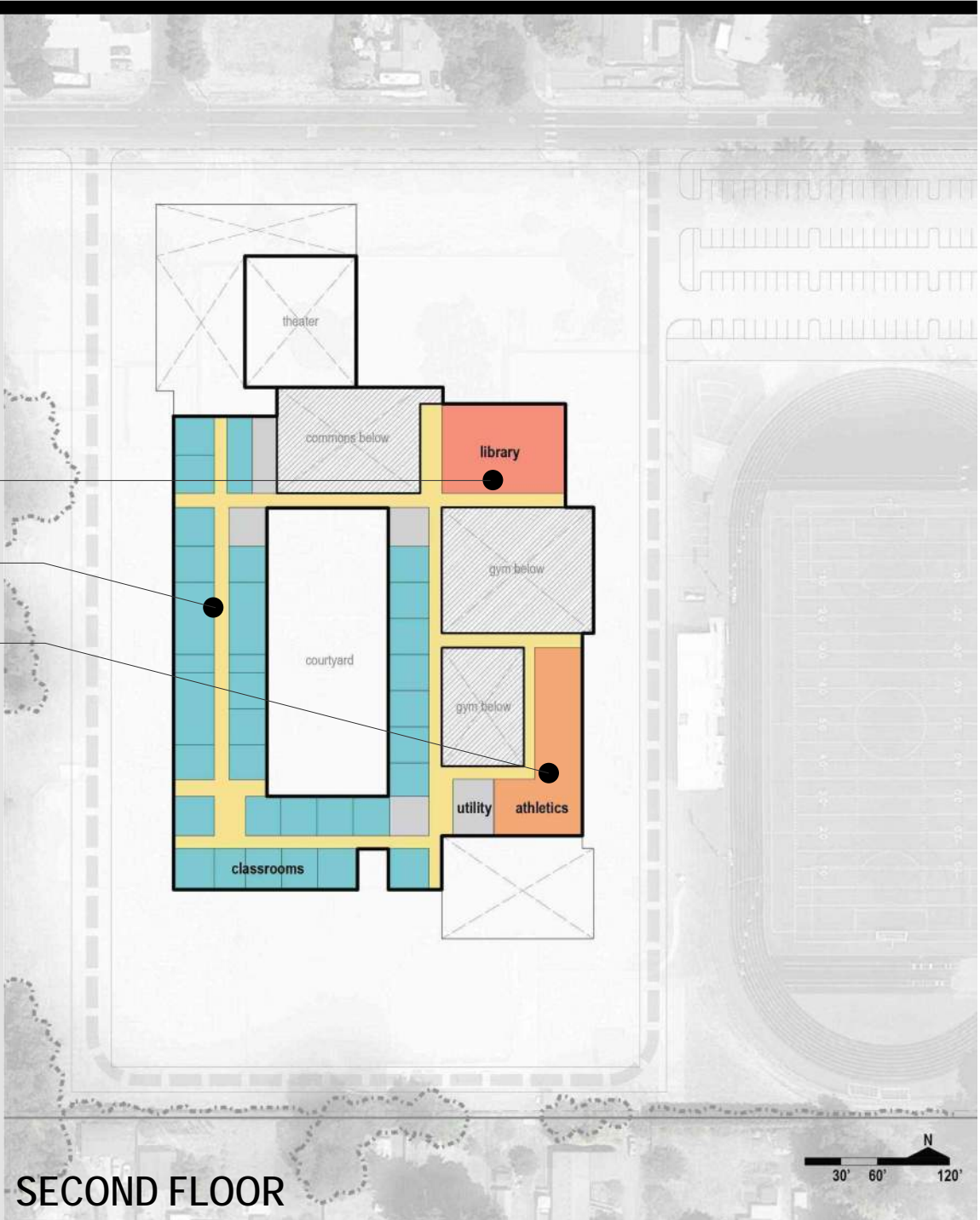

FIRST FLOOR

SECOND FLOOR

Public Meeting

21 January 2020

Thank You !