

General Notes:

1. The drawing is to be used for general information. Contractor to verify existing site conditions and classroom flooring dimensions.
2. Work to be conducted in accordance with all state and local fire codes.
3. Abatement Contractor to be responsible for cleaning or removing and possible disposal of any material that becomes contaminated during the course of asbestos abatement.
4. 2'x2' plastic viewing window to be installed to observe abatement.

Abatement Notes:

1. Contractor to remove all floor tile/mastic, cove base/mastic 3D as indicated on drawing.
2. Asbestos bag-out to be 2 chamber design, if used.
3. Contractor to build full negative pressure enclosure w/3 chamber decon. for friable removal.
4. Contractor to install and maintain a working manometer on the negative pressure enclosure. Containment negative pressure shall be maintained at a minimum of 0.02:" wg at all times during the abatement. Vent all hepa exhaust to the outside of building for "friable" removal.

Abatement Notes:



Indicates asbestos containing floor tile and non-asbestos floor tile mastic and associated cove base/mastic to be removed & replaced. 1,440 sq. ft. - Using "friable" methods, B-30



Indicates asbestos containing floor tile and non-asbestos floor tile mastic and associated cove base/mastic to be removed. 4J to replaced. 105 sq. ft. - Using "friable" methods B-29



Indicates asbestos containing floor tile and non-asbestos floor tile mastic and associated cove base/mastic to be removed. 4J to replaced. 44 sq. ft. - Using "non-friable" methods, B-19
24 sq. ft. - Using "non-friable" methods, B-18

Facilities Management
School District 4J
715 W. 4th Avenue
Eugene, OR 97402
(541) 790-7400

SHELDON HIGH SCHOOL
2455 WILLAKENZIE ROAD 97401-4898
541-790-6600

DATE: 02-22-19
DRAWN BY D. Lemonds

A-1

2/22/2019 10:14 AM W:\PLANS\Lemonds\SHS Rm B30

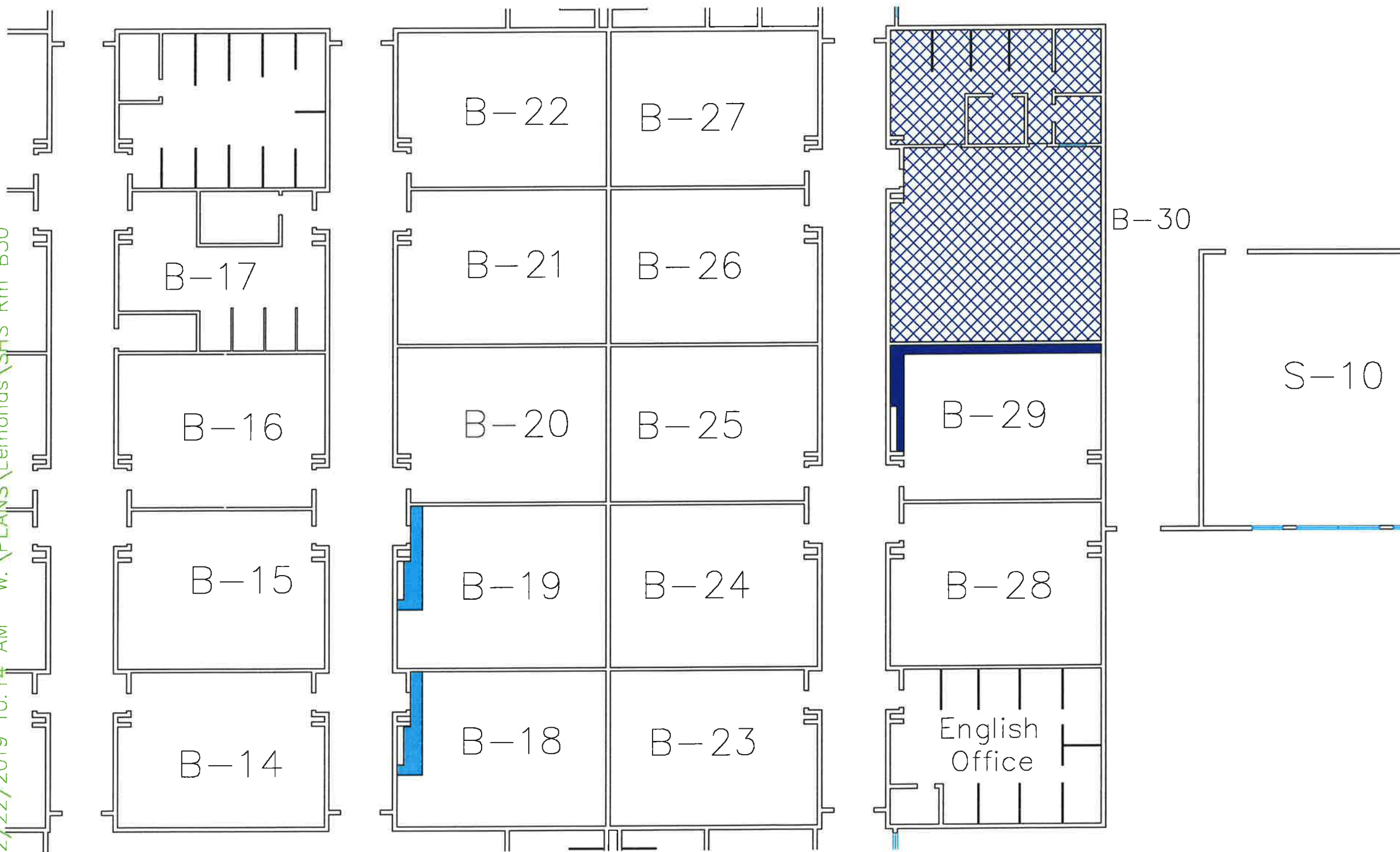

General Notes:

1. The drawing is to be used for general information. Contractor to verify existing site conditions and classroom flooring dimensions.
2. Work to be conducted in accordance with all state and local fire codes.
3. Abatement Contractor to be responsible for cleaning or removing and possible disposal of any material that becomes contaminated during the course of asbestos abatement.

Abatement Notes:



Indicates asbestos containing floor tile and non-asbestos floor tile mastic and associated cove base/mastic to be removed. 4J to replaced. 62 sq. ft. - Using "non-friable" methods, Girl's locker room storage.

Abatement Notes:

1. Contractor to remove all floor tile/mastic, cove base/mastic 3D as indicated on drawing using "non-friable" methods.

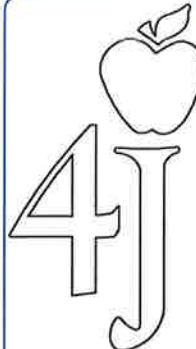

Facilities Management
School District 4J
715 W. 4th Avenue
Eugene, OR 97402
(541) 790-7400

SHELDON HIGH SCHOOL
2455 WILLAKENZIE ROAD 97401-4898
541-790-6600

DATE: 02-22-19
DRAWN BY D. Lemonds

A-2

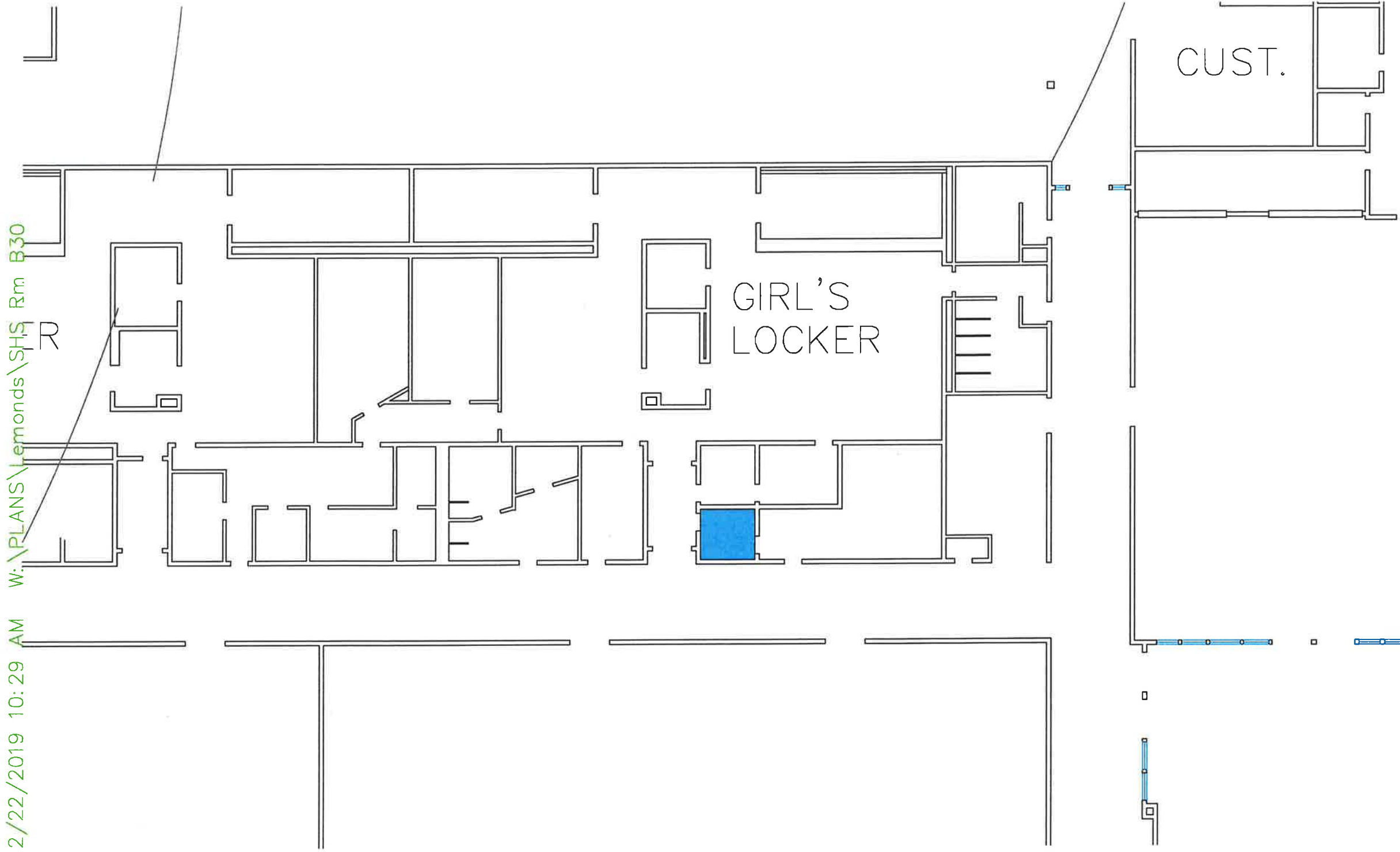

2/22/2019 10:29 AM W:\PLANS\Lemonds\SHS Rm B30

Base Quote: 12"x12" VCT INSTALLATION—CLASSROOM B-30

***ARMSTRONG—FLOORING



APPROX. QUANTITY, 1,440—CLASSIC WHITE, 51911 FIELD COLOR



APPROX. QUANTITY, 45—BASIL GREEN, 51947 SPOTTER COLOR



Facilities Management
School District 4J
715 W. 4th Avenue
Eugene, OR 97402
(541) 790-7400

2/22/2019 10:53 AM W:\PLANS\Lemonds\SHS Rm B30



SHELDON HIGH SCHOOL
2455 WILLAKENZIE ROAD 97401-4898
541-790-6600

DATE: 02-22-19

DRAWN BY D. Lemonds

A-3