

Addendum No. 2

Page 1 of 1
July 11, 2018



PROJECT: 1800107-Churchill HS Softball Field **INITIATOR:** Anna Backus
DATE: July 11, 2018 **GC:** TBD
BID ISSUE NO.: 2 **OWNER:** Eugene School District 4J

ITEM NUMBER	SPEC OR DRAWING NUMBER	LOCATION AND DESCRIPTION OF CHANGE
1	C2.0	Replace warning track.
2	1500 – Temporary Facilities and Controls	Delete references to Field Offices, including sections 2.2-A through 2.2-B.

CLOSING DATE AND TIME: July 17, 2018 at 2:00 PM

SIGNED:
KPFF Consulting Engineers

A handwritten signature in blue ink, appearing to read 'AB', is placed over the printed name of Anna Backus.

Anna Backus, PE
Project Manager

Attachments: C2.0 – Grading Plan

1800101- sb

SHEET NOTES

1. PHOTO DOCUMENT IRRIGATION SYSTEM PRIOR TO CONSTRUCTION AND REPLACE IN KIND. SEE SHEET C3.0.

GRADING LABEL LEGEND

CALLOUT	DESCRIPTION
X.X%	GRADING SLOPE AND DIRECTION (DOWNHILL)
XX.XX	SPOT ELEVATION
XX	DESCRIPTION LISTED BELOW. NO DESCRIPTION MEANS TP OR TG
EG	EXISTING GRADE
FG	FINISHED GRADE
(XXX.X±)	EXISTING GRADE (MATCH WHERE APPLICABLE)

SHEET LEGEND

SYMBOL	DESCRIPTION	DETAIL REF.
	DRAINAGE FLOW DIRECTION	
	GRADE BREAK	
	EX. CONTOUR MINOR	
	EX. CONTOUR MAJOR	
	CONTOUR MINOR (FG)	
	CONTOUR MAJOR (FG)	
	CONVEYANCE SWALE	
	NEW SOIL & SEEDING	2/C4.0
	REPLACE WARNING TRACK. INSTALL 4" RED CINDER BUTTE SAND OR APPROVED EQUAL OVER COMPACTED SUBGRADE.	

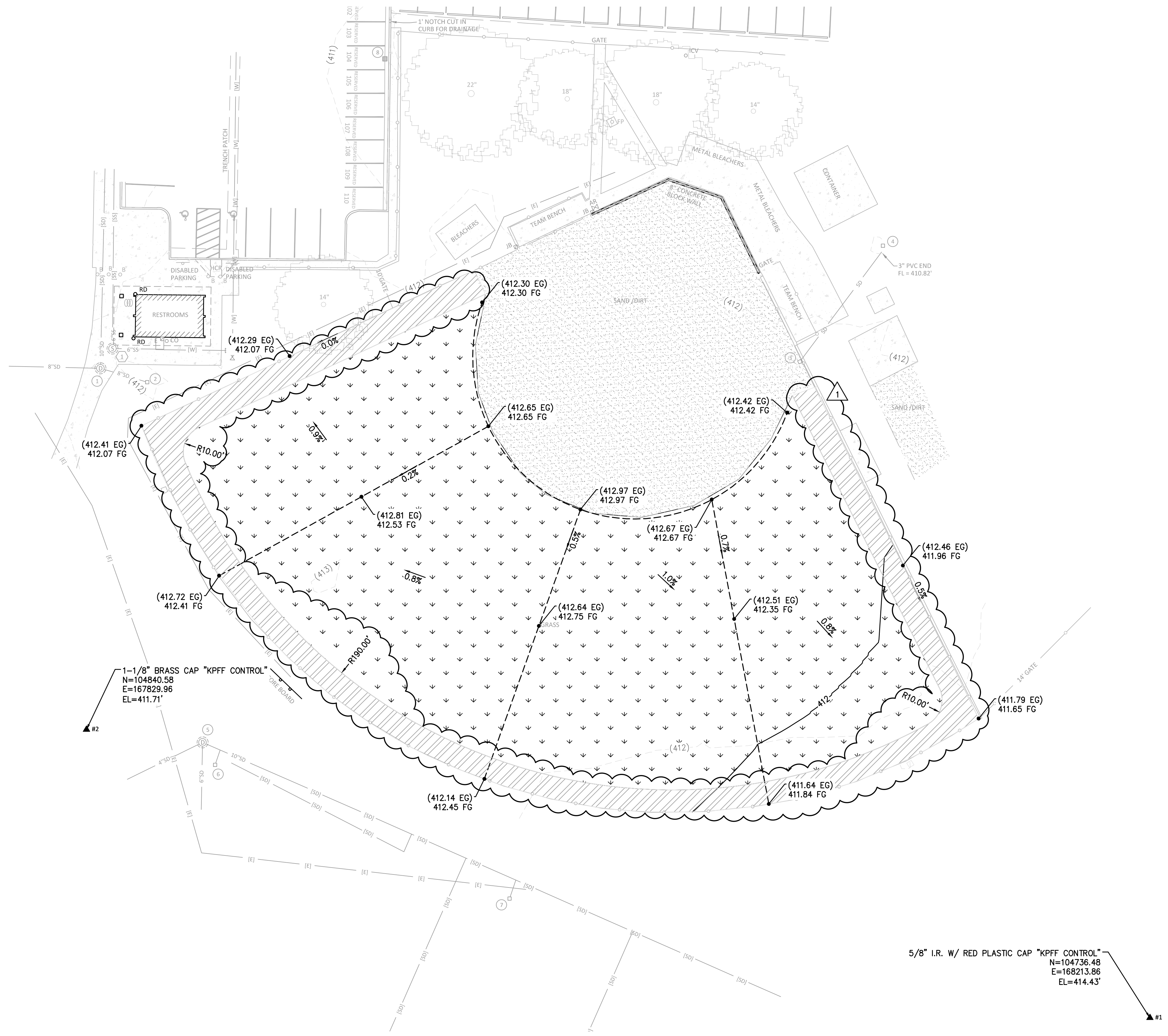

File: O:\c:\p\2018\1800107-Churchill-HS-Sports-Field\CAD\LOT\800107-02GD.dwg TAB: C2.0
 22x34 Plotted: 7/11/18 at 3:55pm By: ABackus

REVISION	DATE	DESCRIPTION	BY
1	7.11.2018	ADDENDUM 1	ALB

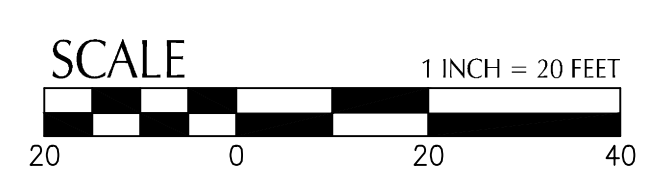
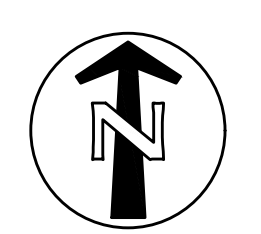

JOB No.:	1800107
DESIGNED BY:	ALB
DRAWN BY:	ALB
CHECKED BY:	PM
PLOT DATE:	7/11/18 3:55pm
PLOTTED BY:	ABackus
DWG NAME:	800107-02GD.dwg
TAB NAME:	C2.0

4J School District
CHURCHILL HIGH SCHOOL SOFTBALL FIELD
GRADING PLAN

SHEET NO.	
C2.0	
SHEET 2 OF 4	
RECORD NO.	1800107