

5/22/2018 1:27 PM W:\acad\SITES\SPENCER BUTTE\Spencer Butte--Room 36

General Notes:





1. The drawing is to be used for general information. Contractor to verify existing site conditions and classroom flooring dimensions.
2. Work to be conducted in accordance with all state and local fire codes.
3. Abatement Contractor to be responsible for cleaning or removing and possible disposal of any material that becomes contaminated during the course of asbestos abatement.
4. Cabinet locations are approximate.
5. 2'x2' plastic viewing window to be installed to observe abatement.

Abatement Notes:

1. Contractor to remove all metal / wood flooring transition strips.
2. Parquet flooring to be removed evenly up to all built-in cabinets, walls and around stairway to facilitate a smooth cove base installation.
3. Asbestos bag-out to be 2 chamber design, if used.
4. Contractor to build full negative pressure enclosure w/3 chamber decon.
5. Contractor to install and maintain a working manometer on the negative pressure enclosure. Containment negative pressure shall be maintained at a minimum of 0.02:" wg at all times during the abatement. Vent all hepa exhaust to the outside of building.

Abatement Schedule:
 Start: July 16, Finish: July 28
 Substantial Completion: July 28

Abatement Notes:

-  Indicates wood parquet flooring with asbestos containing mastic on slab and underside of parquet to be removed. 1,468 sq. ft.
-  Indicates non-asbestos containing VCT flooring / mastic on slab to be removed. 42 sq. ft.
-  Indicates asbestos containing 9"x 9" VAT flooring / mastic on slab to be removed. 42 sq. ft.
-  Indicates area of non-asbestos quarry tile flooring / cement thin-set mortar on slab to be removed. 83 sq. ft.

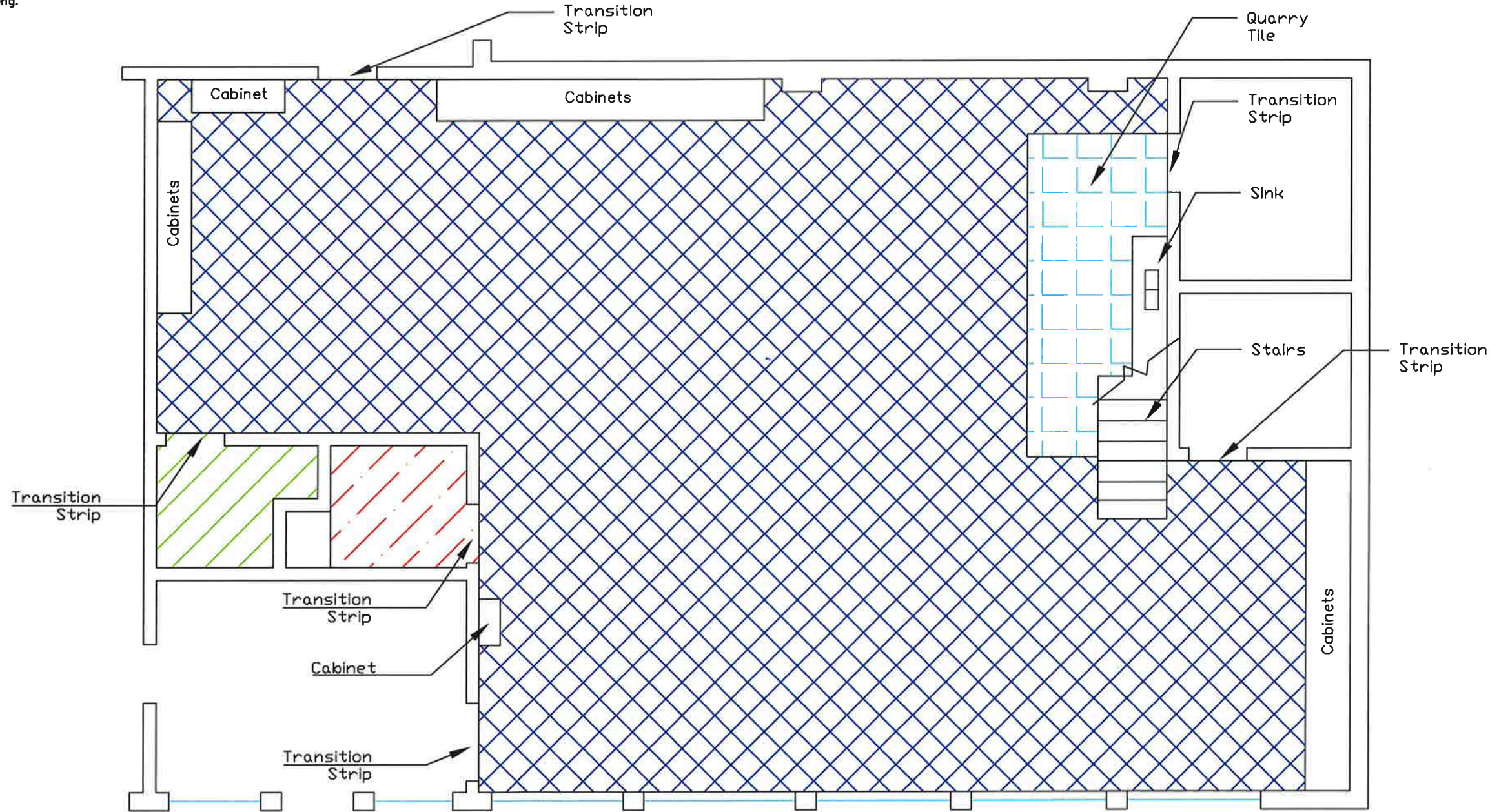

 Not to exact scale:



Facilities Management
 School District 4J
 715 W. 4th Avenue
 Eugene, OR 97402
 (541) 790-7400

SPENCER BUTTE MIDDLE SCHOOL
 500 EAST 43rd ABENUE 97405
 541-790-8300



DATE: 5-21-18

DRAWN BY D. Lemonds

SHEET

A-1

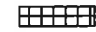
Base Quote: 12"x12" VCT Installation—Room #36
 ***ARMSTRONG—FLOORING

-  Approximate Quantity, 1,542—Pearl White, Field Color #51803
-  Approximate Quantity, 86—Classic, Spotter Color #51911
-  Approximate Quantity, 92—Carribean Blue, Spotter Color #51821

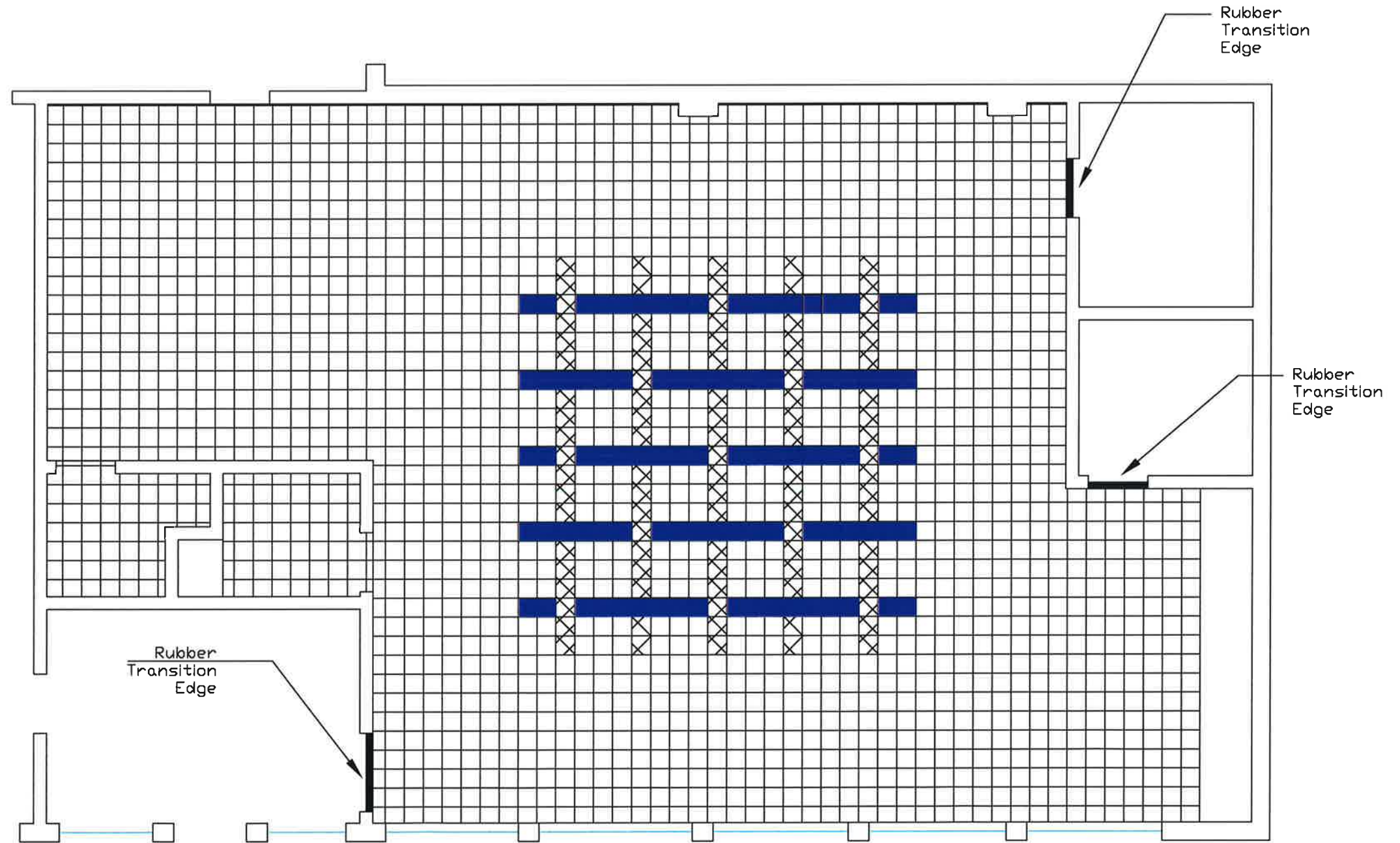

 Not to exact scale:



Facilities
 Management
 School District 4J
 715 W. 4th Avenue
 Eugene, OR 97402
 (541) 790-7400

SPENCER BUTTE MIDDLE SCHOOL
 500 EAST 43rd ABENUE 97405
 541-790-8300

DATE: 5-21-18

DRAWN BY D. Lemonds

SHEET

A-2