

**PROJECT:**

Eugene School District 4J  
 Multi-Site Security Fencing 2018  
 Adams, Camas Ridge & Twin Oaks Elementary Schools  
 C.I.P PROJECT NUMBER: 420.780.113

**OWNER'S REPRESENTATIVE:**

Donald F. Philpot  
 Eugene School District 4J  
 715 West 4<sup>th</sup> Avenue  
 Eugene, Oregon, 97402-4295  
 Office (541) 790-7430  
 Fax (541) 790-7404

**ARCHITECT:**

Loren Berry Architect  
 41601 Madrone St.  
 Springfield Oregon 97478  
 Office (541) 896-3692



This addendum, consisting of a total of 2 pages forms a part of the Contract Documents and modifies the original documents dated May 2, 2018.

**SPECIFICATIONS:****SECTION 32 31 13 – CHAIN LINK FENCES AND GATES**

Part 2.6 (A.3.a) revised to read:

“Gate Hinges: Egress Gates – Truclose series 3 closer. Utility Gates – Jansen “Gorilla” GUA2060.200GAL”.

**SECTION 32 31 19 – CHAIN LINK FENCES AND GATES**

Part 2.4 (A) revised to read:

“Gate Hinges: Egress Gates – Truclose series 3 closer. Utility Gates – Jansen “Gorilla” GUA2060.200GAL”.

**DRAWINGS:****SHEET T1: REPLACED WITH T1R**

Gate Schedule modified

**SHEET A1: REPLACED WITH A1R**

1/A1

Remove mow strip at classrooms 1 through 7. Install fence posts within existing concrete footprint. Hinge and strike posts to be installed per Detail 13/A4.1. Line posts to be installed per Detail 2/A1R.

General Notes

Note 2 modified.

**SHEET A2: REPLACED WITH A2R**

1/A2

Remove mow strip at library and classrooms 1 through 8. Install fence posts within existing concrete footprint. Hinge and strike posts to be installed per Detail 13/A4.1. Line posts to be installed per Detail 2/A1R.

General Notes

Note 2 modified.

**SHEET A3: REPLACED WITH A3R**

1/A2

Noted on detail callout for fence along adjacent property, 'NO MOW STRIP'.

Added Note 2 for Gate 17.

Added Note 3 for existing fence at classroom 2.

Delete gate 9.

Added callout adjacent to Gate 10 for fill-in.

Added notes 4 & 5 adjacent to Gate 10.

**General Notes**

Note 2 modified.

**Keyed Notes**

Added notes 3, 4 and 5.

# MULTI-SITE SECURITY FENCING 2018

C.I.P. # 420.780.113



**LorenBerryArchitect**  
 41601 Madrone Street, Springfield, OR 97478  
 (541) 596-3692 (p) 541-896-0231

MULTI-SITE SECURITY FENCING 2018  
 EUGENE SCHOOL DISTRICT 4J  
 C.I.P.#420.780.113

PROJECT NUMBER	1802	
DRAWN	DMT	
CHECKED	LRB	
DATE	5/10/2018	
REVISIONS		
No.	Description	Date
1	ADDENDUM #1	5/10/18

SHEET NUMBER

T1R

## GATE SCHEDULE

GATE NUMBER	USE	GATE DIMENSIONS		GATE FINISH	HARDWARE GROUP	HOLD OPEN QUANTITY	DETAILS	REMARKS
		WIDTH	HEIGHT					

### ADAMS

1	UTILITY GATE	8'-0" x 6'-0"	DM	2	1	3/A4.2		
2	EGRESS GATE	PR 3'-0" x 6'-0"	DM	1	2	3/A4.2	PROVIDE PANIC HARDWARE (OFCI)	
3	EGRESS GATE	3'-0" x 6'-0"	VC	1	1	2/A4.2	PROVIDE PANIC HARDWARE (OFCI)	
4	EGRESS GATE	3'-0" x 6'-0"	GALV	1	1	2/A4.2	PROVIDE PANIC HARDWARE (OFCI)	
5	EGRESS GATE	3'-0" x 6'-0"	GALV	1	1	2/A4.2	PROVIDE PANIC HARDWARE (OFCI)	
6	UTILITY GATE	PR 6'-0" x 6'-0"	GALV	2	2	5/A4.2		
7	EGRESS GATE	3'-0" x 6'-0"	GALV	1	1	2/A4.2	PROVIDE PANIC HARDWARE (OFCI)	
8	EGRESS GATE	3'-0" x 6'-0"	GALV	1	1	2/A4.2	PROVIDE PANIC HARDWARE (OFCI)	
9	EGRESS GATE	3'-0" x 6'-0"	GALV	1	1	2/A4.2	PROVIDE PANIC HARDWARE (OFCI)	
10	EGRESS GATE	3'-0" x 6'-0"	DM	1	1	1/A4.2	PROVIDE PANIC HARDWARE (OFCI)	
11	EGRESS GATE	3'-0" x 6'-0"	DM	1	1	1/A4.2	PROVIDE PANIC HARDWARE (OFCI)	
12	EGRESS GATE	3'-0" x 6'-0"	DM	1	1	1/A4.2	PROVIDE PANIC HARDWARE (OFCI)	
13	EGRESS GATE	3'-0" x 6'-0"	DM	1	1	1/A4.2	PROVIDE PANIC HARDWARE (OFCI)	
14	EGRESS GATE	3'-0" x 6'-0"	DM	1	1	1/A4.2	PROVIDE PANIC HARDWARE (OFCI)	
15	UTILITY GATE	PR 6'-0" x 6'-0"	VC	2	2	5/A4.2		

### CAMAS RIDGE

1	EGRESS GATE	3'-0" x 6'-0"	DM	1	1	1/A4.2	PROVIDE PANIC HARDWARE (OFCI)	
2	UTILITY GATE	PR 6'-0" x 6'-0"	VC	2	2	5/A4.2		
3	UTILITY GATE	PR 6'-0" x 6'-0"	VC	2	2	5/A4.2		
4	EGRESS GATE	3'-0" x 6'-0"	VC	1	1	2/A4.2	PROVIDE PANIC HARDWARE (OFCI)	
5	EGRESS GATE	3'-0" x 6'-0"	GALV	1	1	2/A4.2	PROVIDE PANIC HARDWARE (OFCI)	
6	EGRESS GATE	3'-0" x 6'-0"	VC	1	2	2/A4.2	PROVIDE PANIC HARDWARE (OFCI)	
7	EGRESS GATE	3'-0" x 6'-0"	GALV	1	1	2/A4.2	PROVIDE PANIC HARDWARE (OFCI)	
8	EGRESS GATE	3'-0" x 6'-0"	GALV	1	1	2/A4.2	PROVIDE PANIC HARDWARE (OFCI)	
9	EGRESS GATE	3'-0" x 6'-0"	GALV	1	1	2/A4.2	PROVIDE PANIC HARDWARE (OFCI)	
10	EGRESS GATE	3'-0" x 6'-0"	DM	1	1	1/A4.2	PROVIDE PANIC HARDWARE (OFCI)	
11	EGRESS GATE	3'-0" x 6'-0"	DM	1	1	1/A4.2	PROVIDE PANIC HARDWARE (OFCI)	
12	EGRESS GATE	3'-0" x 6'-0"	DM	1	1	1/A4.2	PROVIDE PANIC HARDWARE (OFCI)	
13	EGRESS GATE	PR 3'-0" x 6'-0"	DM	1	2	1/A4.2	PROVIDE PANIC HARDWARE (OFCI)	
14	EGRESS GATE	3'-0" x 6'-0"	DM	1	1	1/A4.2	PROVIDE PANIC HARDWARE (OFCI)	
15	UTILITY GATE	PR 6'-0" x 6'-0"	DM	3	2	4/A4.2		
16	EGRESS GATE	3'-0" x 6'-0"	DM	1	1	1/A4.2	PROVIDE PANIC HARDWARE (OFCI)	
17	UTILITY GATE	PR 6'-0" x 6'-0"	DM	3	2	4/A4.2		
18	EGRESS GATE	3'-0" x 6'-0"	DM	1	1	1/A4.2	PROVIDE PANIC HARDWARE (OFCI)	

### TWIN OAKS

1	EGRESS GATE	3'-0" x 6'-0"	GALV	1	1	2/A4.2	PROVIDE PANIC HARDWARE (OFCI)	
2	EGRESS GATE	3'-0" x 6'-0"	GALV	1	1	2/A4.2	PROVIDE PANIC HARDWARE (OFCI)	
3	UTILITY GATE	PR 6'-0" x 6'-0"	GALV	2	2	5/A4.2		
4	EGRESS GATE	3'-0" x 6'-0"	GALV	1	1	2/A4.2	PROVIDE PANIC HARDWARE (OFCI)	
5	EGRESS GATE	3'-0" x 6'-0"	GALV	1	1	2/A4.2	PROVIDE PANIC HARDWARE (OFCI)	
6	EGRESS GATE	3'-0" x 6'-0"	GALV	1	1	2/A4.2	PROVIDE PANIC HARDWARE (OFCI)	
7	EGRESS GATE	3'-0" x 6'-0"	GALV	1	1	2/A4.2	PROVIDE PANIC HARDWARE (OFCI)	
8	EGRESS GATE	3'-0" x 6'-0"	GALV	1	1	2/A4.2	PROVIDE PANIC HARDWARE (OFCI)	
9	NOT USED							
10	EGRESS GATE	3'-0" x 6'-0"	GALV	1	1	2/A4.2	PROVIDE PANIC HARDWARE (OFCI)	
11	UTILITY GATE	PR 6'-0" x 6'-0"	GALV	2	2	5/A4.2		
12	EGRESS GATE	3'-0" x 6'-0"	GALV	1	1	2/A4.2	PROVIDE PANIC HARDWARE (OFCI)	
13	EGRESS GATE	3'-0" x 6'-0"	GALV	1	1	2/A4.2	PROVIDE PANIC HARDWARE (OFCI)	
14	EGRESS GATE	3'-0" x 6'-0"	GALV	1	1	2/A4.2	PROVIDE PANIC HARDWARE (OFCI)	
15	EGRESS GATE	3'-0" x 6'-0"	GALV	1	1	2/A4.2	PROVIDE PANIC HARDWARE (OFCI)	
16	UTILITY GATE	PR 6'-0" x 6'-0"	GALV	2	2	5/A4.2		
17	EGRESS GATE	(E) WIDTH x 6'-0"	GALV	1	1	2/A4.2	PROVIDE PANIC HARDWARE (OFCI)	

NOTE: GATE FINISH TO MATCH FENCE AT EACH LOCATION

### HARDWARE GROUPS:

(REFER TO SPECIFICATIONS)

#### GROUP 1:

- STEEL HINGE, W/ TRUCLOSE SERIES 3 CLOSER
- PULL HANDLE W/ LOCK CYLINDER
- SURFACE MOUNTED PANIC HARDWARE
- HOLD-OPEN LATCH HOOK
- GATE STOP ANGLE

#### GROUP 2:

- STEEL HINGE, JANSEN "GORILLA" GUA2060.200GAL
- LATCH LOCK
- HOLD-OPEN LATCH HOOK
- GATE STOP PLATE

#### GROUP 3:

- STEEL HINGE, JANSEN "GORILLA" GUA2060.200GAL
- MASTER HALCO ROLO LATCH OR APPROVED
- HOLD-OPEN LATCH HOOK
- GATE STOP PLATE

### ABBREVIATIONS:

- DM Decorative Metal
- (E) Existing
- GALV Galvanized Chain Link
- OFCI Owner Furnished Contractor Installed
- PR Pair
- VC Vinyl Coated Chain Link

## ARCHITECT

LOREN BERRY ARCHITECT  
 41601 MADRONE STREET  
 SPRINGFIELD, OREGON 97478  
 (541) 896-3692 FAX (541) 896-0231  
 LOREN BERRY, AIA  
 lberry@berrych.com

## OWNER

4J SCHOOL DISTRICT  
 200 NORTH MONROE STREET  
 EUGENE, OREGON 97401  
 (541) 790-7430  
 DON PHILPOT  
 philpot@4j.lane.edu

## ELECTRICAL DESIGN

JLG ENGINEERING  
 31910 OWL ROAD  
 EUGENE, OREGON 97405  
 (541) 912-0065  
 JEFF GRAPER  
 jgraper@systemswestengineers.com

## PROJECT DESCRIPTION

SECURITY FENCE  
 WITH UTILITY & EGRESS GATES  
 AT (3) LOCATIONS

## BUILDING DATA - TYPICAL

CODES: 2010 STRUCTURAL SPECIALTY CODE  
 2010 OREGON FIRE CODE

FIRE SPRINKLER: NO  
 OCCUPANT LOAD: NO CHANGE

CONSTRUCTION TYPE: V  
 OCCUPANCY TYPE: GROUP E

## DRAWING SYMBOLS

- # KEYED NOTE AS SHOWN ON SHEET
- # GATE NUMBER DESIGNATION (SEE GATE SCHEDULE, DWG. T1)
- # FENCE TYPE DESIGNATION (SEE LEGEND SHOWN ON SHEET)
- SECTION DESIGNATION
- SHEET NO. WHERE SHOWN
- DETAIL DESIGNATION
- SHEET NO. WHERE SHOWN
- MAJOR SECTION REFERENCE INDICATES DIRECTION AND POINT AT WHICH SECTION IS TAKEN.
- DETAIL OR SECTION REFERENCE REFERS TO SECTION OR DETAILS.

## ABBREVIATIONS

- & Center Line
- At Diameter or Round
- # Found or Number
- AB Anchor Bolt
- AC Asphalt Concrete
- AD Area Drain
- ADD Addendum
- ALT Alternate
- ARCH Architectural
- BO By Owner
- CJ Central Joint
- CLR Clear
- CO Clean out
- CTR Center
- s, DIA Diameter
- DM Dimension
- DTL Detail
- DWG Drawing
- (E) Existing
- EA Each
- EJ Expansion Joint
- EMBED Embedment
- EQ Equal
- EXT Exterior
- FTG Footing
- GALV Galvanized
- GND Ground
- OR Grade
- GVL Gravel
- HB Hose Bibb
- HORIZ Horizontal
- INCL Include
- INT Interior
- OC On Center
- OFCI Owner Furnished Contractor Installed
- OF Outside Face
- PC Powder Coated
- PF Pre-finished paint by manufacturer
- PR Pair
- PVMT Pavement
- REINF Reinforce(d),(ing)
- REQD Required
- REV Revision
- RND Round
- SQ Square
- TOC Top of Concrete
- TOP Top of Concrete
- TOP Top of Pavement
- TOS Top of Slab
- TOW Top of Wall
- TS Tube Steel
- TYP Typical
- UNO Unless Noted Otherwise
- VERT Vertical
- VFY Verify
- V.I.F. Verify In Field
- W West
- W/ With
- W/O Without

## DRAWING INDEX

GENERAL	
T1	TITLE SHEET
ARCHITECTURAL	
A1	SITE PLAN - ADAMS ELEMENTARY SCHOOL
A2	SITE PLAN - CAMAS RIDGE ELEMENTARY SCHOOL
A3	SITE PLAN - TWIN OAKS ELEMENTARY SCHOOL
DETAILS	
A4.1	DETAILS
A4.2	DETAILS
ELECTRICAL	
E1.0	ELECTRICAL SYMBOLS AND SCHEDULES
E1.1	ELECTRICAL SITE PLAN - ADAMS ELEMENTARY SCHOOL
E1.2	ELECTRICAL SITE PLAN - CAMAS RIDGE ELEMENTARY SCHOOL

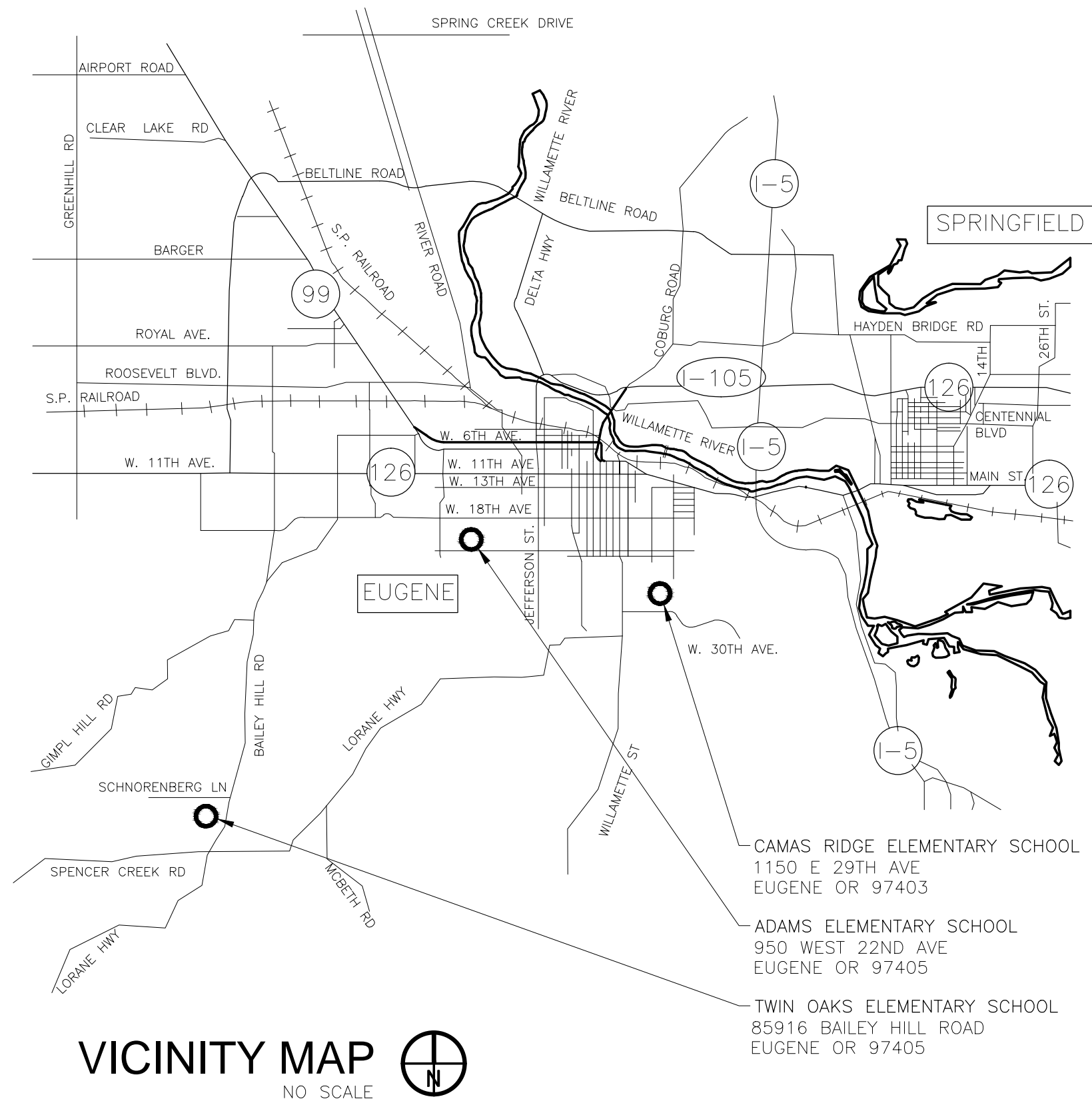

A  
B  
C  
D  
E

© LorenBerryArchitect 16

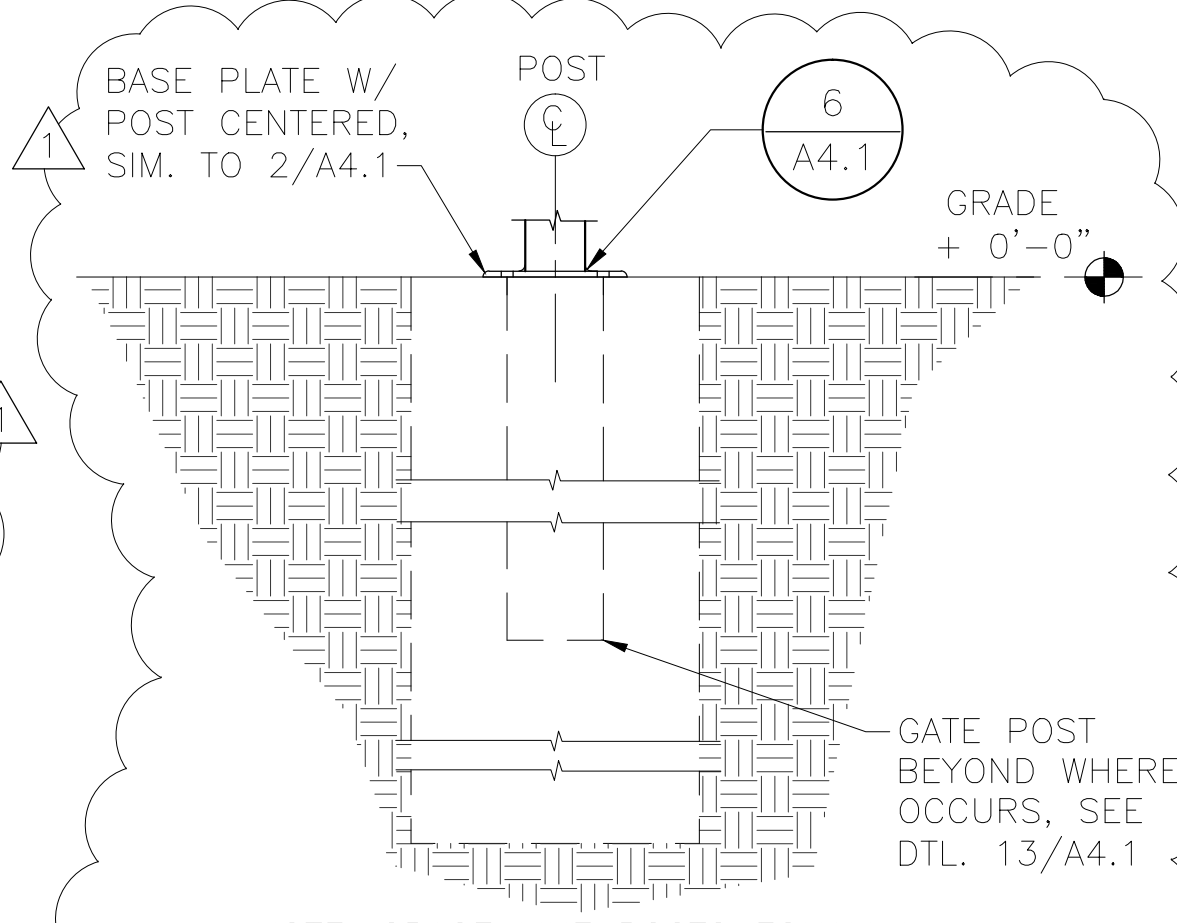
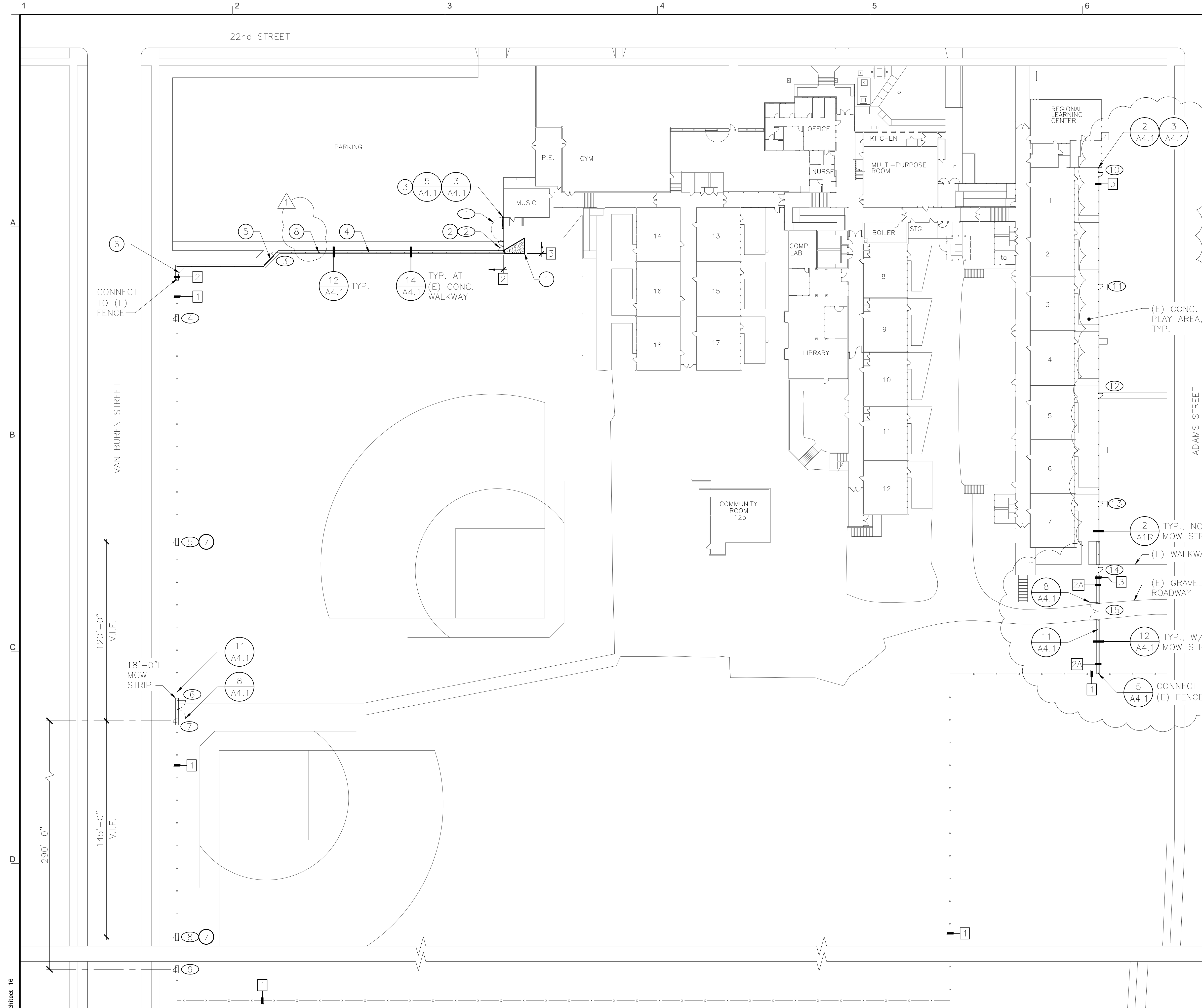

NOTE: SPACE LINE POSTS EQUALLY. MAXIMUM SPACING TO BE 8'-0".

LINE POST AT PLAY AREA  
 $1 \frac{1}{2}'' = 1'-0''$

**GENERAL NOTES**

- SEE SPECIFICATIONS SECTION 32 31 13 FOR FURTHER INFORMATION REGARDING FENCE AND GATE DESIGN AND CONSTRUCTION.
- CONTRACTOR IS RESPONSIBLE FOR IDENTIFYING LOCATIONS OF IRRIGATION IN THE WAY OF NEW WORK. COORDINATE WITH DISTRICT IRRIGATION SPECIALIST DAN PACHAECO 541-790-7595.

**KEYED NOTES**

- 6" CONCRETE W/ #3 @ 18" O.C. E.W., AIR ENTRAINED W/LIGHT BROOM FINISH OVER 4" ROCK. DOWEL INTO (E) CONC. PER DTL. 14/A4.1.
- INSTALL LATCH POST FOR NORTH EGRESS GATE PER DTL. 8/A4.1. INSTALL GATE HOLD-OPEN FOR SOUTH EGRESS GATE PER DTL. 11/A4.1.
- INSTALL EYE BOLT ON END POST AT LOCATION TO RECEIVE GATE LATCH HOOK.
- PLACE FENCE LINE WITHIN MOW STRIP 6" AWAY FROM SOUTH EDGE (THIS LENGTH OF FENCE ONLY).
- PLACE FENCE LINE WITHIN MOW STRIP 6" AWAY FROM NORTH EDGE (THIS LENGTH OF FENCE ONLY).
- ADD CONCRETE AT INSIDE CORNER TO FORM 48" CHAMFER.
- EXISTING OPENING IN FENCE TO BE MODIFIED FOR NEW GATE.
- CONTRACTOR TO LOCATE UNDERGROUND ELECTRICAL AT BOLLARD LIGHTING.

**LEGEND**

- 1 (E) CHAIN LINK FENCE
- 2 TYPE II CHAIN LINK FENCING SYSTEM - BLACK POWDER COATED COMPONENTS, BLACK VINYL COATED MESH WIRE, BOTTOM RAIL, MOW STRIP
- 2A TYPE II CHAIN LINK FENCING SYSTEM - BLACK POWDER COATED COMPONENTS, BLACK VINYL COATED MESH WIRE, NO BOTTOM RAIL, ADD TENSION WIRE, MOW STRIP
- 3 DECORATIVE METAL FENCING SYSTEM
- # GATE NUMBER DESIGNATION (FOR DESIGN AND DETAIL REFERENCE, SEE GATE SCHEDULE ON DWG. T1)
- Denotes CONCRETE MOWSTRIP UNDER NEW GATE. BLEND AND COMPACT EARTH OR ROCK BACKFILL EVEN WITH CONCRETE

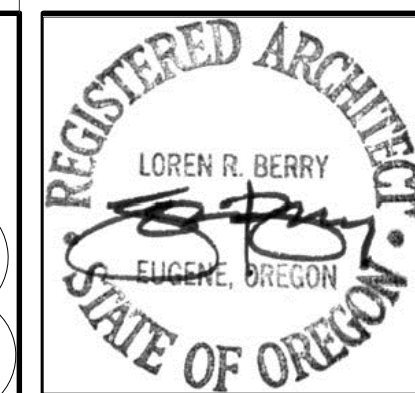

**LorenBerryArchitect**  
 41601 Madrone Street, Springfield, OR 97478  
 (P) 541-896-3692  
 (F) 541-896-0231

MULTI-SITE SECURITY FENCING 2018  
 EUGENE SCHOOL DISTRICT 4J  
 C.I.P.#420.780.113  
 SITE PLAN  
 ADAMS ELEMENTARY SCHOOL

PROJECT NUMBER	1802	
DRAWN	DMT	
CHECKED	LRB	
DATE	5/10/2018	
REVISIONS		
No.	Description	Date
1	ADDENDUM #1	5/10/18

SHEET NUMBER  
**A1R**

1 SITE PLAN - ADAMS  
 A1R 950 WEST 22ND AVE  
 EUGENE OR 97405

1/32" = 1'-0"



**LorenBerryArchitect**  
 41601 Madrone Street, Springfield, OR 97478  
 (P) 541-896-3692  
 (F) 541-896-0231

MULTI-SITE SECURITY FENCING 2018  
 EUGENE SCHOOL DISTRICT 4J  
 C.I.P.#420.780.113

SITE PLAN  
 CAMAS RIDGE ELEMENTARY SCHOOL

PROJECT NUMBER	1802	
DRAWN	DMT	
CHECKED	LRB	
DATE	5/10/2018	
REVISIONS		
No.	Description	Date
1/A	ADDENDUM #1	5/10/18

SHEET NUMBER

**A2R**

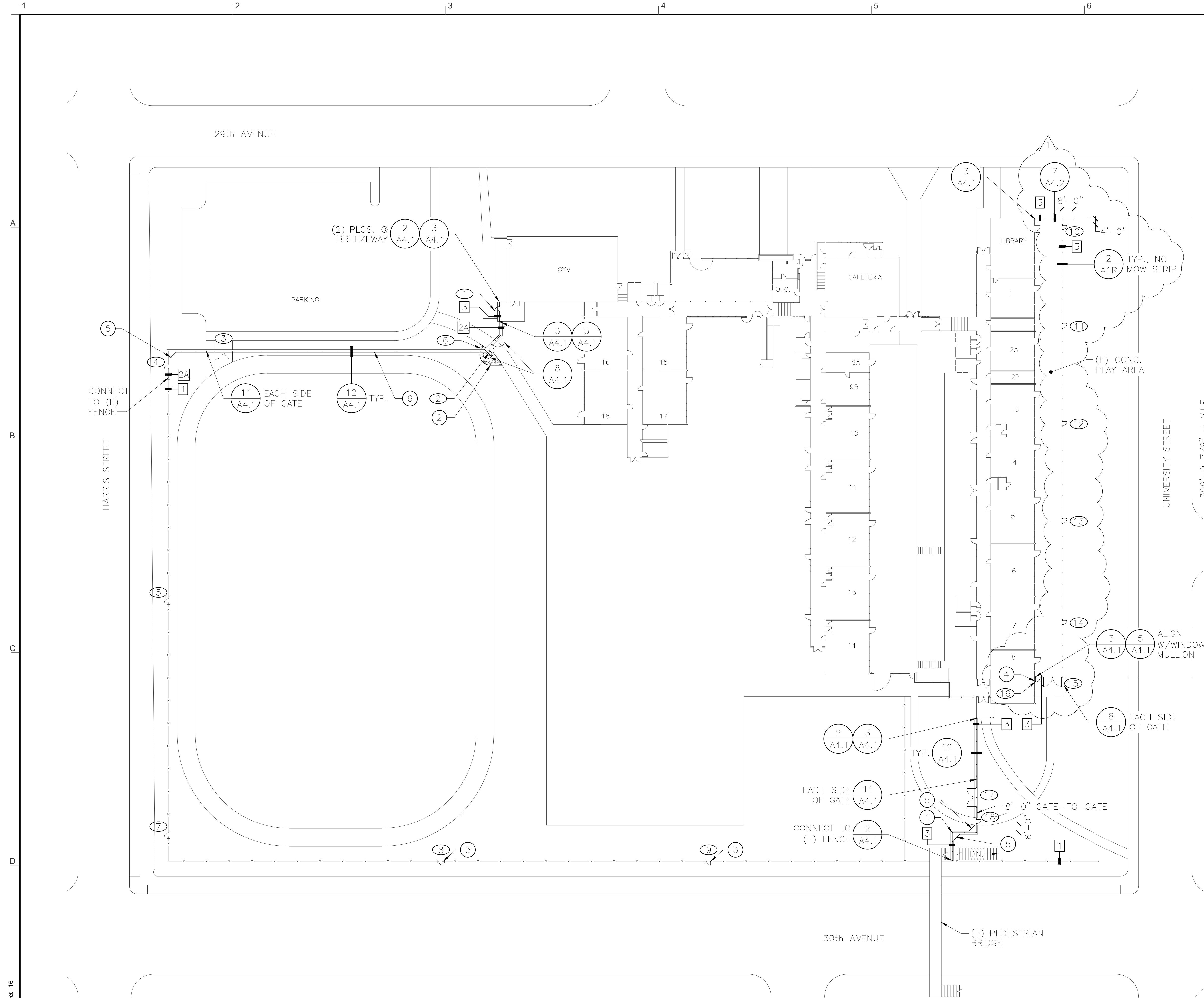

**GENERAL NOTES**

- SEE SPECIFICATIONS SECTION 32 31 13 FOR FURTHER INFORMATION REGARDING FENCE AND GATE DESIGN AND CONSTRUCTION.
- CONTRACTOR IS RESPONSIBLE FOR IDENTIFYING LOCATIONS OF IRRIGATION IN THE WAY OF NEW WORK. COORDINATE WITH DISTRICT IRRIGATION SPECIALIST DAN PACHAECO 541-790-7595.

**KEYED NOTES**

- EXTEND FENCE WESTERLY ONLY TO THE POINT WHERE IT WILL TURN 90° TO THE SOUTH AND TRAVEL UNDERNEATH THE PEDESTRIAN BRIDGE STRUCTURE WITH A 3'-0" MIN. CLEARANCE FROM TOP OF FENCE POST TO UNDERSIDE OF STRUCTURE. CONNECT TO (E) FENCE.
- 4" DECOMPOSED GRANITE OVER 4" ROCK. BLEND INTO (E) GRAVEL ROADWAY.
- FINAL GATE LOCATION TO BE DETERMINED IN THE FIELD BY OWNER.
- INSTALL EYE BOLT ON (E) STRUCTURE AT LOCATION TO RECEIVE GATE LATCH HOOK.
- ADD CONCRETE AT INSIDE CORNER TO FORM 48" CHAMFER.
- SLOPE MOW STRIP TO MATCH (E) GRADE.

**LEGEND**

- [1] (E) CHAIN LINK FENCE
- [2] TYPE II CHAIN LINK FENCING SYSTEM - BLACK POWDER COATED COMPONENTS, BLACK VINYL COATED MESH WIRE, BOTTOM RAIL, MOW STRIP
- [2A] TYPE II CHAIN LINK FENCING SYSTEM - BLACK POWDER COATED COMPONENTS, BLACK VINYL COATED MESH WIRE, NO BOTTOM RAIL, ADD TENSION WIRE, MOW STRIP
- [3] DECORATIVE METAL FENCING SYSTEM
- # GATE NUMBER DESIGNATION (FOR DESIGN AND DETAIL REFERENCE, SEE GATE SCHEDULE ON DWG. T1)
- [E] DENOTES CONCRETE MOWSTRIP UNDER NEW GATE. BLEND AND COMPACT EARTH OR ROCK BACKFILL EVEN WITH CONCRETE

**1 SITE PLAN - CAMAS RIDGE**  
 A2R 1150 E 29TH AVE  
 EUGENE OR 97403

1/32"=1'-0"

© LorenBerryArchitect '16

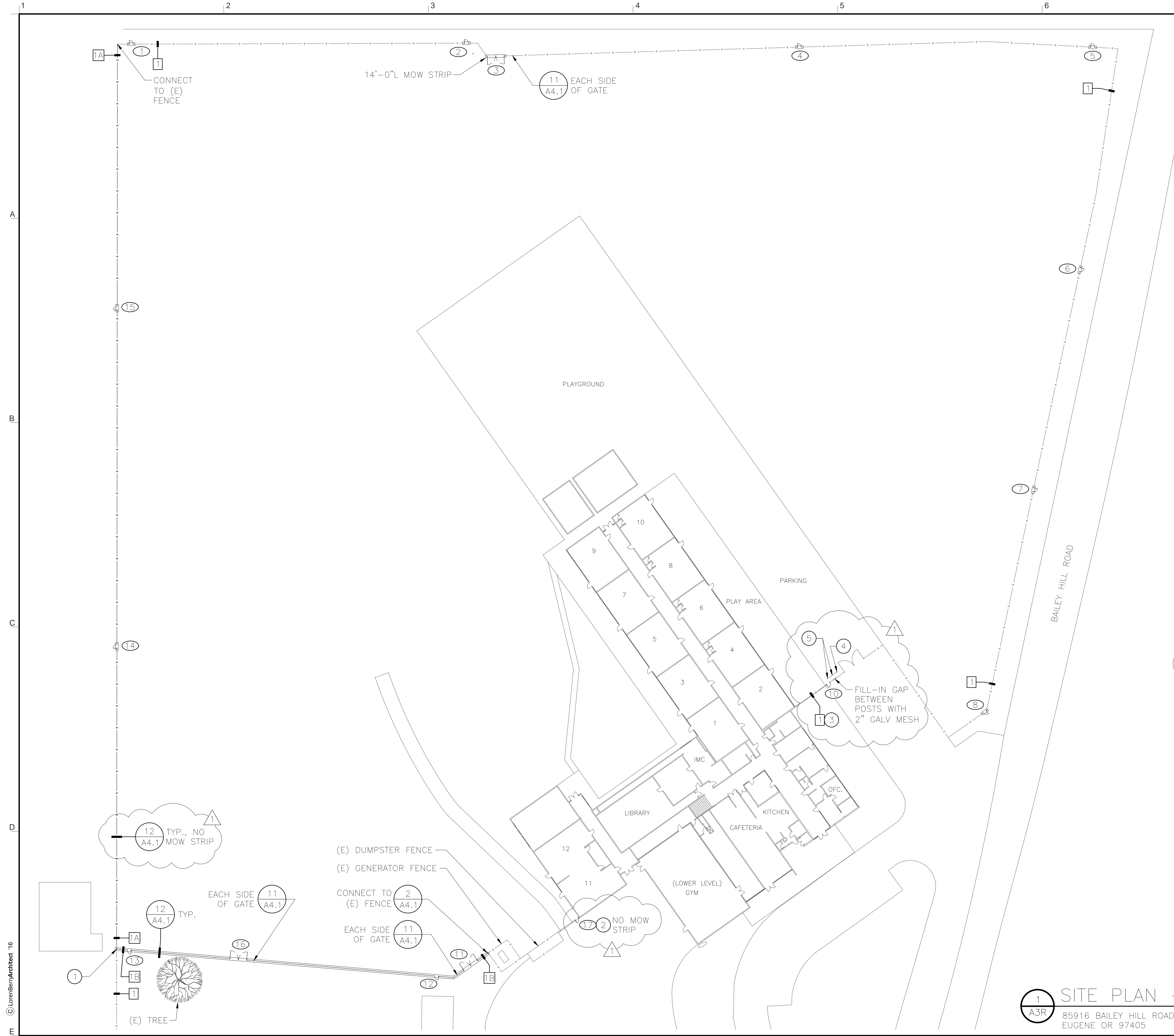

**GENERAL NOTES**

- SEE SPECIFICATIONS SECTION 32 31 13 FOR FURTHER INFORMATION REGARDING FENCE AND GATE DESIGN AND CONSTRUCTION.
- CONTRACTOR IS RESPONSIBLE FOR IDENTIFYING LOCATIONS OF IRRIGATION IN THE WAY OF NEW WORK. COORDINATE WITH DISTRICT IRRIGATION SPECIALIST DAN PACHAECO 541-790-7595.

**KEYED NOTES**

- REPLACE (E) FENCE POST WITH CORNER POST AND RECONNECT TO (E) FENCE TO THE SOUTH. REPLACE (E) FENCE LINE TO THE NORTH AS SHOWN.
- EXISTING GATE TO BE FIT WITH PANIC HARDWARE.
- EXTEND HEIGHT OF (E) CHAIN LINK FENCE TO 6'-0"
- (E) FENCE POST TO REMAIN AS LATCH POST, PROVIDE EYE BOLT AT 3'-6" ABOVE (E) ASPHALT.
- (E) FENCE AND POST TO BE REMOVED.

**LEGEND**

- 1 (E) CHAIN LINK FENCE
- 1A TYPE I CHAIN LINK FENCING SYSTEM - GALVANIZED, NO BOTTOM RAIL, ADD TENSION WIRE, NO MOW STRIP.
- 1B TYPE I CHAIN LINK FENCING SYSTEM - GALVANIZED, NO BOTTOM RAIL, ADD TENSION WIRE, MOW STRIP.
- # GATE NUMBER DESIGNATION (FOR DESIGN AND DETAIL REFERENCE, SEE GATE SCHEDULE ON DWG. T1)
- Denotes CONCRETE MOWSTRIP UNDER NEW GATE. BLEND AND COMPACT EARTH OR ROCK BACKFILL EVEN WITH CONCRETE

1 SITE PLAN - TWIN OAKS  
 A3R 85916 BAILEY HILL ROAD  
 EUGENE OR 97405 1/32"=1'-0" N



**LorenBerryArchitect**  
 LOREN R. BERRY  
 EUGENE, OREGON  
 41601 Madrone Street Springfield, OR 97478  
 (p) 541-596-3692  
 (f) 541-596-0231

MULTI-SITE SECURITY FENCING 2018  
 EUGENE SCHOOL DISTRICT 4J  
 C.I.P.#420.780.113

SITE PLAN  
 TWIN OAKS ELEMENTARY SCHOOL

PROJECT NUMBER	1802	
DRAWN	DMT	
CHECKED	LRB	
DATE	5/10/2018	
REVISIONS		
No.	Description	Date
1	ADDENDUM #1	5/10/18

SHEET NUMBER  
**A3R**

© LorenBerryArchitect '16