

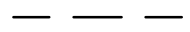

DEMO PLAN

Scale: 1" = 20' 1

LEGEND

-  PROJECT LIMIT LINE
-  SAWCUT HARDSCAPE ELEMENTS
-  ELEMENT TO BE REMOVED
-  HARDSCAPE TO BE REMOVED
-  15' DIMENSION
-  15' DIMENSION From Face of Curb

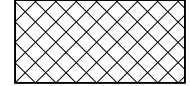
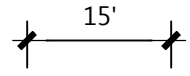
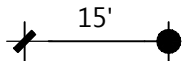
SCOPE OF WORK:

1. Work is to reconstruct parking configuration of parking spaces as it was designed for original construction in 2002.
2. Excavate asphalt and base material and reconstruct planters as shown with full depth curbs, irrigation assemblies, earth backfill and plantings.
3. Grind existing striping and re-stripe area affected by new work. Grind crosswalk leading from the reconfigured parking to the accessible ramp.

OUTLINE SPECIFICATIONS:

1. Crushed Base Rock: 12" depth. 3/4-inch minus, free from foreign material, conforming to ODOT Standards.
2. Compaction: Rock Base: 95%. Asphalt Pavement: 92%, Earth Backfill 90%.
3. Hot Mix Asphalt Pavement: 7-inch thick patch. Dense Level 2 per ODOT Standards.
4. Asphalt Tack Coat: at edges conforming to ODOT Standards.
5. Sand: as required for tack and sand at adjoining asphalt.
7. Owner shall provide independent testing rock base and pavement compaction.
8. Topsoil: 24-inch minimum thickness. Pre-mixed planting soil. Primary Planting Soil by Rexius, Frugal Planting Soil by Lane Forest, or approved.
9. Irrigation products to match existing irrigation. Rain Bird Series specified for Original Installation in 2003. Layout to be design/built and to match existing layout.

GENERAL NOTES

1. Protect existing concrete driveways, curbs, and fencing from damage. Repair any damage to areas during work.
2. Provide erosion control devices at nearby catch basins to prevent sediment-laden runoff from entering Storm Drain system. Periodically clean any erosion control devices as required.
3. Dimensions and locations of underground utilities are approximate. Provide private locate of utilities prior to commencing work.
4. Maintain vehicle access to parking lot and service drive during construction.
5. Confine construction activities as close to work footprint as possible.
6. Blend all new elevations back to existing grade to create uniform slope. Maximum slope, 4:1.
7. Construct smooth transitions between new paving improvements and existing paving to remain.
8. Dimensions are from face of curb unless noted otherwise.
9. Connect new irrigation to adjacent existing irrigation zone. Adjust radius on spray heads as necessary to minimize overspray while achieving full and even coverage of planted areas. Coordinate with Owner.
10. Construction entrance and egress through parking lot. Coordinate with Owner.

0' 10' 20' 40'

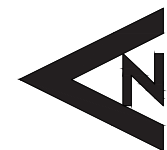

Project #: 1769B

Date: Apr. 11, 2018

100%  
 CONSTRUCTION DOCUMENTS  
 EXISTING CONDITIONS AND DEMO PLAN

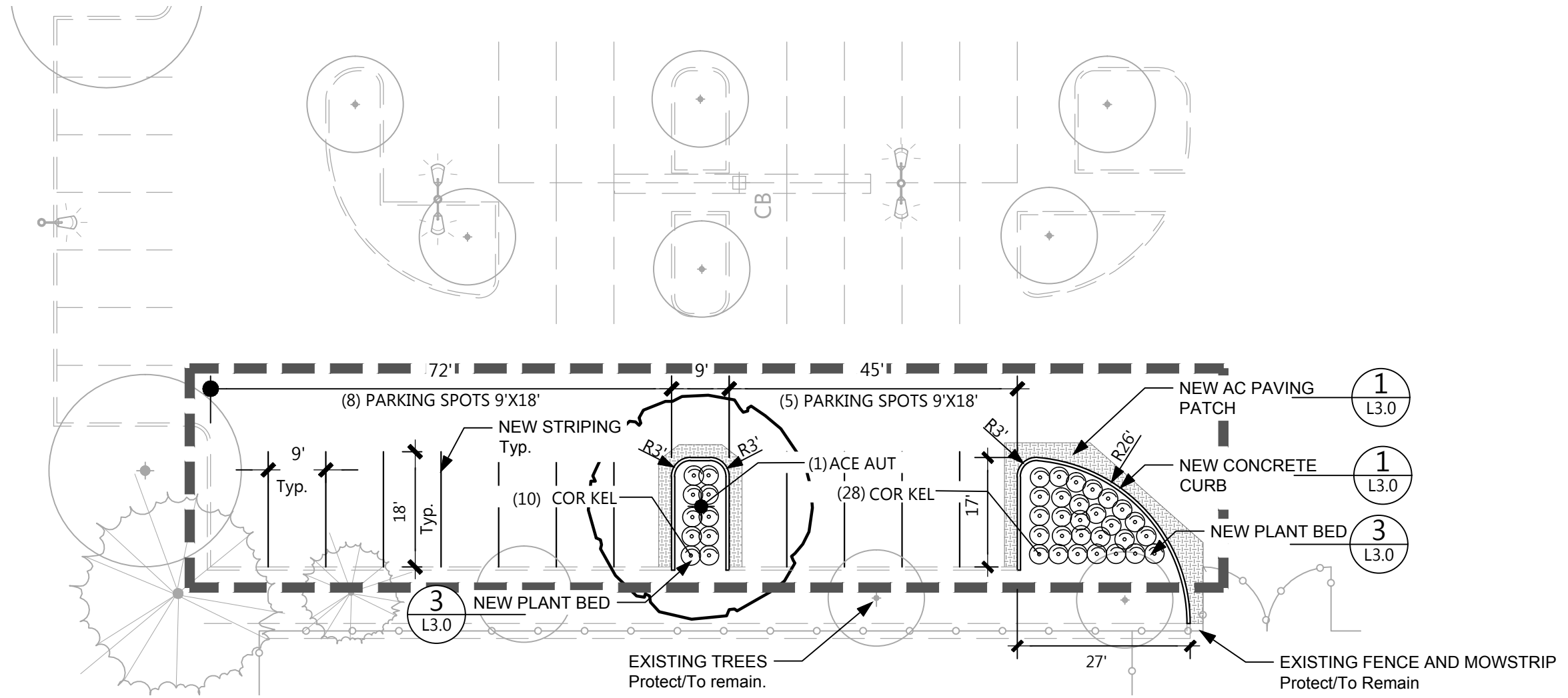

L1.0



PARTIAL SITE PLAN

Scale: 1" = 20' 1

LEGEND

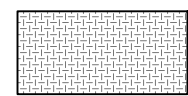
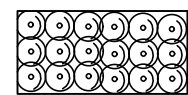
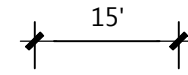
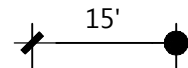
-  PROJECT LIMIT LINE
-  CONCRETE CURB 1 L3.0
-  PROPOSED TREE CENTER See Planting and Irrigation Plan 3 L3.0
-  AC PAVING PATCH 1 L3.0
-  PLANT BED 3 L3.0
  - 18" min. depth
  - Rexius Primary Planting Soil, Lane Forest Frugal Mix, or approved.
-  15' DIMENSION
-  15' DIMENSION From Face of Existing Curb

GENERAL NOTES

See Sheet L1.0

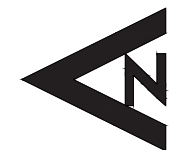
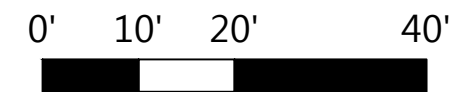

**CHAVEZ ELEMENTARY SCHOOL  
 PARKING IMPROVEMENT**

C.I.P. # 420.320.008

EUGENE SCHOOL DISTRICT 4J  
 1510 W 14TH AVENUE  
 EUGENE, OREGON 97402



Project #: 1769B

Date: Apr. 11, 2018

100%  
 CONSTRUCTION  
 DOCUMENTS

SITE PLAN

L2.0

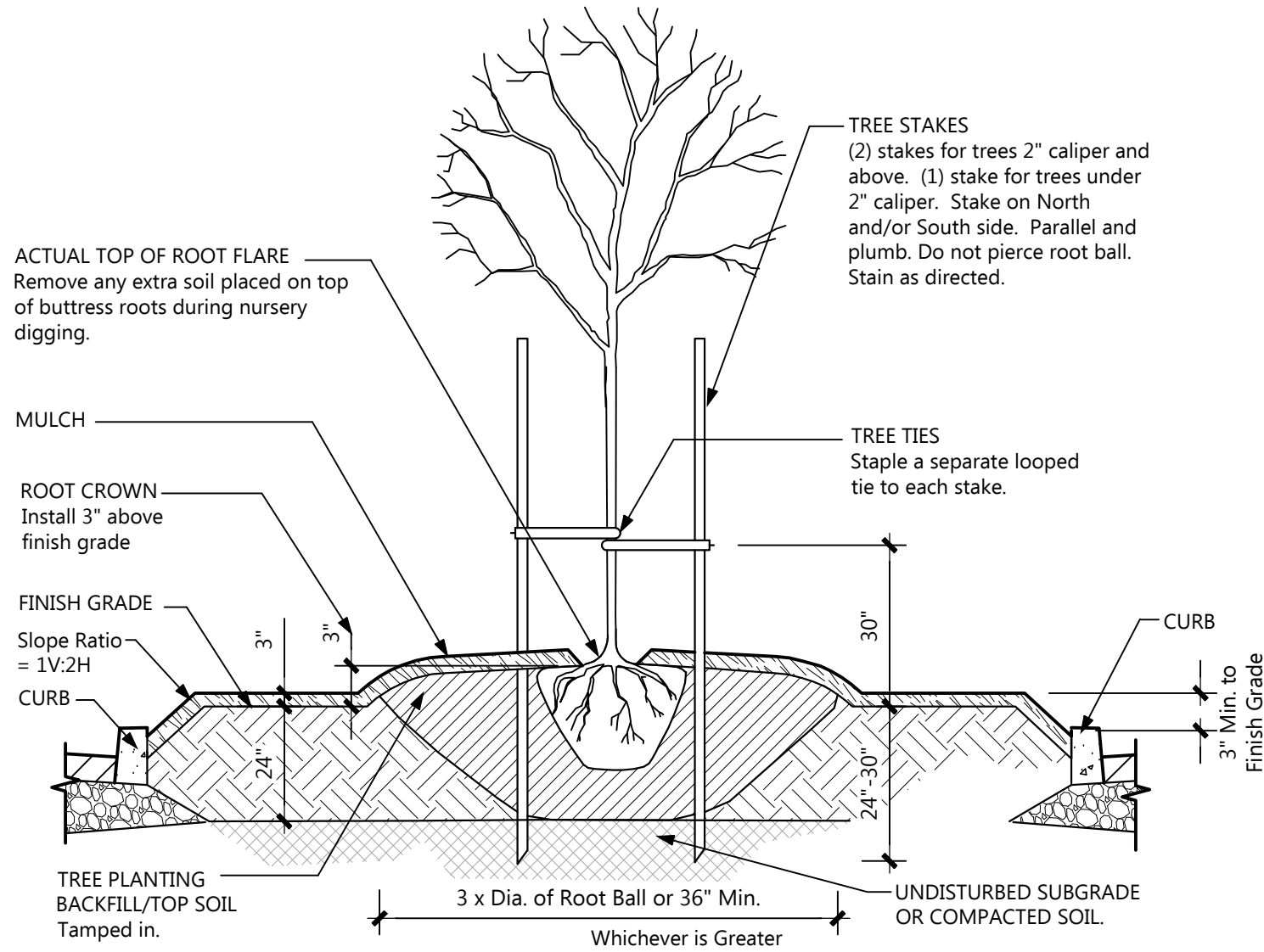

**NOTES**

1. Finish grade, unless specifically identified otherwise, is comprised of a horizontal plane 3" above highest adjacent edge.
2. Trees planted too deeply will not be accepted.
3. Remove tree ties and stakes one year after planting unless directed otherwise.
4. Provide trees planted in lawn with minimum 5 foot diameter bark area. Hold bark away from trunk.
5. Remove burlap from top of root ball.

**PLANT BED PROFILE AND DECIDUOUS TREE PLANTING**

NTS

3

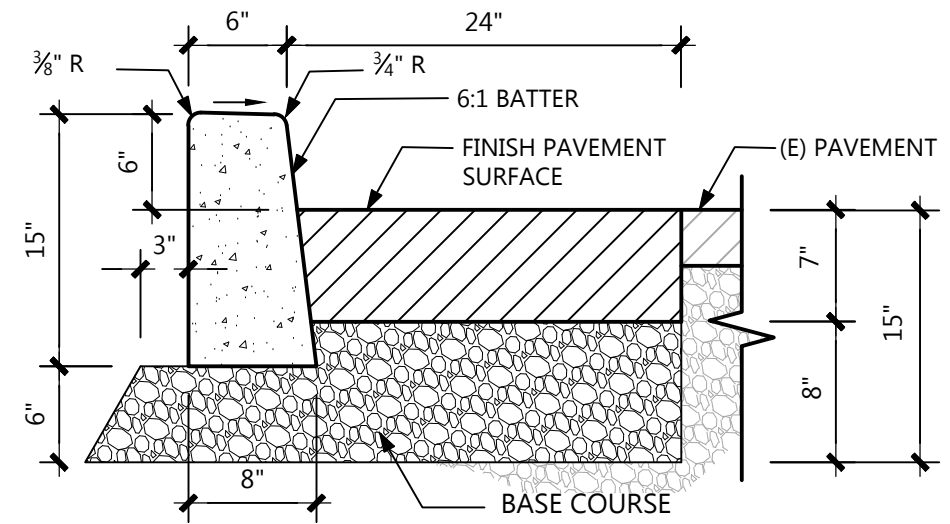

**NOTES**

1. Slope top of curb toward AC at 1.5% .
2. Provide expansion joints @ 200' o.c. max. and @ all points of tangency.
3. Sawcut green concrete control joints @ 15' max.

**CONCRETE CURB**

NTS

1

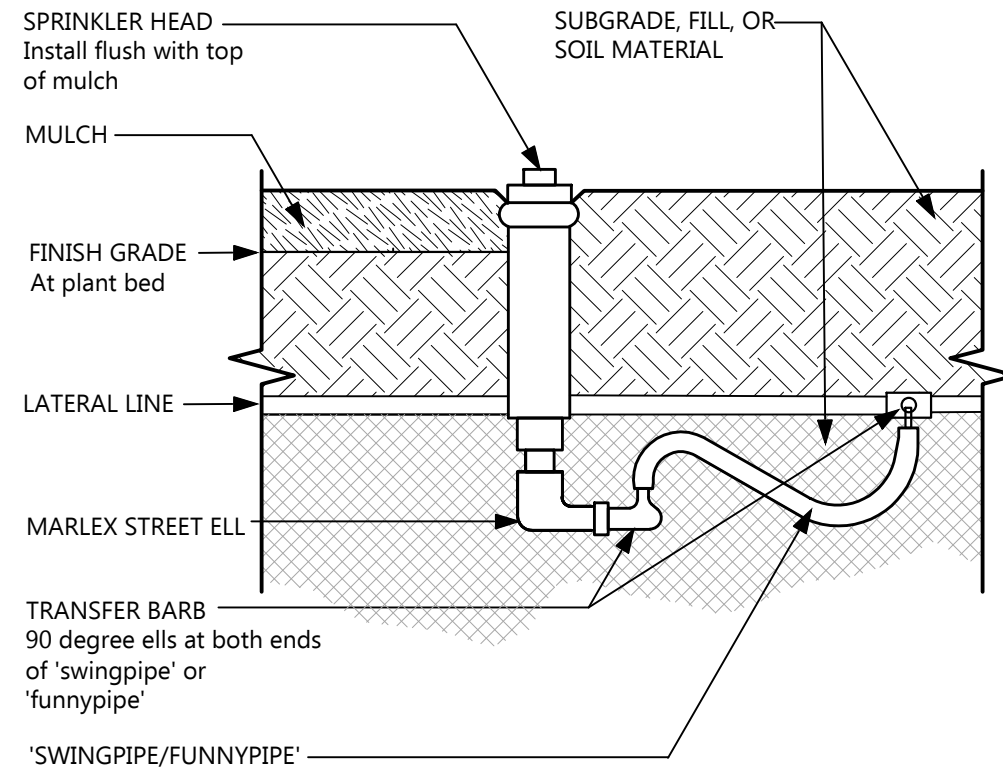

**NOTES**

1. Use teflon tape on all threaded pipe joints.
2. Install sprinkler head 3 inches from pavement or curbs.
3. Rain Bird Series specified for Original Installation in 2003.

**FLEX RISER ASSEMBLY**

NTS

2



Project #: 1769B

Date: Apr. 11, 2018

100%  
CONSTRUCTION  
DOCUMENTS

PAVING  
DETAILS

**L3.0**