







- LEGEND**
-  ASBESTOS- CONTAINING FLOOR TILE AND ASSOCIATED MASTIC AND LEVELING COMPOUND UNDER CARPET TO BE REMOVED
 -  ASBESTOS- CONTAINING FLOOR TILE AND ASSOCIATED MASTIC AND LEVELING COMPOUND TO BE REMOVED
 -  ASBESTOS- CONTAINING FLOOR TILE AND ASSOCIATED MASTIC AND LEVELING COMPOUND UNDER NON-ASBESTOS WALL TO BE REMOVED
 -  AREA NOT INCLUDED IN SCOPE
 -  * TWO LAYERS OF CARPET EXIST IN THIS AREA
- KEY NOTES**
-  DEMO CASEWORK (PRESUME THAT ASBESTOS-CONTAINING FLOOR TILE AND ASSOCIATED MASTIC AND LEVELING COMPOUND EXTEND BENEATH CASEWORK)



- GENERAL NOTES**
1. THIS DRAWING IS DIAGRAMMATIC. IT IS FOR GENERAL INFORMATION.
 2. BUILDING DRAWING FOOTPRINT MAYBE INACCURATE OR NOT TO SCALE. CONTRACTOR IS TO FIELD VERIFY ALL MATERIAL LOCATIONS AND QUANTITIES.
 3. ABATEMENT CONTRACTOR IS TO COORDINATE HIS WORK WITH THE OWNER AND GENERAL CONTRACTOR INCLUDING BUT NOT LIMITED TO: SCHEDULING, PHASING, ACCESS, SECURITY, STAGING, PROTECT AND SAVE ITEMS, SALVAGE, ISOLATION OR LOCKOUT/TAGOUT OF UTILITIES AND DEMOLITION.
 4. IF SUSPECT MATERIALS ARE UNCOVERED DURING ABATEMENT, DEMOLITION OR RENOVATION THAT ARE NOT IDENTIFIED OR SAMPLED IN THE HAZARDOUS MATERIALS SURVEY REPORT OR SHOWN ON THIS DRAWING, STOP WORK AND CONTACT THE HAZARDOUS MATERIALS CONSULTANT AND THE JOB SUPERINTENDENT FOR ADDITIONAL TESTING.
 5. ABATEMENT CONTRACTOR SHALL PERFORM ALL SELECTIVE DEMOLITION AS NEEDED TO ACCESS AND ABATE ASBESTOS CONTAINING MATERIALS.
 6. ALL CONTRACTORS AND SUB-CONTRACTOR PERFORMING DEMOLITION OR RENOVATION ACTIVITIES ON PAINTED SURFACES ARE TO COMPLY WITH ALL APPLICABLE LEAD PAINT REGULATIONS IN OAR 437 DIVISION 3, 1926.62 LEAD IN CONSTRUCTION INDUSTRY STANDARDS.
 7. REFERENCE HAZARDOUS MATERIALS SURVEY REPORT AND PROJECT ABATEMENT SPECIFICATIONS FOR ADDITIONAL INFORMATION.

- BASE BID - ESTIMATED QUANTITIES OF HAZARDOUS MATERIALS TO BE REMOVED**
1. REMOVE APPROX. 2,575 SF OF ASBESTOS- CONTAINING FLOOR TILE AND ASSOCIATED MASTIC AND LEVELING COMPOUND (ON CONCRETE). SEE LEGEND.
 2. REMOVE APPROX. 5,500 SF OF ASBESTOS- CONTAINING FLOOR TILE AND ASSOCIATED MASTIC AND LEVELING COMPOUND UNDER CARPET (ON CONCRETE). SEE LEGEND.
 3. REMOVE APPROX. 48 LF OF ASBESTOS- CONTAINING FLOOR TILE AND ASSOCIATED MASTIC AND LEVELING COMPOUND UNDER NON-ACM WALL. SEE LEGEND.

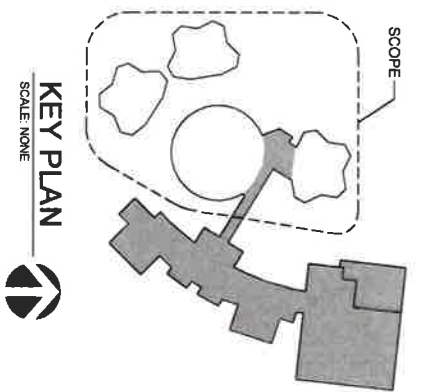
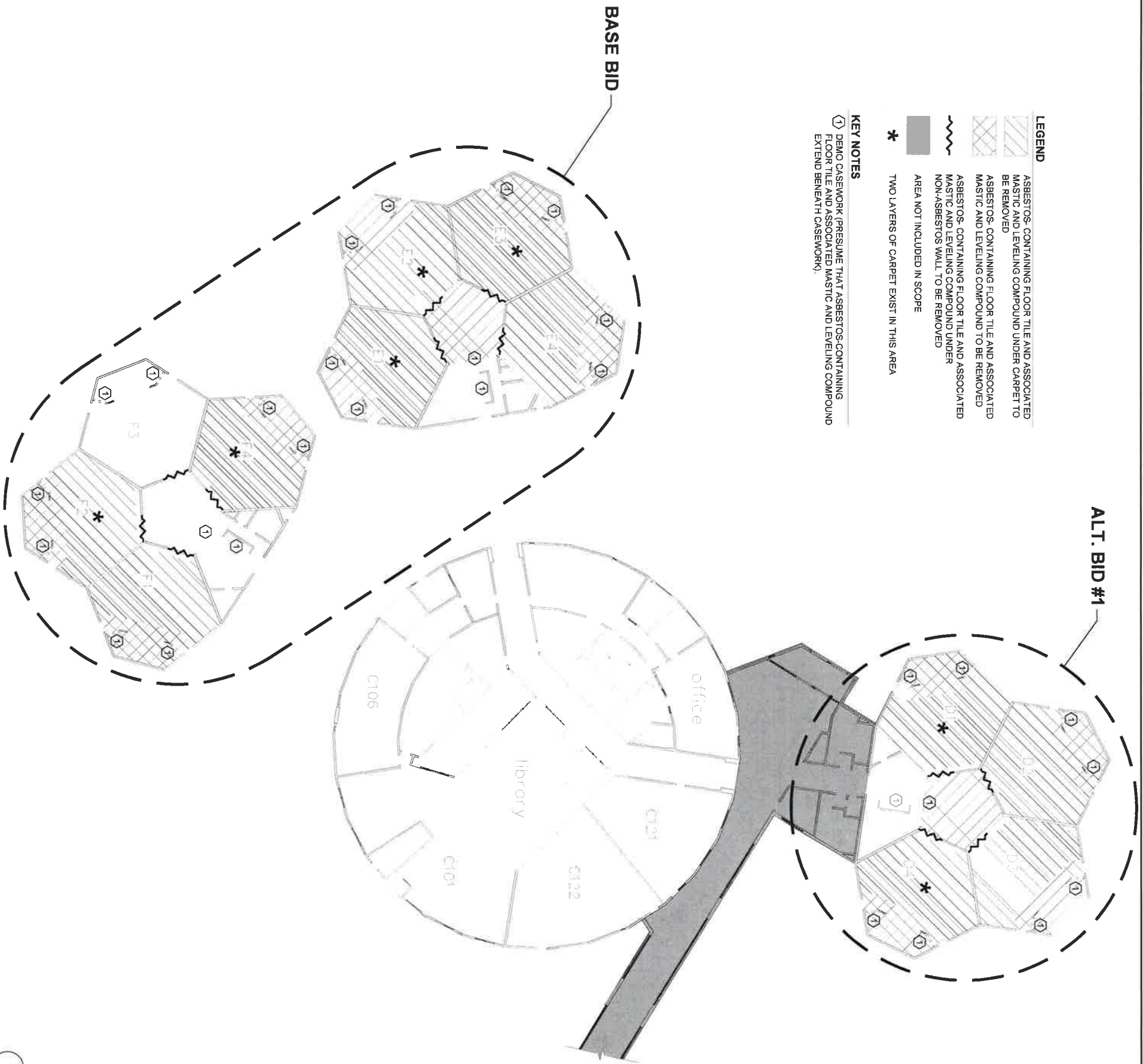
- ALT. BID #1 - ESTIMATED QUANTITIES OF HAZARDOUS MATERIALS TO BE REMOVED**
1. REMOVE APPROX. 1,675 SF OF ASBESTOS- CONTAINING FLOOR TILE AND ASSOCIATED MASTIC AND LEVELING COMPOUND (ON CONCRETE). SEE LEGEND.
 2. REMOVE APPROX. 3,150 SF OF ASBESTOS- CONTAINING FLOOR TILE AND ASSOCIATED MASTIC AND LEVELING COMPOUND UNDER CARPET (ON CONCRETE). SEE LEGEND.
 3. REMOVE APPROX. 24 LF OF ASBESTOS- CONTAINING FLOOR TILE AND ASSOCIATED MASTIC AND LEVELING COMPOUND UNDER NON-ACM WALL. SEE LEGEND.

HAZARDOUS FLOORING MATERIAL ABATEMENT
SCALE: 3/4" = 1'-0"

**EUGENE SCHOOL DISTRICT 4J
GILHAM ELEMENTARY SCHOOL - PHASE 1 RENOVATIONS
3307 HONEYWOOD STREET
EUGENE, OREGON**



PBS
Engineering +
Environmental
2645 Wilamette Street
Suite A
Eugene, OR 97405
541.686.8684
www.pbsenv.com

HAZARDOUS FLOORING MATERIAL ABATEMENT PLAN	PROJECT: 52212.000
	DRAWN: JHD
	CHECKED: JB
	DATE: FEBRUARY 2016
DRAWING: HM1	SHEET: 1 OF 2

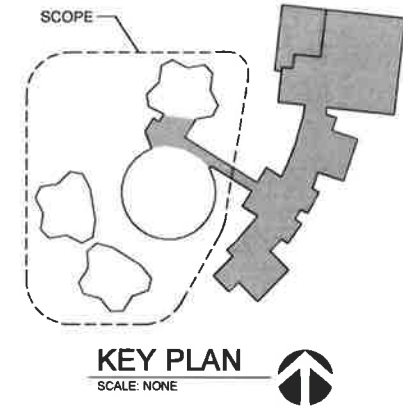

LEGEND

- ++++ ASBESTOS-CONTAINING CEMENT BOARD AND ASSOCIATED MASTIC TO BE REMOVED
- - - - ASBESTOS-CONTAINING JOINT COMPOUND AND MASTIC ABOVE CEILING TILE (BOTH SIDES OF WALL)
- NON- ASBESTOS-CONTAINING LAY-IN CEILING TILE AND SUSPENDED GRID TO BE REMOVED
- AREA NOT INCLUDED IN SCOPE

KEY NOTES

- ② REMOVE ASBESTOS-CONTAINING PERIMETER CAULK / SEALANT AT GRID AND LOOSE ASBESTOS-CONTAINING JOINT COMPOUND AND MASTIC ABOVE CEILING

BASE BID

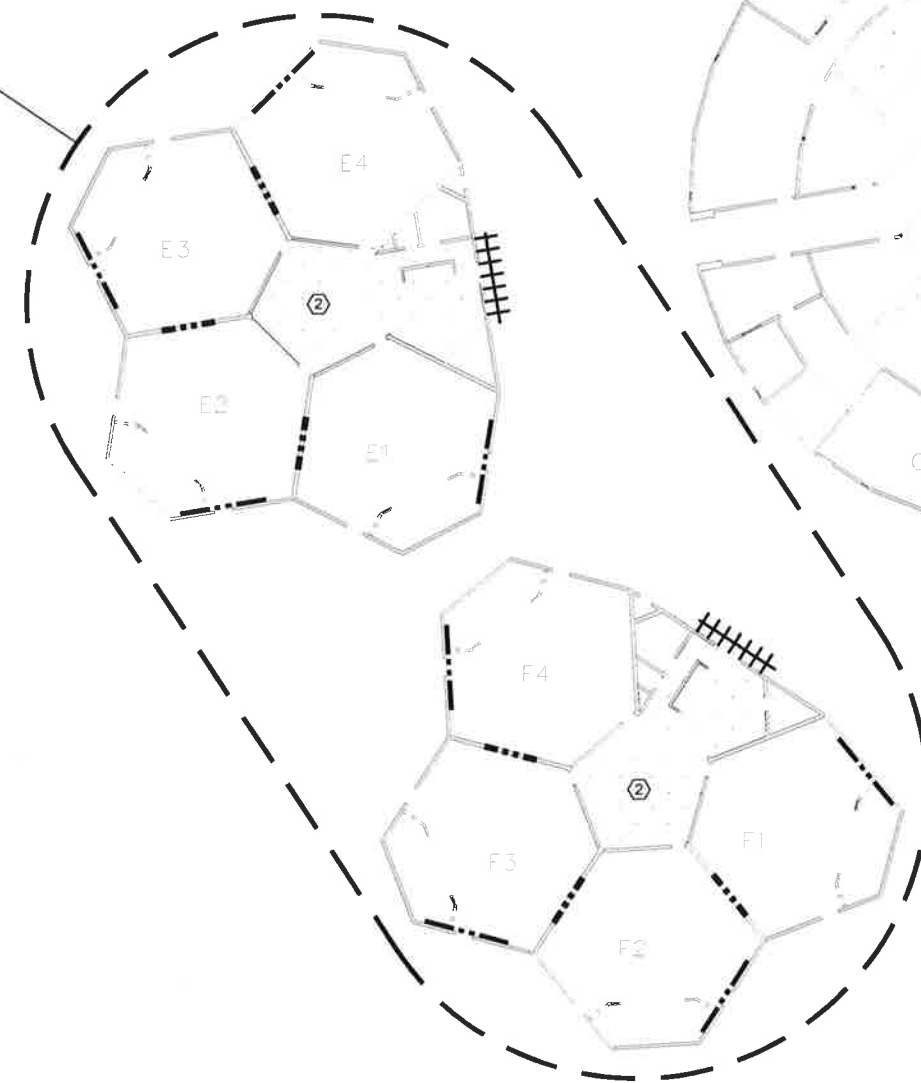

ALT. BID #1

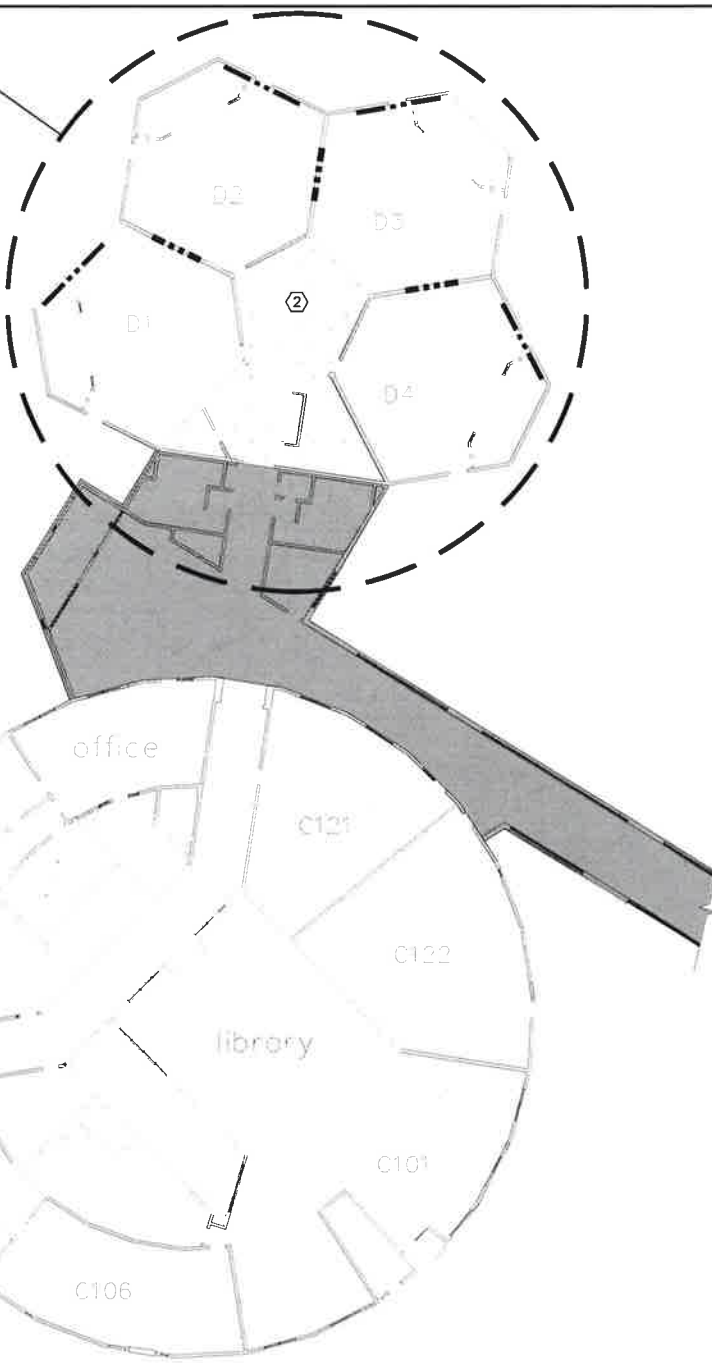

GENERAL NOTES

1. THIS DRAWING IS DIAGRAMMATIC. IT IS FOR GENERAL INFORMATION.
2. BUILDING DRAWING FOOTPRINT MAYBE INACCURATE OR NOT TO SCALE. CONTRACTOR IS TO FIELD VERIFY ALL MATERIAL LOCATIONS AND QUANTITIES.
3. ABATEMENT CONTRACTOR IS TO COORDINATE HIS WORK WITH THE OWNER AND GENERAL CONTRACTOR INCLUDING BUT NOT LIMITED TO: SCHEDULING, PHASING, ACCESS, SECURITY, STAGING, PROTECT AND SAVE ITEMS, SALVAGE, ISOLATION OR LOCKOUT/TAGOUT OF UTILITIES AND DEMOLITION.
4. IF SUSPECT MATERIALS ARE UNCOVERED DURING ABATEMENT, DEMOLITION OR RENOVATION THAT ARE NOT IDENTIFIED OR SAMPLED IN THE HAZARDOUS MATERIALS SURVEY REPORT OR SHOWN ON THIS DRAWING, STOP WORK AND CONTACT THE HAZARDOUS MATERIALS CONSULTANT AND THE JOB SUPERINTENDENT FOR ADDITIONAL TESTING.
5. ABATEMENT CONTRACTOR SHALL PERFORM ALL SELECTIVE DEMOLITION AS NEEDED TO ACCESS AND ABATE ASBESTOS-CONTAINING MATERIALS.
6. ALL CONTRACTORS AND SUB-CONTRACTOR PERFORMING DEMOLITION OR RENOVATION ACTIVITIES ON PAINTED SURFACES ARE TO COMPLY WITH ALL APPLICABLE LEAD PAINT REGULATIONS IN OAR 437-DIVISION 3, 1926.62 LEAD IN CONSTRUCTION INDUSTRY STANDARDS.
7. ABATEMENT CONTRACTOR SHALL REMOVE AND PROPERLY RECYCLE ALL MERCURY VAPOR LIGHT TUBES FROM FLUORESCENT LIGHTING FIXTURES. CONTRACTOR SHALL FIELD VERIFY THAT FLUORESCENT LIGHTING FIXTURE BALLASTS ARE NON-PCB CONTAINING. ANY BALLASTS NOT SPECIFICALLY LABELED AS "NON-PCB" SHALL BE REMOVED AND PROPERLY DISPOSED OF BY THE ABATEMENT CONTRACTOR.
8. REFERENCE HAZARDOUS MATERIALS SURVEY REPORT AND PROJECT ABATEMENT SPECIFICATIONS FOR ADDITIONAL INFORMATION.

BASE BID - ESTIMATED QUANTITIES OF HAZARDOUS MATERIALS TO BE REMOVED

1. REMOVE APPROX. 188 SF OF ASBESTOS-CONTAINING JOINT COMPOUND AND MASTIC ABOVE CEILING TILE. SEE LEGEND.
2. REMOVE APPROX. 180 SF OF ASBESTOS-CONTAINING CEMENT BOARD AND ASSOCIATED MASTIC. SEE LEGEND.
3. REMOVE APPROX. 160 LF OF ASBESTOS-CONTAINING PERIMETER CAULK / SEALANT AT GRID AND LOOSE ASBESTOS-CONTAINING JOINT COMPOUND AND MASTIC ABOVE CEILING. SEE KEY NOTES.

ALT. BID #1 - ESTIMATED QUANTITIES OF HAZARDOUS MATERIALS TO BE REMOVED

1. REMOVE APPROX. 94 SF OF ASBESTOS-CONTAINING JOINT COMPOUND AND MASTIC ABOVE CEILING TILE. SEE LEGEND.
2. REMOVE APPROX. 90 SF OF ASBESTOS-CONTAINING CEMENT BOARD AND ASSOCIATED MASTIC. SEE LEGEND.
3. REMOVE APPROX. 80 LF OF PERIMETER CAULK / SEALANT AT GRID AND LOOSE ASBESTOS-CONTAINING JOINT COMPOUND AND MASTIC ABOVE CEILING. SEE KEY NOTES.

1 HAZARDOUS TSI AND MISC. MATERIAL ABATEMENT
SCALE: 3/4" = 1'-0"