

THE DOCUMENT AND THE IDEAS AND DESIGNS INCORPORATED HEREIN ARE THE PROPERTY OF RODD HANSEN ARCHITECT, LLC, AND IS NOT TO BE USED, IN WHOLE OR PART, FOR ANY OTHER PROJECT WITHOUT THE WRITTEN AUTHORIZATION OF RODD HANSEN ARCHITECT, LLC

RODD HANSEN ARCHITECT, LLC
 1551 Oak Street, Suite A
 Eugene, Oregon 97401
 Phone: (541) 261-1800
 Fax: (541) 687-1200
 E-Mail: rodd@rhaarchitectural.com

EUGENE SCHOOL DISTRICT 4J
 ADAMS ELEMENTARY SCHOOL
 RESTROOM ADDITION
 950 W. 22nd
 EUGENE, OR 97405

ARCHITECTURAL
 TITLE: SITE PLAN
 JOB#: 1148.071212014
 DRAWN BY: JSR
 ISSUE DATE: 10-22-2014
 SCALE: 0/0"=0'-0"

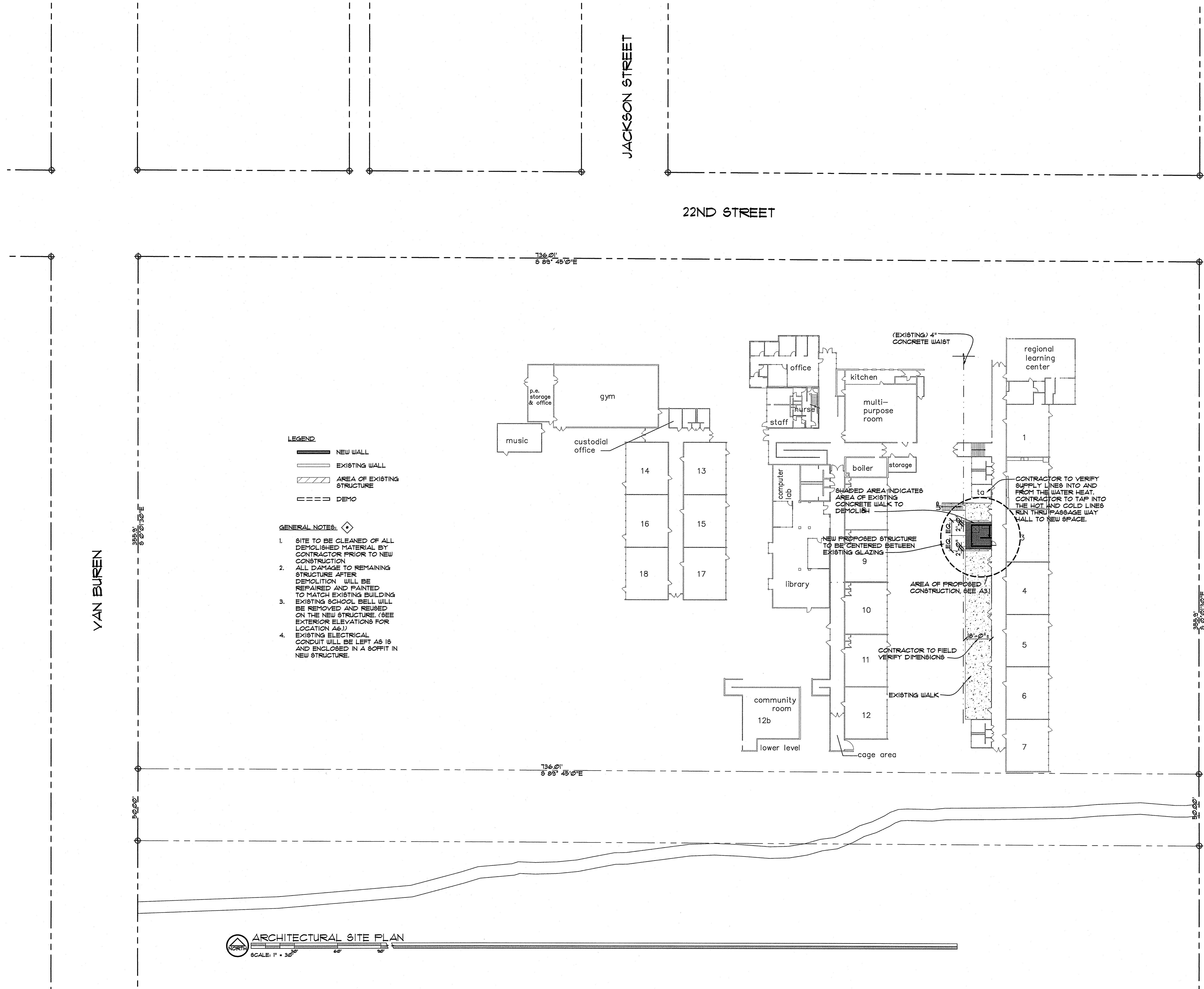
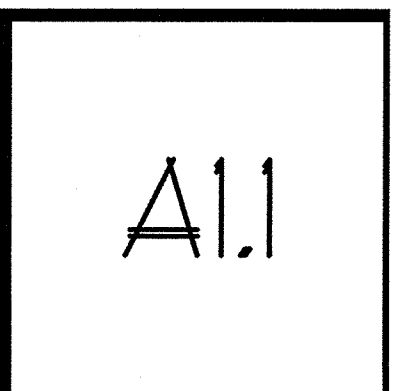

23RD ST