

mahlum

Bainbridge Island School District  
21<sup>st</sup> Century Learning Environments  
Master Plan Update 28 January 2015

# Elements of the 21<sup>st</sup> Century School



# Bainbridge Island School District

Our **mission** as a learning organization is to ensure that every student is future ready:

- :: **Prepared for the global workplace**
- :: **Prepared for college**
- :: **Prepared for personal success**



# Bainbridge Island School District

Our **vision** is committed to providing each student with an excellent academic program in an engaging and supportive environment that:

- :: **Fosters a passion for learning**
- :: **Instills a sense of civic and social responsibility, and**
- :: **Develops the intellectual, physical, and social skills necessary for success in career, college, and life in the 21<sup>st</sup> century**



# US Department of Education Guidelines

**Enhance teaching and learning and accommodate the needs of all learners**

**Allow them to serve as centers of the community**

**Result from a planning | design process involving all stakeholders**

**Provide for health, safety, and security**

**Make effective use of all adaptable resources**

**Allow for flexibility and adaptability to changing needs**

# Elements of the 21<sup>st</sup> Century School

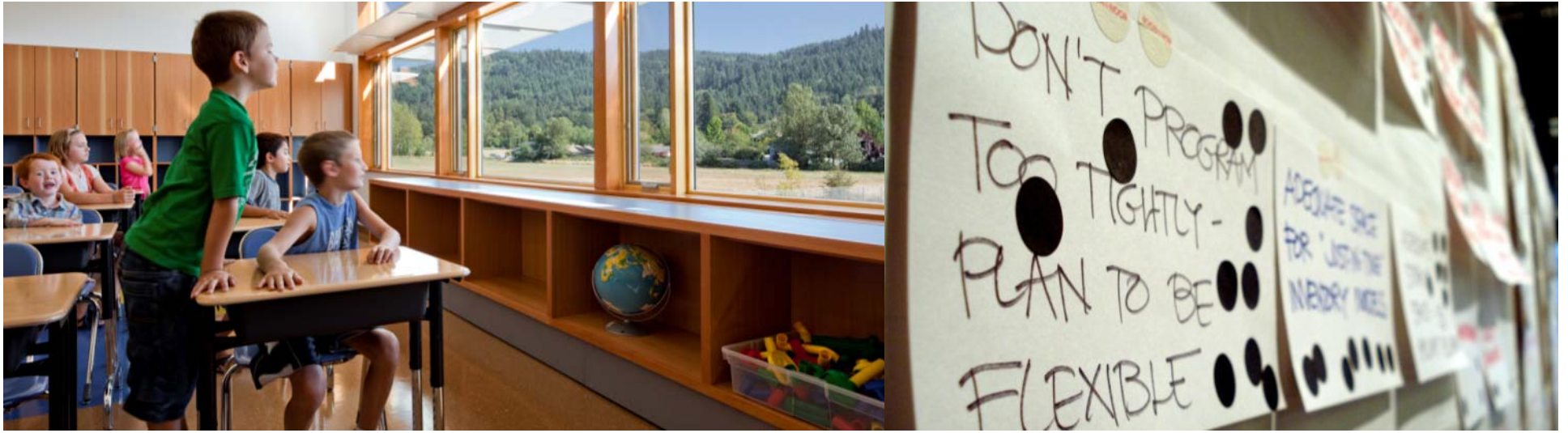

# Elements of the 21<sup>st</sup> Century School

- :: Multiple Use Spaces
- :: Learning Everywhere
- :: Design Patterns
- :: Partnerships  
*Aligning services & programs*  
*Creating new learning opportunities*
- :: Sharing Facilities and Leveraging Resources
- :: Adapt and Re-use Existing Facilities
- :: Expanding the Boundaries
- :: Design Trends

# Multiple Use Spaces



# long-term adaptability



# long-term adaptability



# long-term adaptability

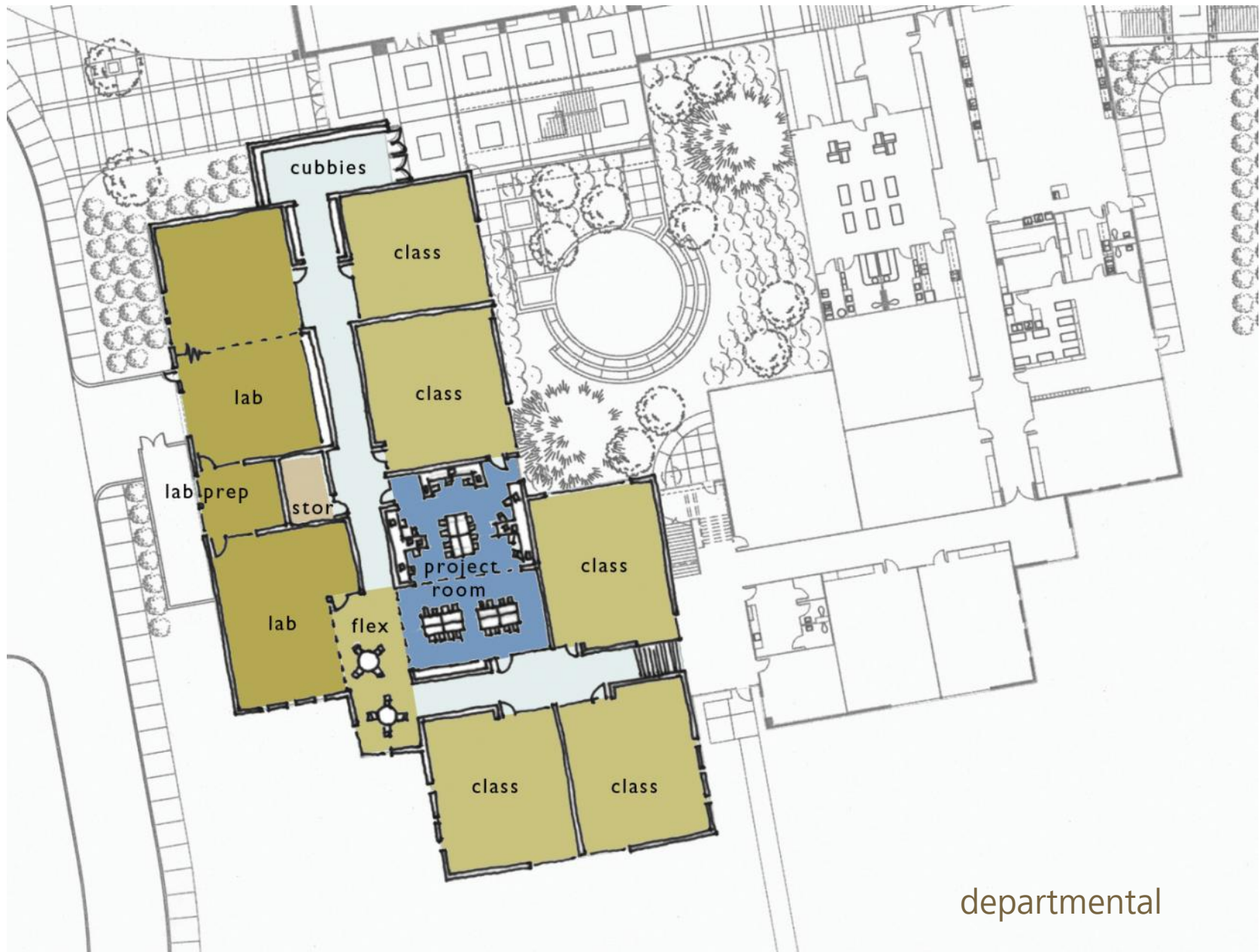

departmental

# long-term adaptability

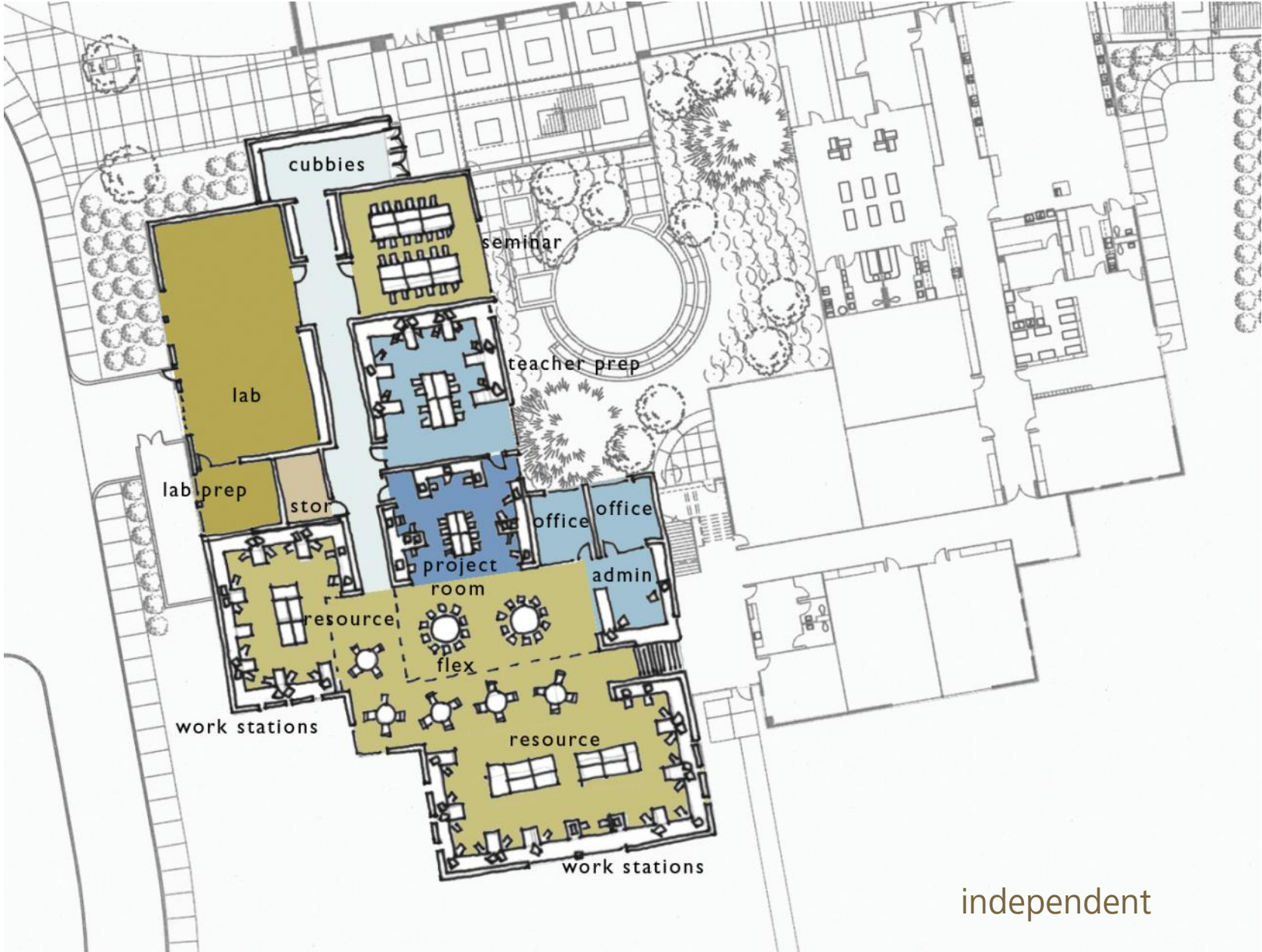

# long-term adaptability

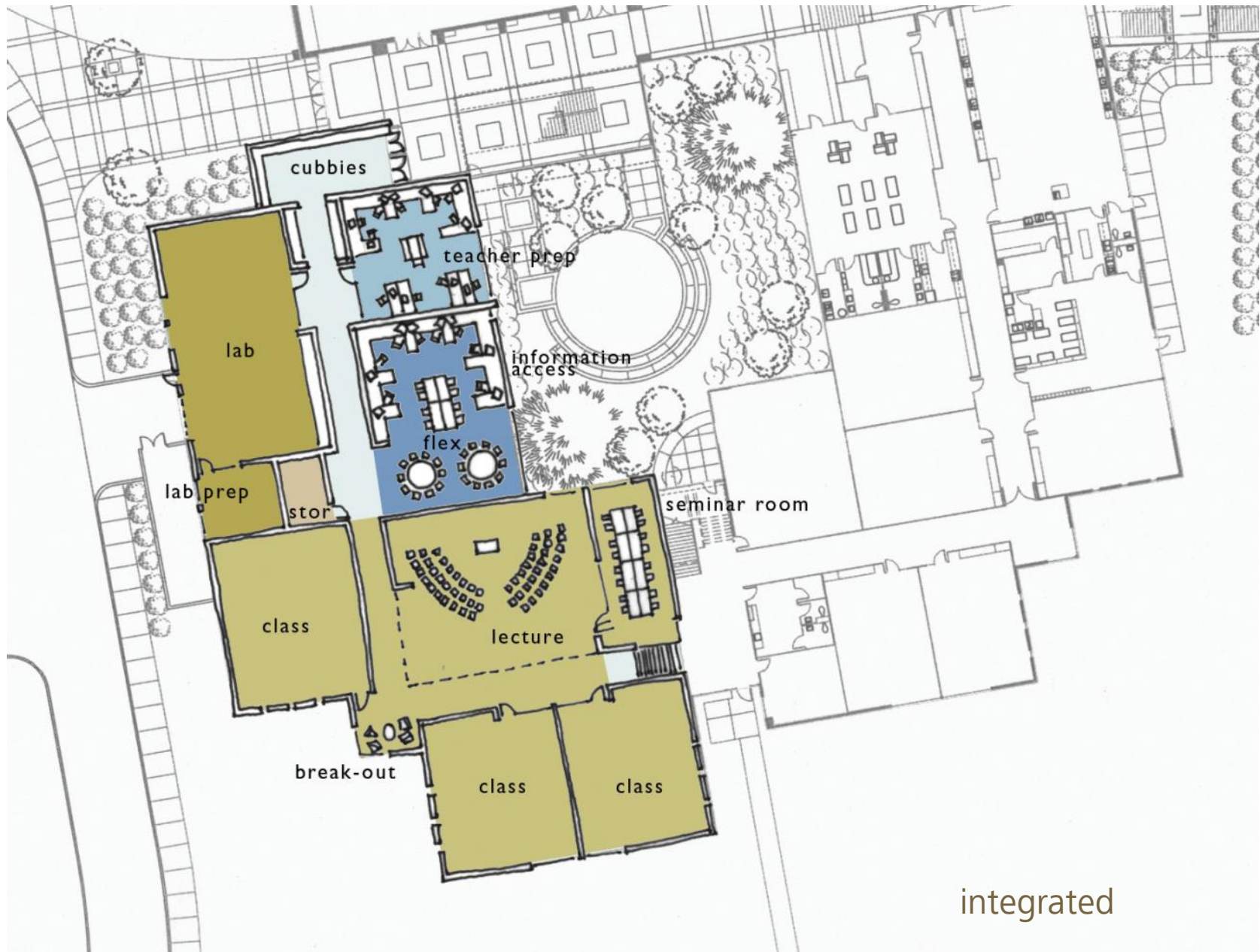

# long-term adaptability

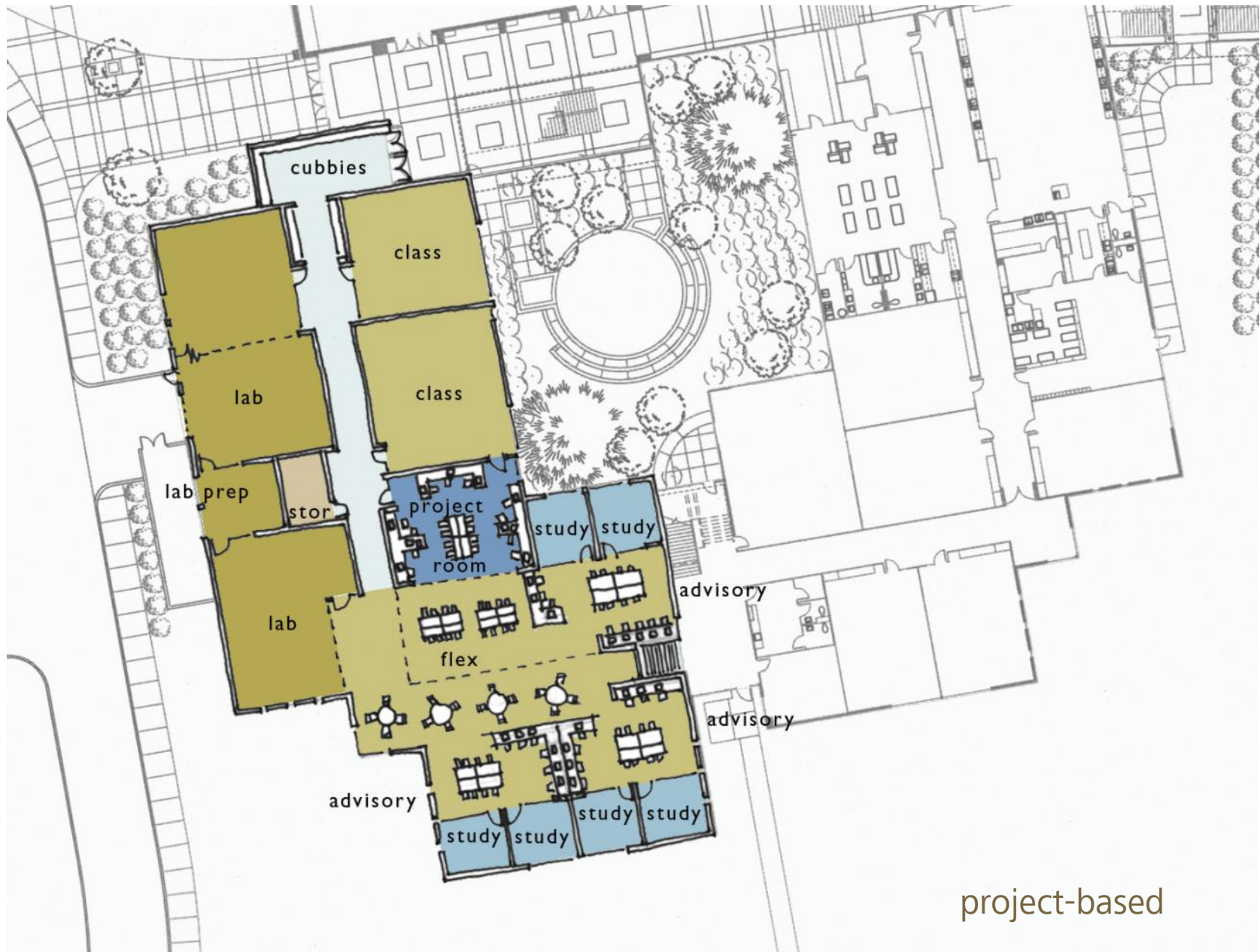

project-based

# long-term adaptability

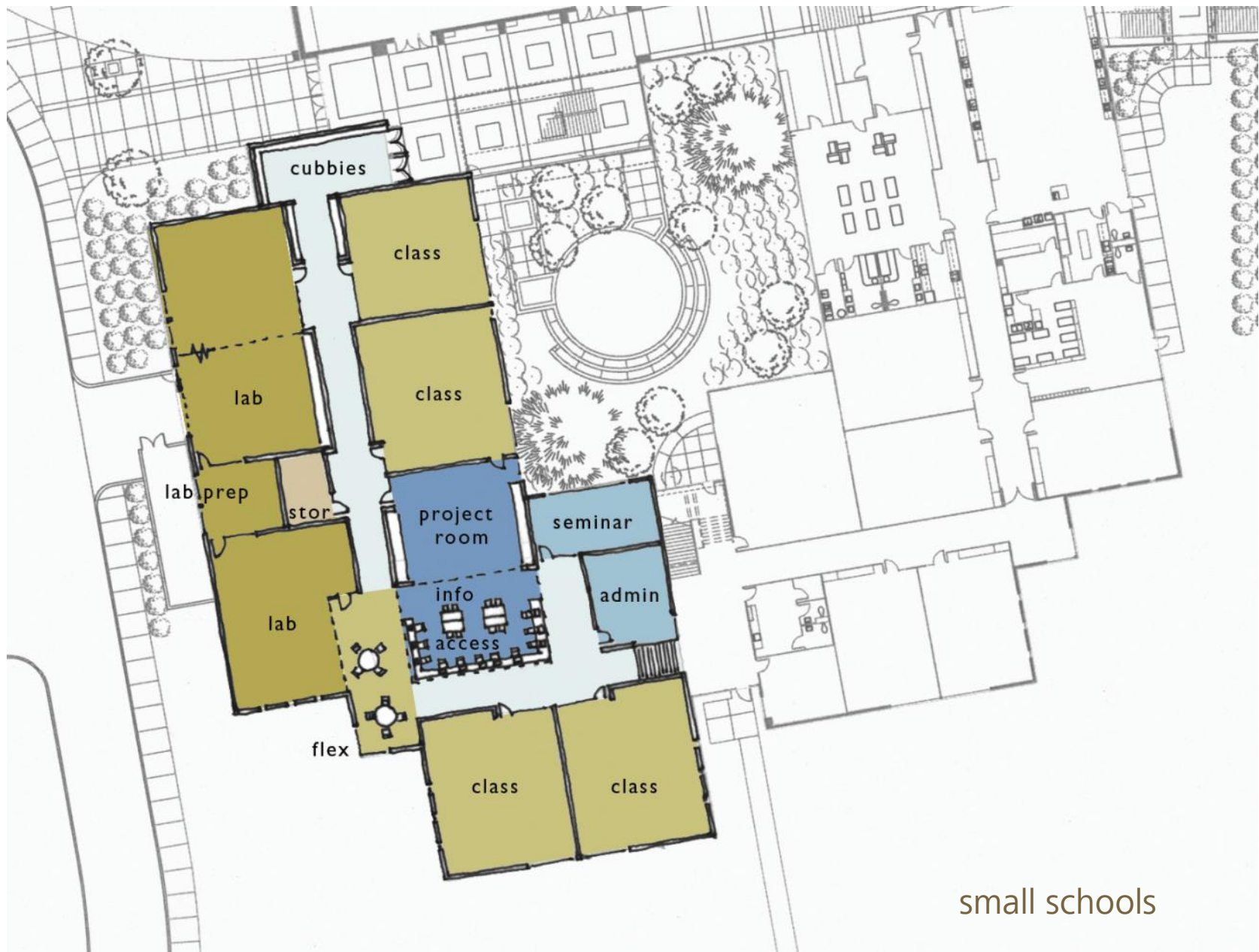

small schools

Learning Everywhere





# Facilitate Learning Everywhere

**Corridors**

**Outdoor Spaces**

**Breakout Spaces**

**Presentations Spaces –  
Large & Small**

**Collaboration Spaces**

**Connected**

**Transparent**

**Scaled**



# Facilitate Learning Everywhere

**Engaging**

**Safe**

**Healthy**

**Challenging**

**Supportive**

**Flexible | Adaptable | Convertible**

**Durable | Enduring**

**Celebrates Culture**

**Inspirational**

**Courageous**









# Design Patterns



# Learning Modalities – 21<sup>st</sup> Century School

- :: Independent study
- :: Peer tutoring
- :: Team collaborative work
- :: One-on-one with teacher
- :: Lecture format
- :: Project-based learning
- :: Technology-based learning
- :: Distance learning
- :: Research via Internet
- :: Student presentations
- :: Performance & music-based
- :: Seminar style instruction
- :: Community service learning
- :: Naturalist learning
- :: Social | emotional learning
- :: Art-based learning
- :: Storytelling (floor seating)
- :: Learning by building



Partnerships



# Seek Education Partnerships & Joint Use

**Augment School Programs**

**Provide Educational Opportunity  
Before and After School**

**Potential Funding Source**

**Shared Sites  
(Parks and Recreation & others)**

# Aligning Services & Programs

Rosa Parks School, Portland, OR

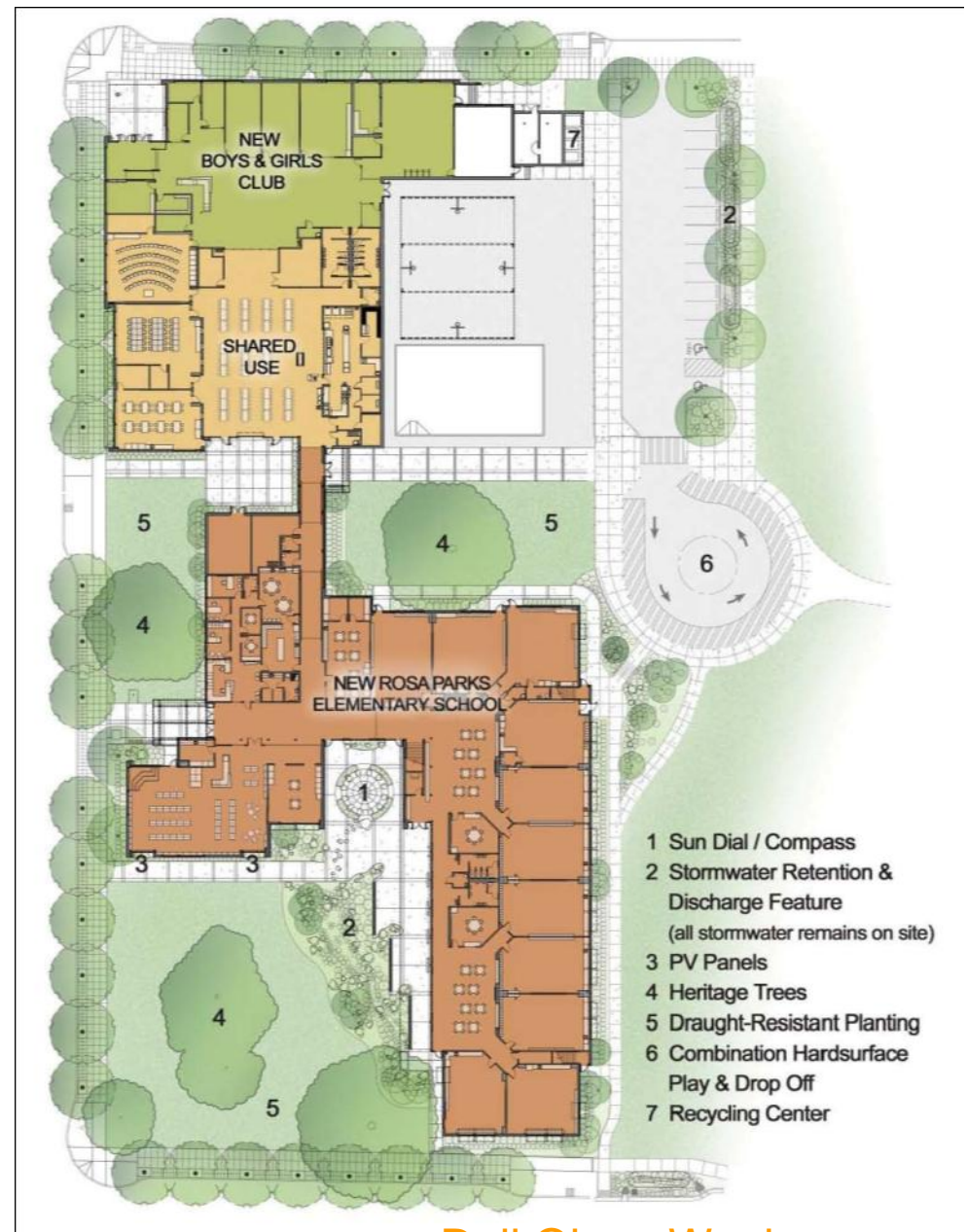

Dull Olson Weekes

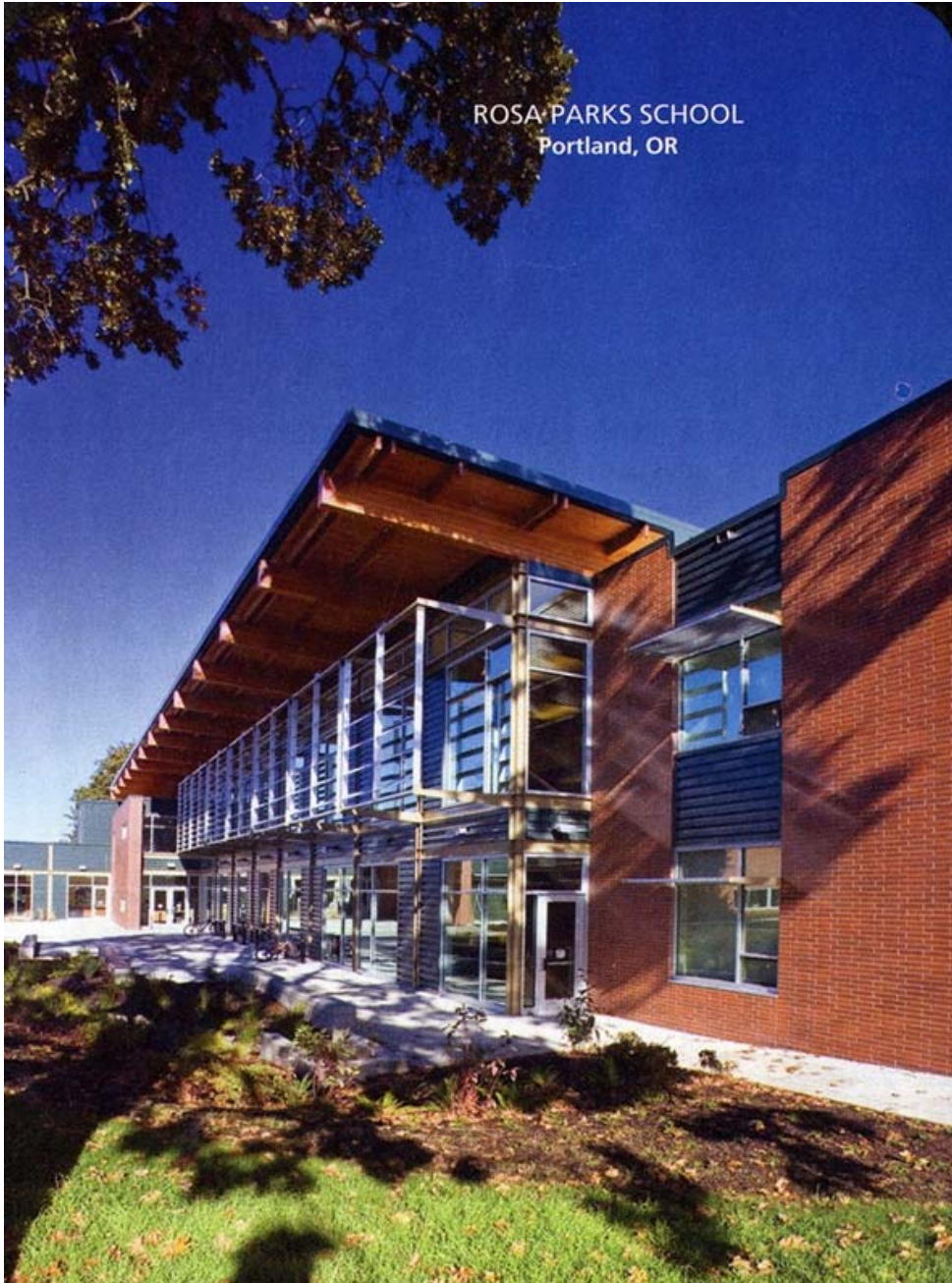

Rosa Parks School, Portland, OR



Dull Olson Weekes



## Sharing Facilities and Leveraging Resources



Truman Learning Center, Federal Way, WA

Mahlum



Truman Learning Center, Federal Way, WA

Mahlum



Truman Learning Center, Federal Way, WA

Mahlum



Truman Learning Center, Federal Way, WA

Mahlum





Truman Learning Center, Federal Way, WA



Mahlum

Adapt and Re-use Existing Facilities



# Adapt and Re-use Existing Buildings

**Additions and Renovations  
to Existing Buildings**

**Keeps School Facilities in  
Established Neighborhoods**

**Adaptive Reuse of Other  
Building Types into Schools:  
Warehouses, Office buildings, Retail**

Expanding the Boundaries

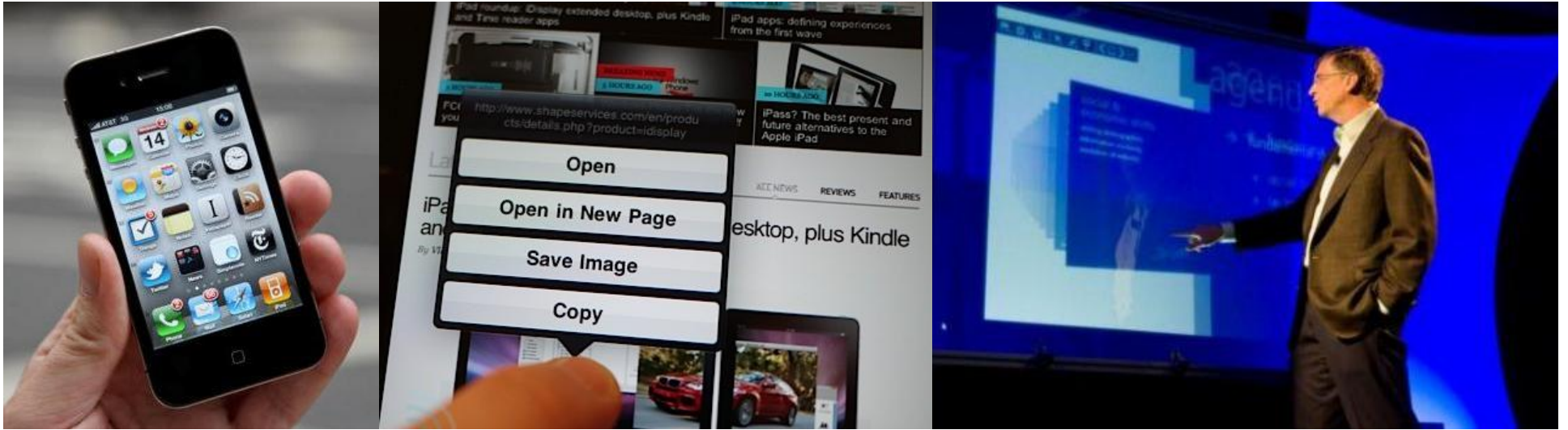

# Integrate Technology Throughout

**Not Only about  
Computer Literacy**

**Collaboration**

**Visual Literacy**

**Storytelling**

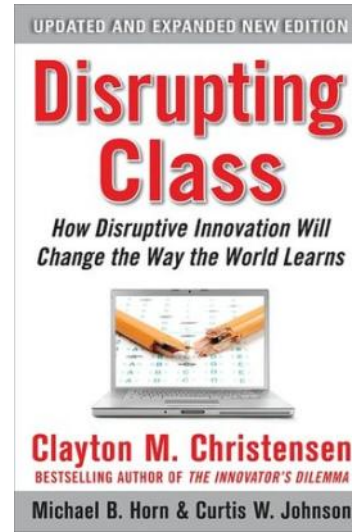
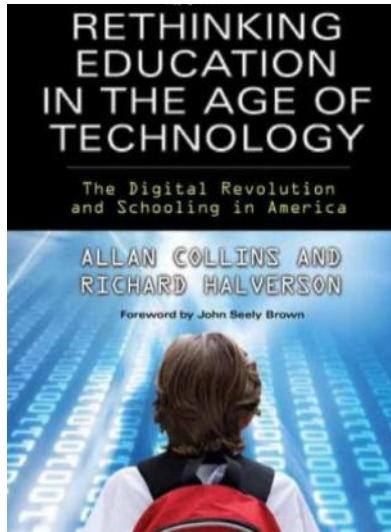

# Integrate Technology Throughout

## **Rethinking Education in the Age of Technology**

Allan Collins and  
Richard Halverson

## **Disrupting Class, How Disruptive Innovation Will Change the Way the World Learns**

Clayton M. Christensen  
with Michael B. Horn  
and Curtis W. Johnson



# Utilize Neighborhood & World as Campus

**Utilize Skype and Other Technology to Foster Connections Locally & Internationally**

**Expand Learning by Creating Social, Collaborative and Meaningful Connections that are Relevant and Empowering**

**Utilize Neighborhood Venues for Drama | Music Presentations**



# Maximize Site Connection to Community

**Reduces the Need for Large Site**

**Utilize Parks & Recreation  
Centers and Sites, Potentially  
Freeing Up School District Land  
for More Outdoor Learning  
Opportunities**





The School Without Walls, Washington, DC

# Environmental Responsibility



# Embrace Sustainable Design

**Teachers and Students  
Perform Best when Building  
Performs Well:  
Comfortable Environment  
Free of Irritants | Toxins  
Minimize Energy & Resource Use**

**Create Building as a Teacher of  
Environmental Stewardship & a  
Laboratory for Learning About  
Natural Processes**

**Increase User Performance**



# Sustainable School Opportunities

**Envision a sustainable school**

**Establish sustainability goals**

**Identify opportunities and strategies**

**Identify educational opportunities**



## Environmental Impact of Buildings

**65.2% of total  
U.S. electricity consumption**

**36% of total  
U.S. primary energy use**

**30% of total  
U.S. greenhouse  
gas emissions**

**136 million tons  
of construction and demolition  
waste in the U.S.  
(approx. 2.8 lbs/person/day)**

**12% of potable water  
in the U.S.**

**40% (3 billion tons annually)  
of raw materials use globally**



# Benefits of High Performance Design

## **Environmental benefits**

Reduce the impacts of natural resource consumption

## **Economic benefits**

Reduce operating costs

## **Health and safety benefits**

Enhance occupant comfort and health

## **Educational benefits**

Improve quality of educational experience



# Benefits of High Performance Design

## **Increase student performance**

### **NCEF**

[www.edfacilities.org](http://www.edfacilities.org)

### **Daylighting**

Heschong Mahone study  
Quality of daylight /  
improvement in learning

## **Indoor air quality**

Healthier, more comfortable  
environments/reduced  
absenteeism

### **Acoustics**

Good acoustics/good academic  
performance

mahlum

Bainbridge Island School District  
21<sup>st</sup> Century Learning Environments  
Master Plan Update 28 January 2015